

Force 1000 daN

Piston Rod Sealed gas springs

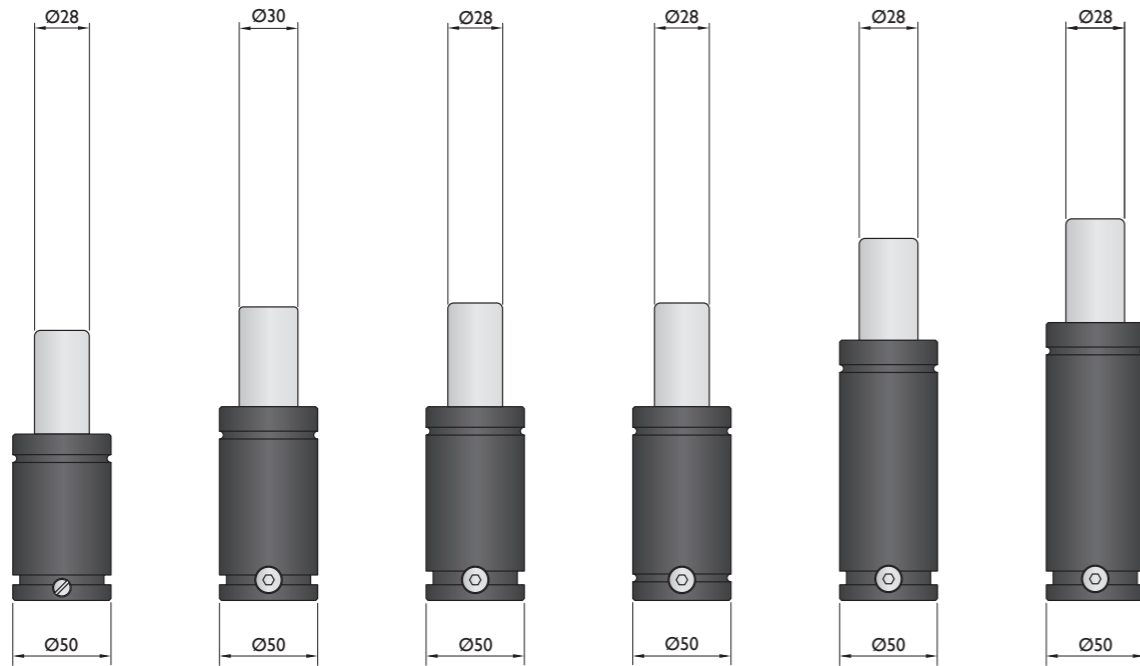
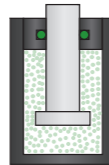

Model	KP-1000	K-1000	NR-1000	NT-1000	M-1000	HD-1000
Initial F (daN)	920	990	920	920	920	920
L max (mm)	2xStroke+38	2xStroke+50	2xStroke+52	2xStroke+52	2xStroke+85	2xStroke+95
Stroke (mm)	13-125	12-125	13-125	13-125	25-160	25-300

* other strokes under request

Standards

PED	PED	PED	PED	PED	PED
97/23/EC	97/23/EC	97/23/EC	97/23/EC	97/23/EC	97/23/EC
ISO 11901	ISO 11901	ISO 11901	ISO 11901	ISO 11901	ISO 11901
VDI 3003	VDI 3003	VDI 3003	VDI 3003	VDI 3003	VDI 3003
CNOMO EM24.54.700	CNOMO EM24.54.700	CNOMO EM24.54.700	CNOMO EM24.54.700	CNOMO EM24.54.700	CNOMO EM24.54.700

Force 1000 daN

Bore Sealed gas springs

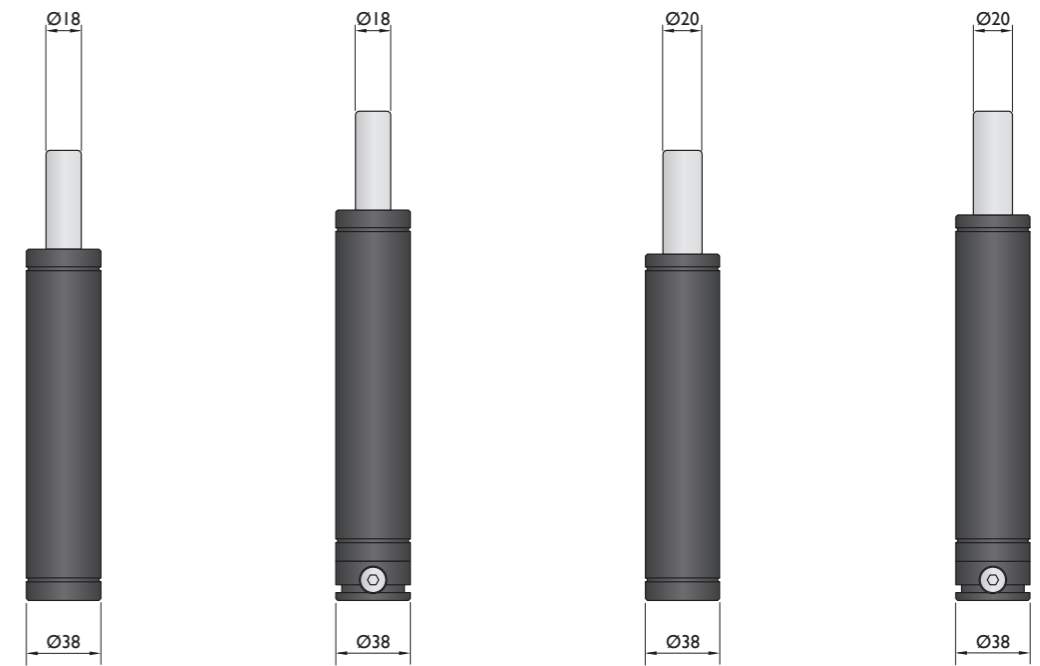

Model	T-1000	TC-1000	TS-1000	TSC-1000
Initial F (daN)	920	920	920	920
L max (mm)	61-230	81-250	61-230	81-250
Stroke (mm)	6-50	6-50	6-50	6-50

* other strokes under request

Standards

PED	PED	PED	PED
97/23/EC	97/23/EC	97/23/EC	97/23/EC
ISO 11901	ISO 11901	ISO 11901	ISO 11901
VDI 3003	VDI 3003	VDI 3003	VDI 3003
CNOMO EM24.54.700	CNOMO EM24.54.700	CNOMO EM24.54.700	CNOMO EM24.54.700

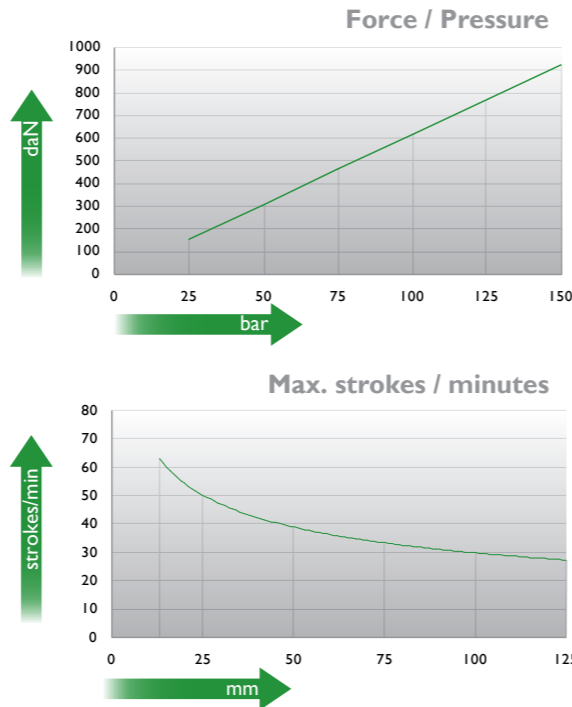
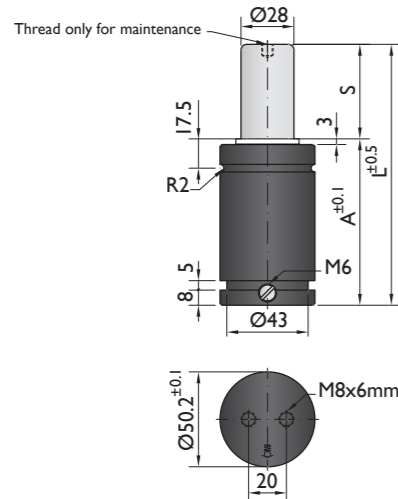

Ordering example: 4 x KP-1000-125

Order No.	S ⁽¹⁾ mm	L mm	A mm	F ₀ ⁽²⁾ daN	F daN	(3)	kg
KP-1000-13	13	64	51	920	1400	No	0.57
KP-1000-16	16	70	54		1400	No	0.59
KP-1000-19	19	76	57		1400	No	0.62
KP-1000-25	25	88	63		1400	No	0.67
KP-1000-32	32	102	70		1400	No	0.73
KP-1000-38	38	114	76		1400	No	0.78
KP-1000-50	50	138	88		1400	Yes	0.88
KP-1000-63	63	164	101		1400	Yes	0.99
KP-1000-75	75	188	113		1400	Yes	1.09
KP-1000-80	80	198	118		1400	Yes	1.13
KP-1000-100	100	238	138	1400	Yes	1.30	
KP-1000-125	125	288	163	1400	Yes	1.51	

(1) other strokes under request (2) alternative forces upon request (3) ESK available for other strokes



Pressure medium	N ₂	Working temperature	0-80°C	Min. security stroke	10%
Max. Charging pressure	150 bar	Temperature related force increase	+0.34%/°C	Repair Kit	KIT KP-1000
Min. Charging pressure	25 bar	Max. working speed	1.6 m/s	Linkable	M6

Mounting possibilities

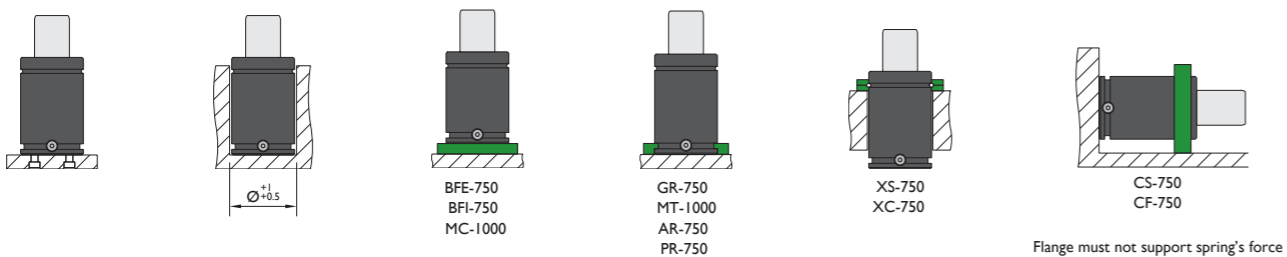

Flanges

BFE-750

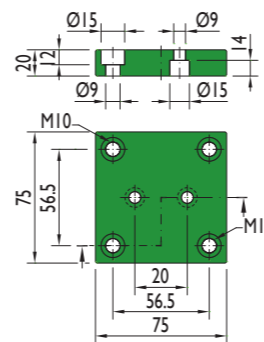

BFI-750

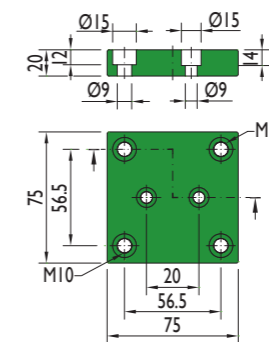

MC-1000

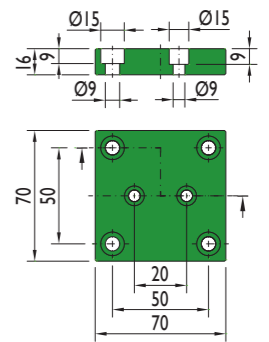

GR-750

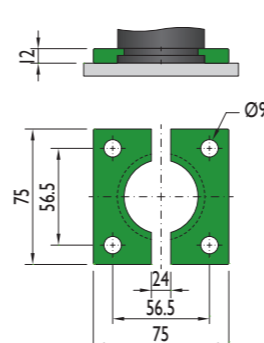

MT-1000

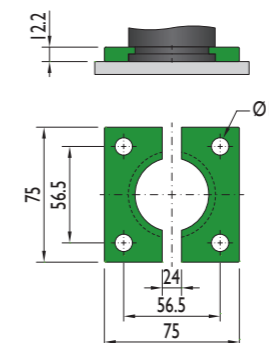

AR-750

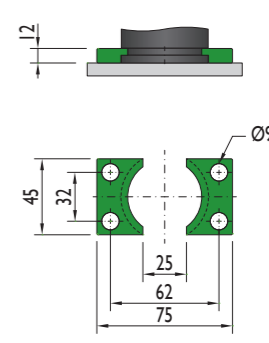

XS-750

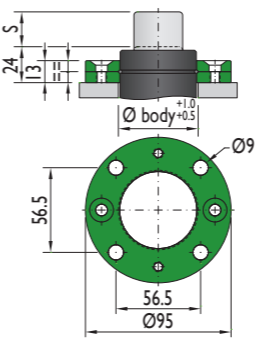

XC-750

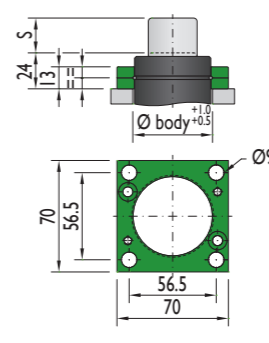

PR-750

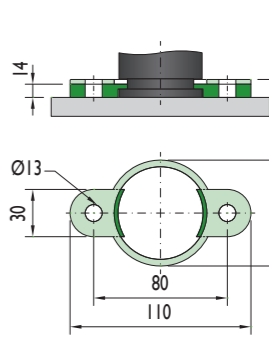

CS-750

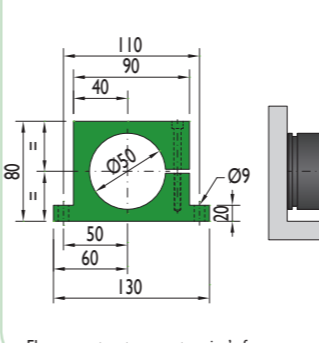

CF-750

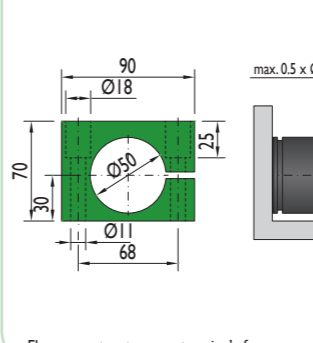

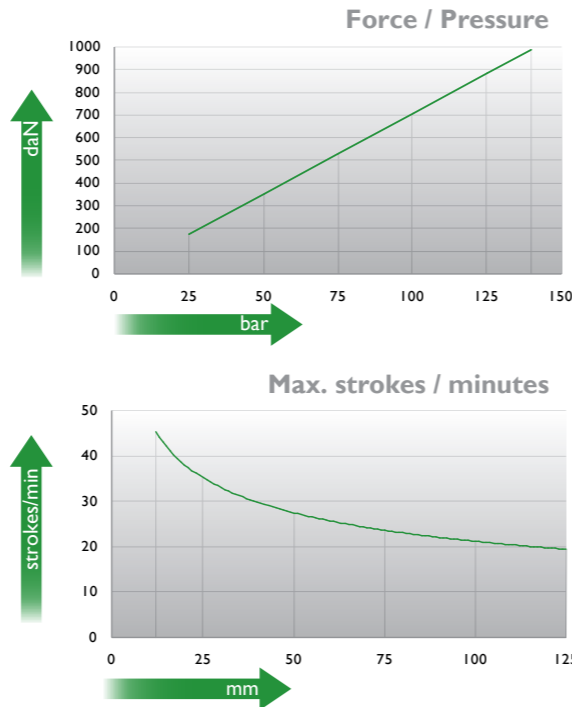
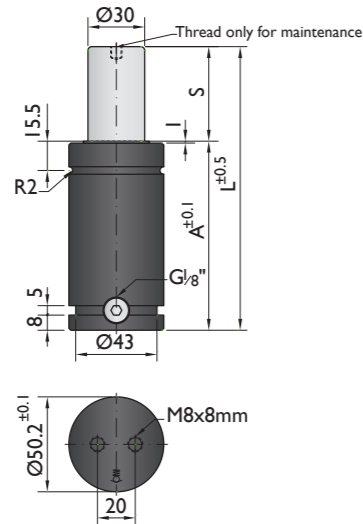

Ordering example: 4 x K-1000-125

Order No.	S ⁽¹⁾ mm	L mm	A mm	F ₀ ⁽²⁾ daN	F daN	(3)	kg
K-1000-12	12	74	62	990	1500	No	0.69
K-1000-19	19	88	69		1500	No	0.78
K-1000-25	25	100	75		1600	No	0.84
K-1000-38	38	126	88		1600	No	0.96
K-1000-50	50	150	100	1600	Yes	1.06	
K-1000-63	63	176	113	1700	Yes	1.18	
K-1000-80	80	210	130	1700	Yes	1.35	
K-1000-100	100	250	150	1700	Yes	1.40	
K-1000-125	125	300	175	1700	Yes	1.49	

(1) other strokes under request

(2) alternative forces upon request

(3) ESK available for other strokes



Pressure medium	N ₂	Working temperature	0-80°C	Min. security stroke	10%
Max. Charging pressure	140 bar	Temperature related force increase	+0.34%/°C	Repair Kit	KIT K-1000
Min. Charging pressure	25 bar	Max. working speed	1.6 m/s	Linkable	G1/8"

Mounting possibilities

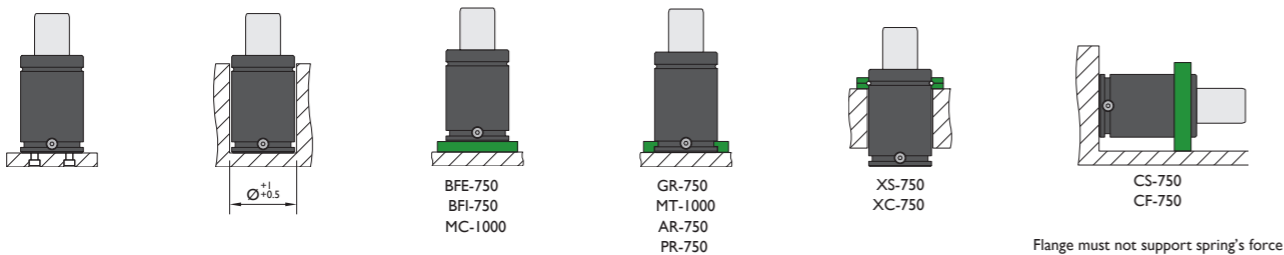

Flange must not support spring's force

Flanges

BFE-750

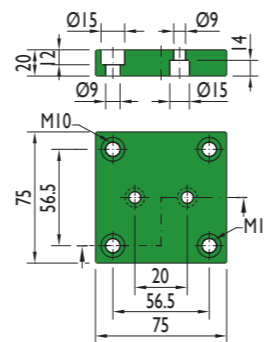

BFI-750

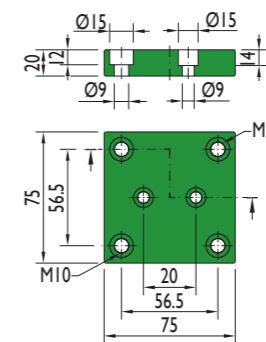

MC-1000

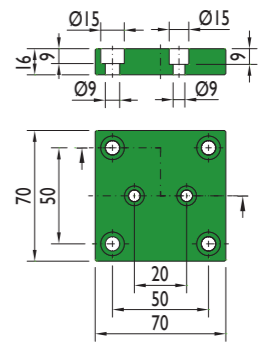

GR-750

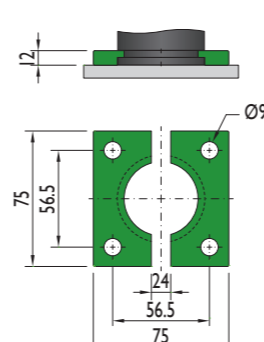

MT-1000

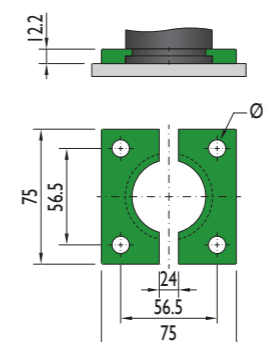

AR-750

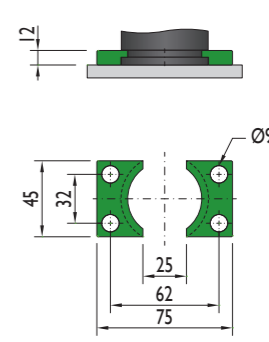

XS-750

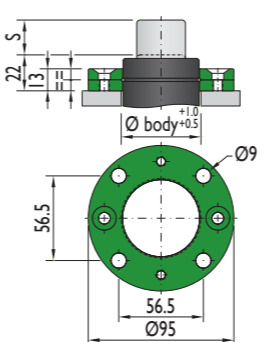

XC-750

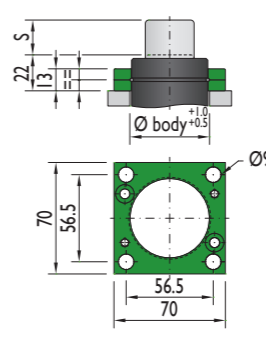

PR-750

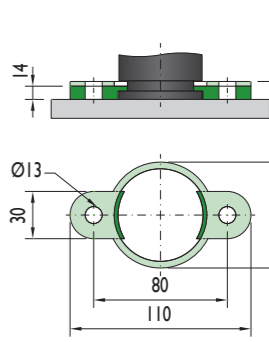

CS-750

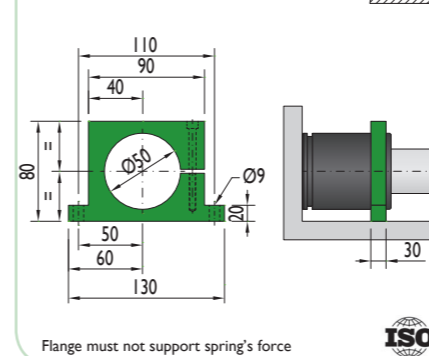

Flange must not support spring's force

CF-750

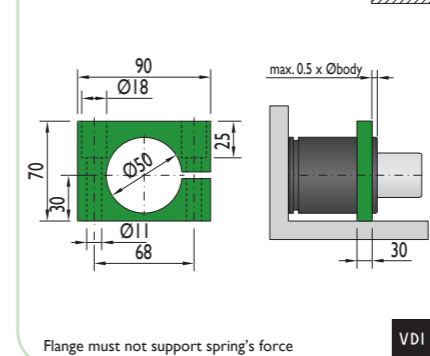

Flange must not support spring's force



*The new cylinder will be supplied when the stock runs out.

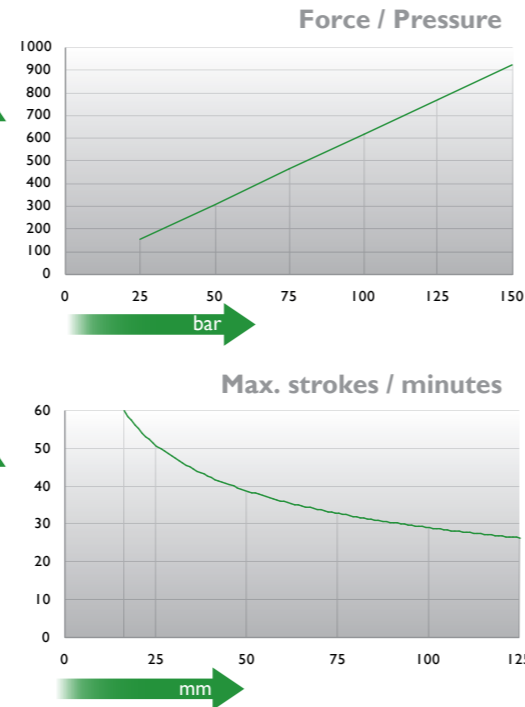
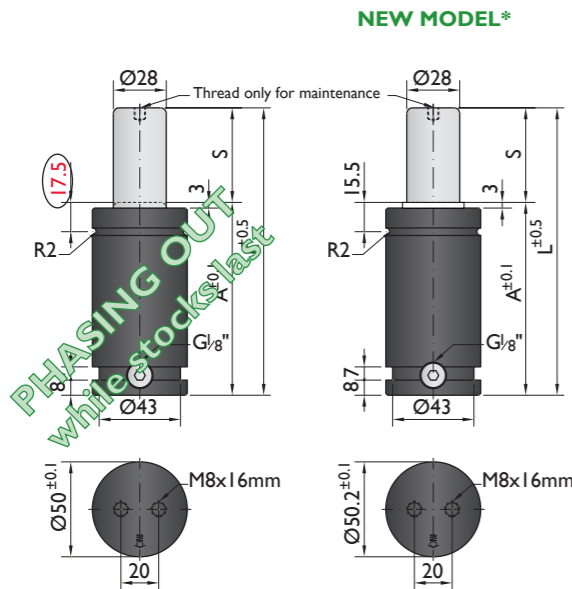

Ordering example: 4 x NR-1000-125

Order No.	S ⁽¹⁾ mm	L mm	A mm	F ₀ ⁽²⁾ daN (20°C, 150 bar)	F daN	(3)	kg
NR-1000-13	13	78	65	920	1300	No	0.70
NR-1000-16	16	84	68	920	1300	No	0.76
NR-1000-19	19	90	71	920	1300	No	0.80
NR-1000-25	25	102	77	920	1300	No	0.84
NR-1000-32	32	116	84	920	1300	No	0.90
NR-1000-38	38	128	90	920	1400	No	0.96
NR-1000-50	50	152	102	920	1400	Yes	1.06
NR-1000-63	63	178	115	920	1400	Yes	1.18
NR-1000-75	75	202	127	920	1400	Yes	1.28
NR-1000-80	80	212	132	920	1400	Yes	1.35
NR-1000-100	100	252	152	920	1400	Yes	1.40
NR-1000-125	125	302	177	920	1400	Yes	1.49

(1) other strokes under request (2) alternative forces upon request (3) ESK available for other strokes

	Pressure medium	N ₂	Working temperature	0-80°C	Min. security stroke	10%
	Max. Charging pressure	150 bar	Temperature related force increase	+0.34%/°C	Repair Kit	KIT NR-1000
	Min. Charging pressure	25 bar	Max. working speed	1.6 m/s	Linkable	G1/8"

Mounting possibilities

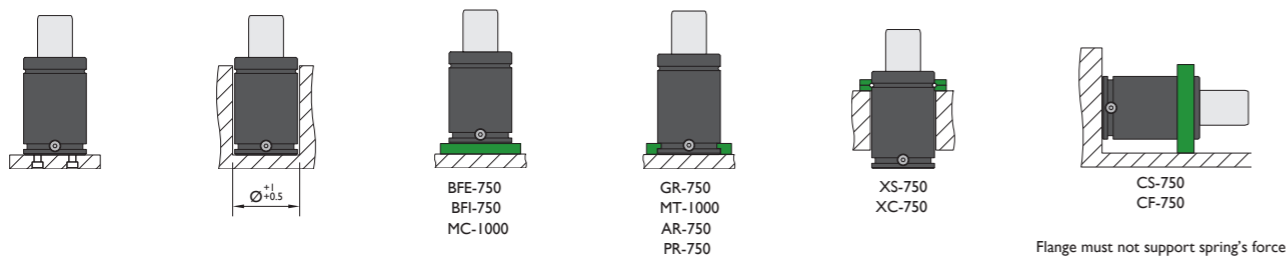

Flanges

BFE-750

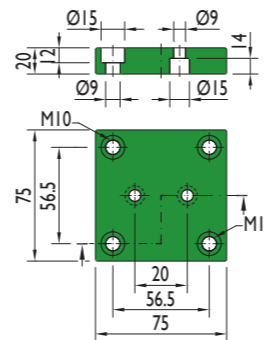

BFI-750

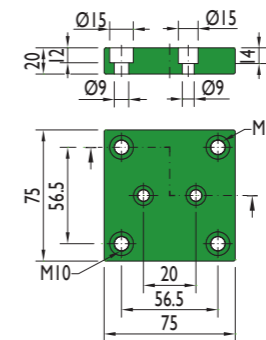

MC-1000

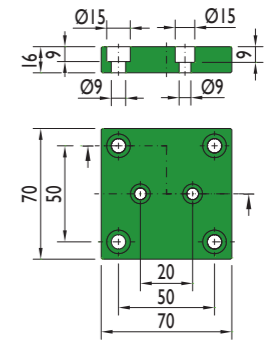

GR-750

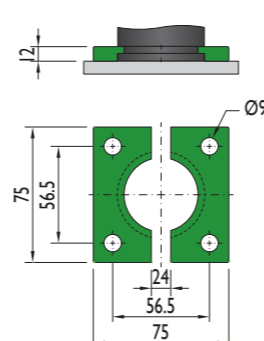

MT-1000

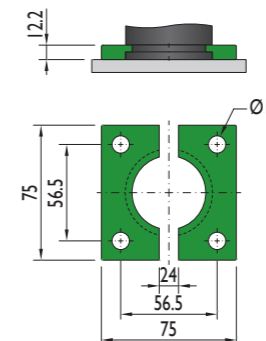

AR-750

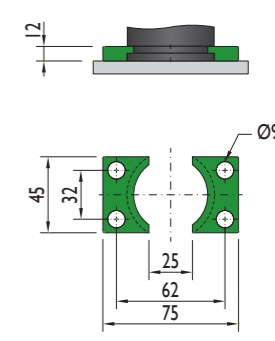

XS-750

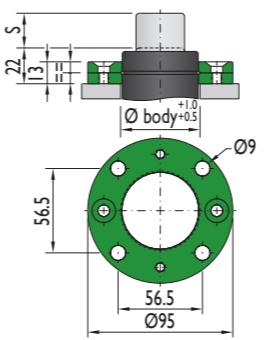

XC-750

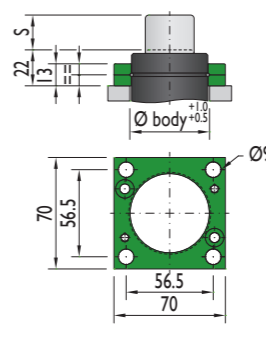

PR-750

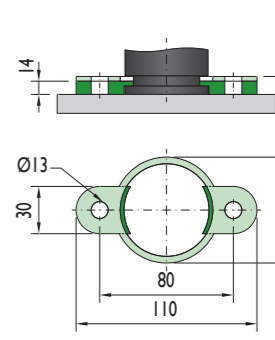

CS-750

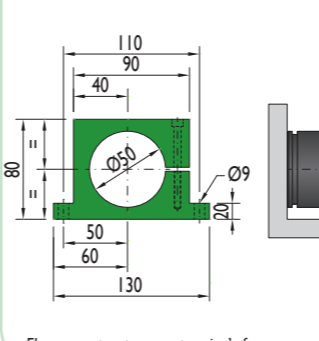

CF-750

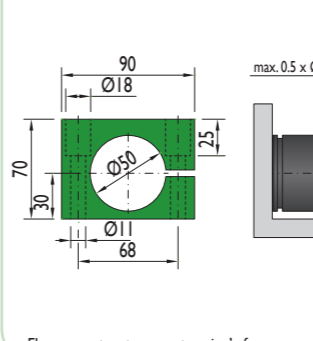



PSA
E24.54.815.G

SMS DNH
3203N

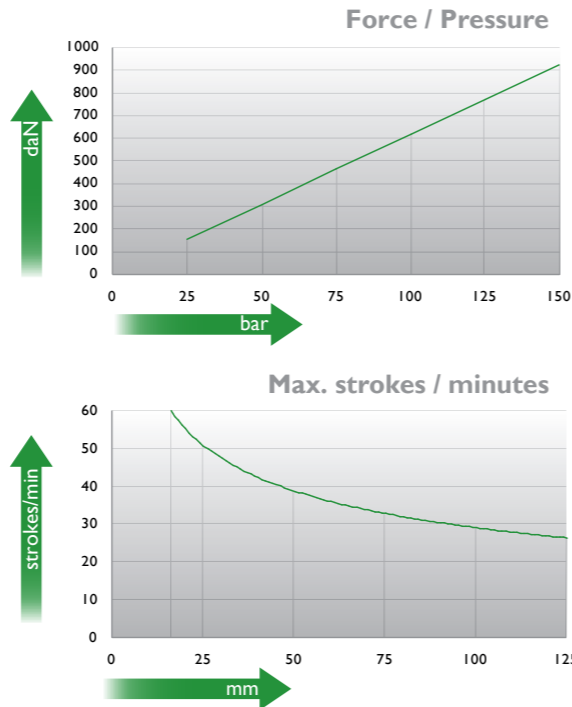
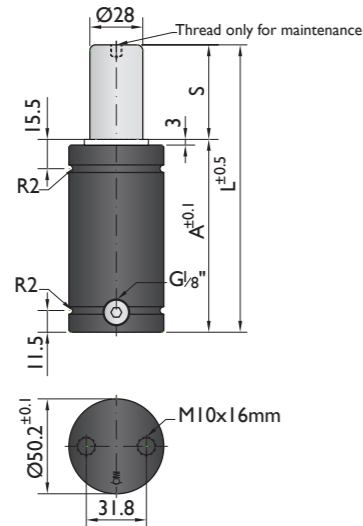

Ordering example: 4 x NT-1000-125

Order No.	S ⁽¹⁾ mm	L mm	A mm	F ₀ ⁽²⁾ daN	F daN	(3)	kg
NT-1000-13	13	78	65	920	1300	No	0.70
NT-1000-16	16	84	68		1300	No	0.76
NT-1000-19	19	90	71		1300	No	0.80
NT-1000-25	25	102	77		1300	No	0.84
NT-1000-32	32	116	84		1300	No	0.90
NT-1000-38	38	128	90		1400	No	0.96
NT-1000-50	50	152	102		1400	Yes	1.06
NT-1000-63	63	178	115		1400	Yes	1.18
NT-1000-75	75	202	127		1400	Yes	1.28
NT-1000-80	80	212	132		1400	Yes	1.35
NT-1000-100	100	252	152		1400	Yes	1.40
NT-1000-125	125	302	177		1400	Yes	1.49

(1) other strokes under request (2) alternative forces upon request (3) ESK available for other strokes



Pressure medium	N ₂	Working temperature	0-80°C	Min. security stroke	10%
Max. Charging pressure	150 bar	Temperature related force increase	+0.34%/°C	Repair Kit	KIT NT-1000
Min. Charging pressure	25 bar	Max. working speed	1.6 m/s	Linkable	G1/8"

Mounting possibilities

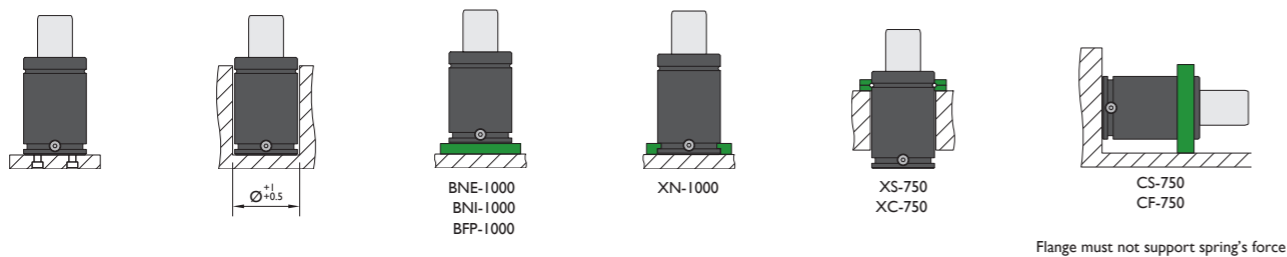

Flanges

BNE-1000

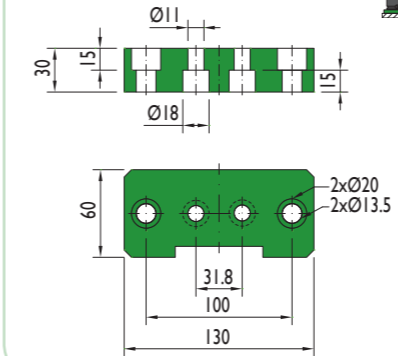

BNI-1000

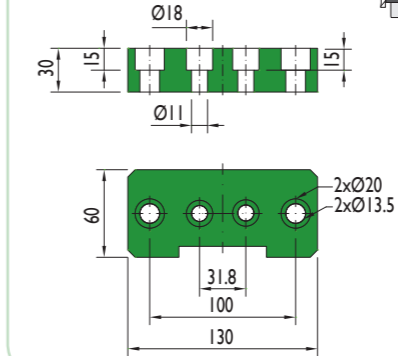

BFP-1000

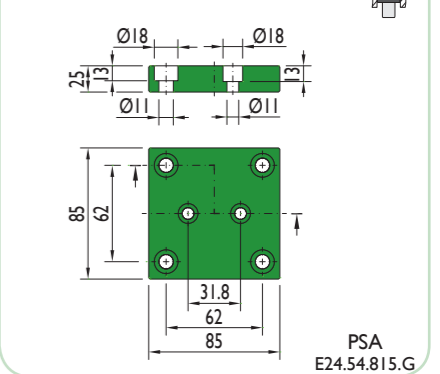

XN-1000

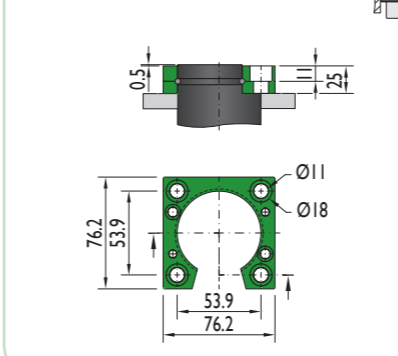

XS-750

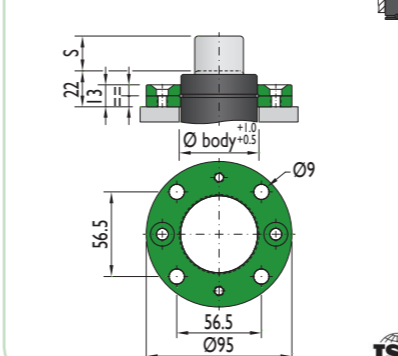

XC-750

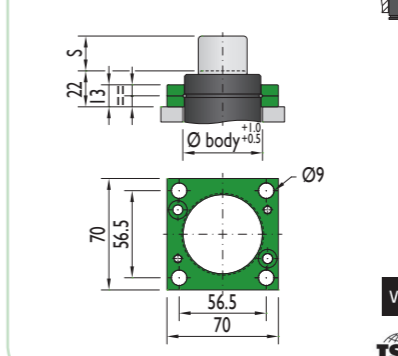

CS-750

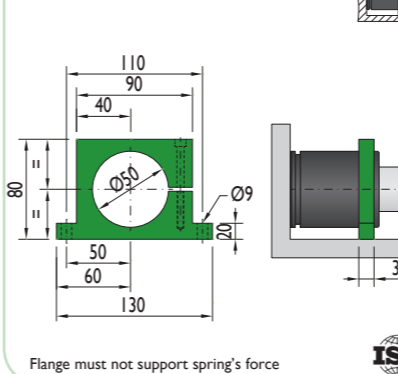

CF-750

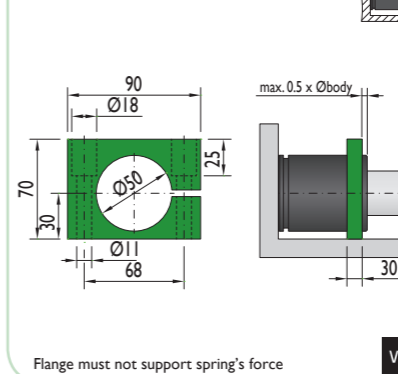



*The new cylinder will be supplied when the stock runs out.

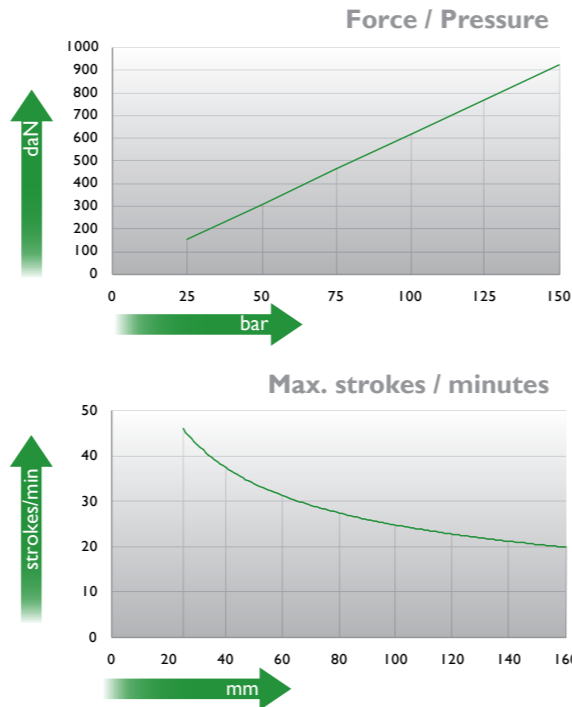
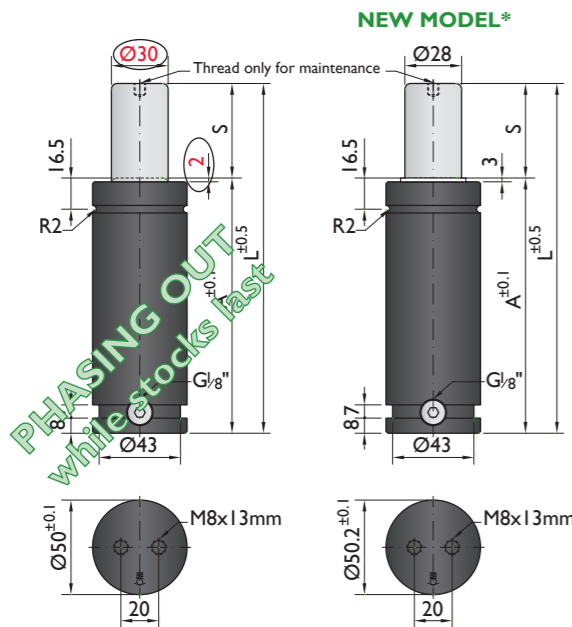

Ordering example: 4 x M-1000-125

Order No.	S ⁽¹⁾ mm	L mm	A mm	F ₀ ⁽²⁾ daN	F daN	(3)	kg
M-1000-25	25	135	110	920	1300	No	1.18
M-1000-38	38	161	123		1400	No	1.30
M-1000-50	50	185	135		1400	No	1.43
M-1000-63	63	211	148		1500	No	1.55
M-1000-80	80	245	165		1500	Yes	1.92
M-1000-100	100	295	195		1500	Yes	2.17
M-1000-125	125	345	220		1600	Yes	2.40
M-1000-160	160	415	255		1600	Yes	2.79

other strokes under request

alternative forces upon request

ESK available for other strokes



Pressure medium	N ₂	Working temperature	0-80°C	Min. security stroke	10%
Max. Charging pressure	140 bar	Temperature related force increase	+0.34%/°C	Repair Kit	KIT M-1000
Min. Charging pressure	25 bar	Max. working speed	1.6 m/s	Linkable	G1/8"

Mounting possibilities

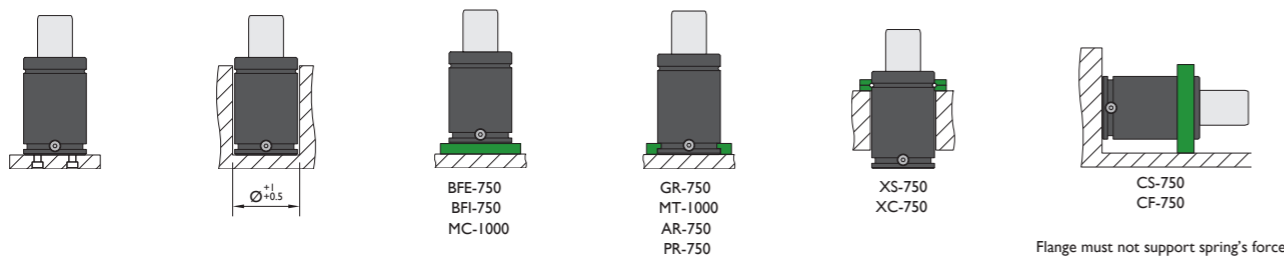

Flange must not support spring's force

Flanges

BFE-750

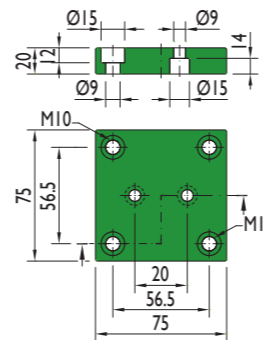

BFI-750

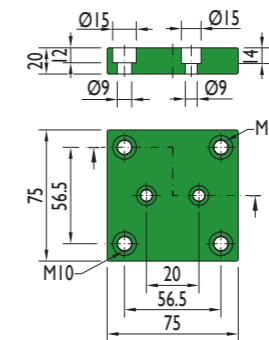

MC-1000

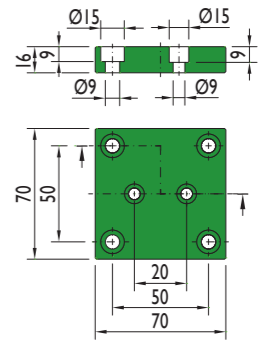

GR-750

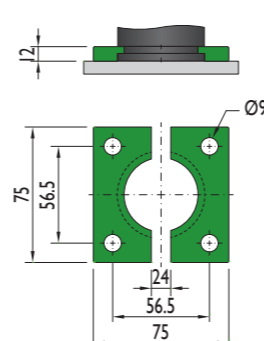

MT-1000

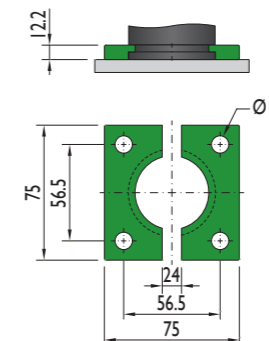

AR-750

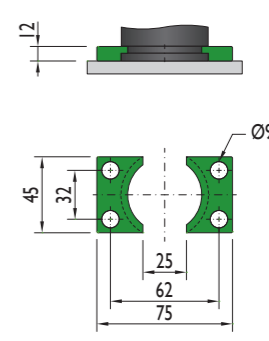

XS-750

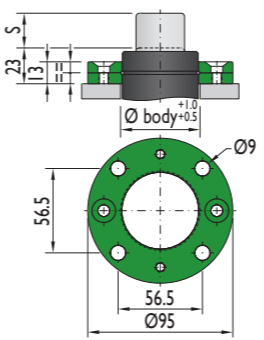

XC-750

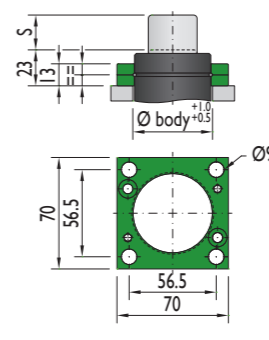

PR-750

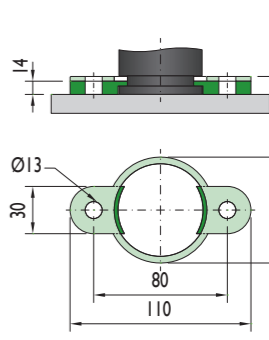

CS-750

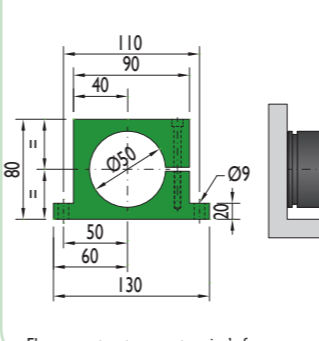

CF-750

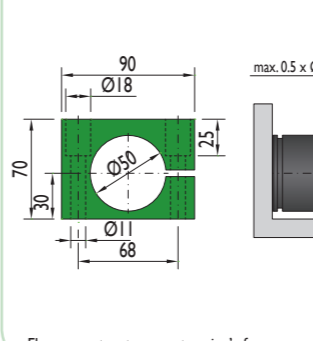

Flange must not support spring's force

Flange must not support spring's force

Special mounts available on
www.nitrogas.com



*The new cylinder will be supplied when the stock runs out.

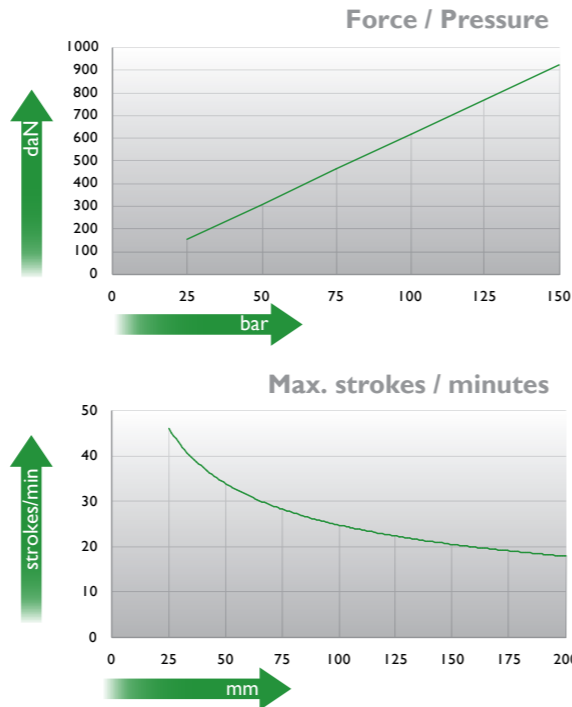
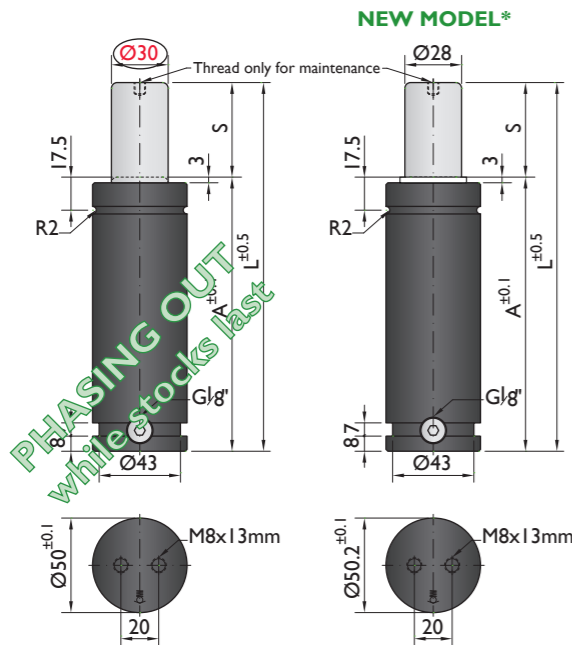

Ordering example: 4 x HD-1000-125

Order No.	S ⁽¹⁾ mm	L mm	A mm	F ₀ ⁽²⁾ daN	F daN	(3)	kg
HD-1000-25	25	145	120		1300	No	1.24
HD-1000-38	38	171	133		1400	No	1.35
HD-1000-50	50	195	145		1400	No	1.67
HD-1000-63	63	221	158		1500	No	1.78
HD-1000-80	80	255	175		1500	Yes	1.92
HD-1000-100	100	295	195	920	1500	Yes	2.06
HD-1000-125	125	345	220		1600	Yes	2.27
HD-1000-160	160	415	255		1700	Yes	2.69
HD-1000-200	200	495	295		1700	Yes	3.13
HD-1000-250	250	595	345		1800	Yes	3.56
HD-1000-300	300	695	395		1800	Yes	3.98

⁽¹⁾ other strokes under request

⁽²⁾ alternative forces upon request

⁽³⁾ ESK available for other strokes



Pressure medium	N ₂	Working temperature	0-80°C	Min. security stroke	10%
Max. Charging pressure	140 bar	Temperature related force increase	+0.34%/°C	Repair Kit	KIT HD-1000
Min. Charging pressure	25 bar	Max. working speed	1.6 m/s	Linkable	G1/8"

Mounting possibilities

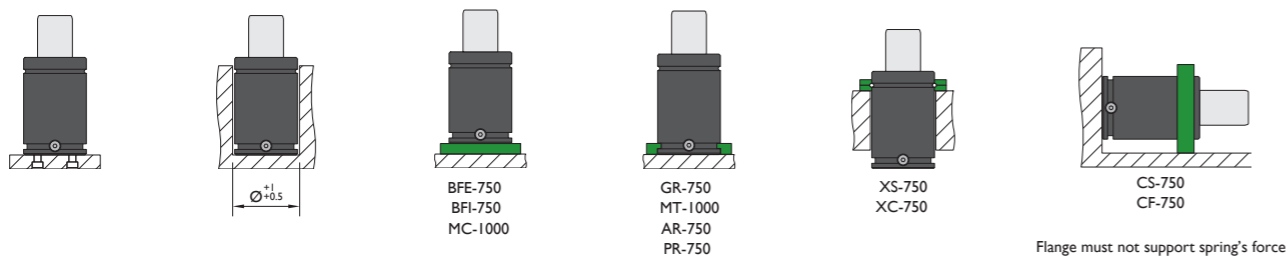

Flange must not support spring's force

Flanges

BFE-750

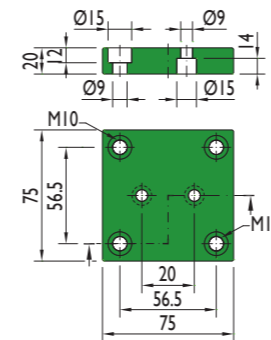

BFI-750

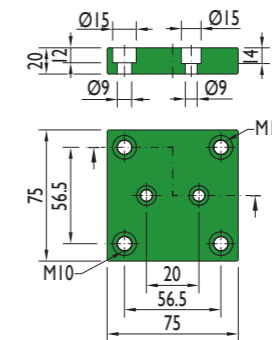

MC-1000

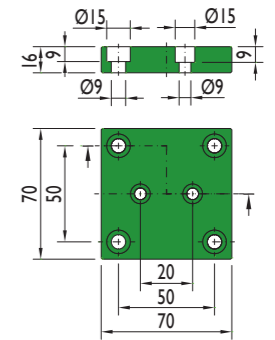

GR-750

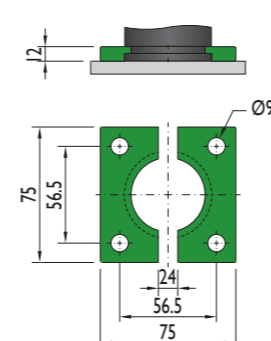

MT-1000

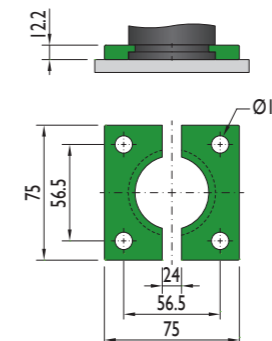

AR-750

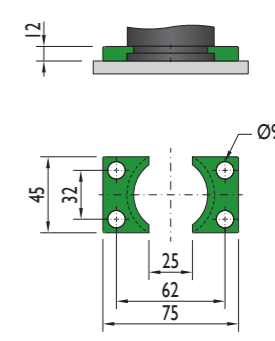

XS-750

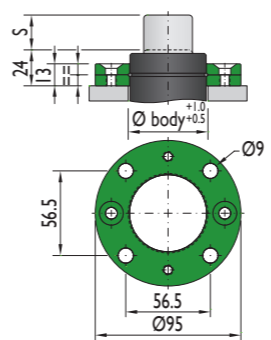

XC-750

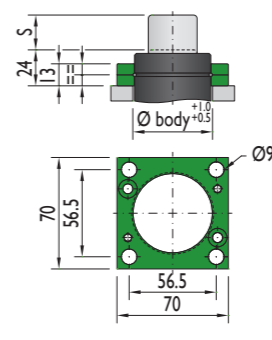

PR-750

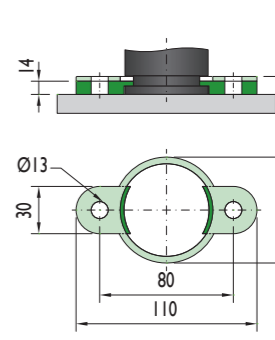

CS-750

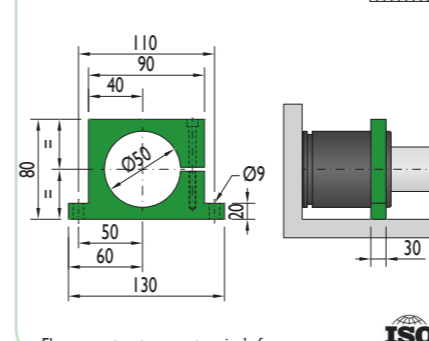

CF-750

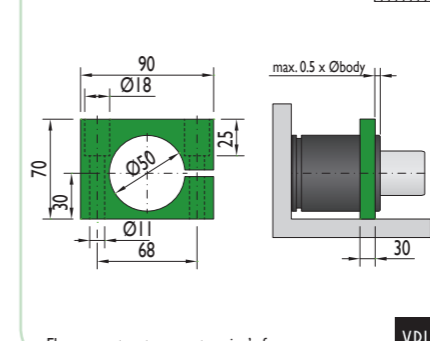

Flange must not support spring's force

Flange must not support spring's force

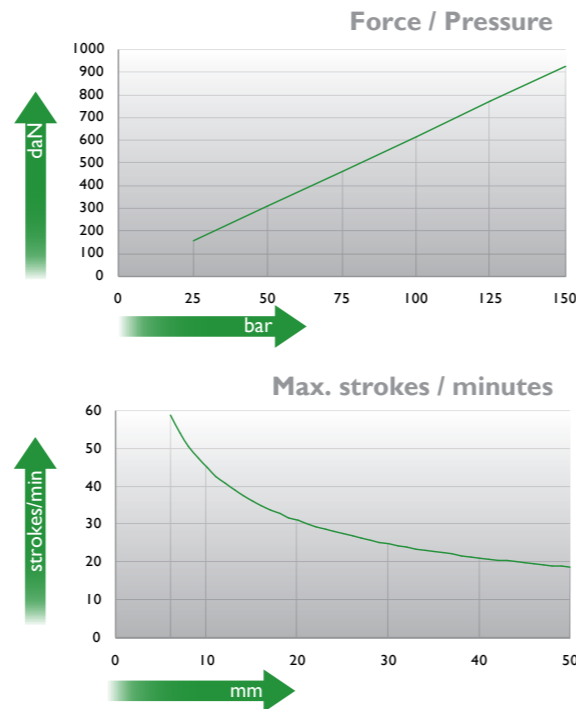
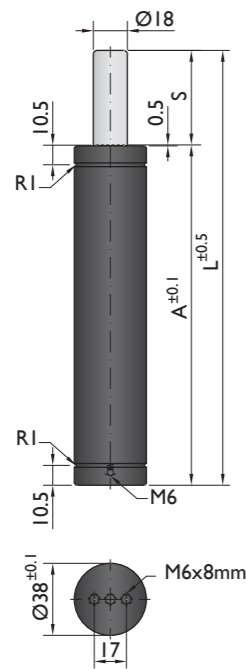

Ordering example: 4 x T-1000-50

Order No.	S ⁽¹⁾ mm	L mm	A mm	F ₀ ⁽²⁾ daN (20°C, 150 bar)	F daN	kg
T-1000-6	6	61	55		1300	0.36
T-1000-10	10	78	68		1500	0.44
T-1000-16	16	100	84		1400	0.52
T-1000-25	25	135	110	920	1400	0.63
T-1000-32	32	167	135		1400	0.73
T-1000-40	40	195	155		1400	0.81
T-1000-50	50	230	180		1400	0.98

⁽¹⁾ other strokes under request

⁽²⁾ alternative forces upon request



Pressure medium	N ₂	Working temperature	0-80°C	Min. security stroke	10%
Max. Charging pressure	150 bar	Temperature related force increase	+0.34%/°C	Repair Kit	KIT T-1000
Min. Charging pressure	25 bar	Max. working speed	0.5 m/s	Linkable	No

Mounting possibilities

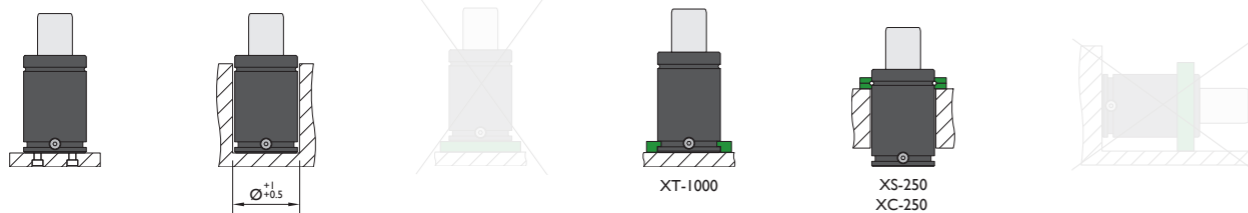

Flanges

XT-1000

XS-250

XC-250

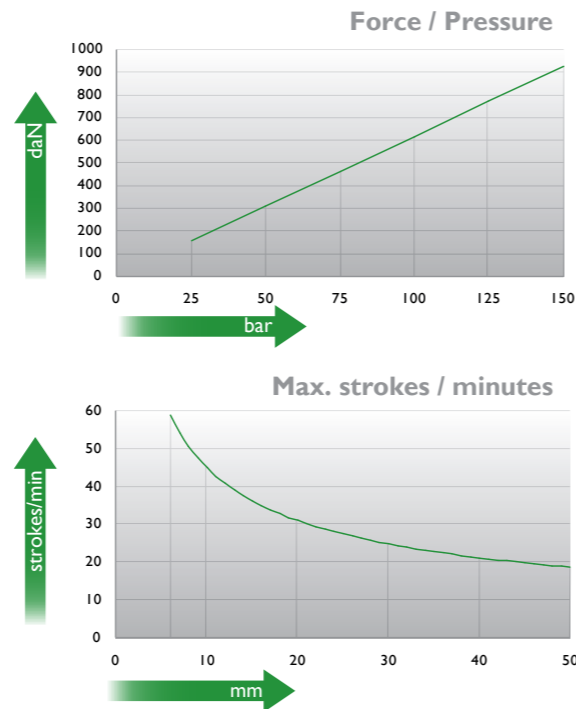
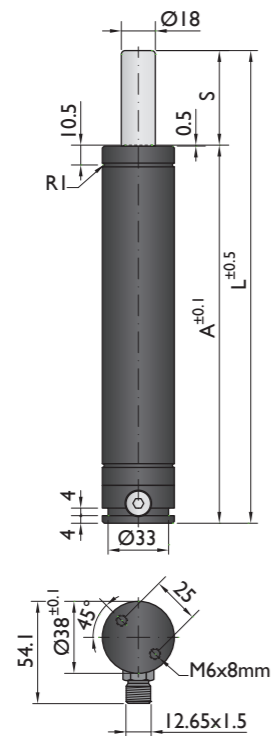

Ordering example: 4 x TC-1000-50

Order No.	S ⁽¹⁾ mm	L mm	A mm	F ₀ ⁽²⁾ daN (20°C, 150 bar)	F daN		kg
TC-1000-6	6	81	75		1300	No	0.50
TC-1000-10	10	98	88		1500	No	0.58
TC-1000-16	16	120	104		1400	No	0.66
TC-1000-25	25	155	130	920	1400	No	0.77
TC-1000-32	32	187	155		1400	No	0.87
TC-1000-40	40	215	175		1400	No	0.95
TC-1000-50	50	250	200		1400	No	1.12

⁽¹⁾ other strokes under request

⁽²⁾ alternative forces upon request



Pressure medium	N ₂	Working temperature	0-80°C	Min. security stroke	10%
Max. Charging pressure	150 bar	Temperature related force increase	+0.34%/°C	Repair Kit	KIT TC-1000
Min. Charging pressure	25 bar	Max. working speed	0.5 m/s	Linkable	G1/8"

Mounting possibilities

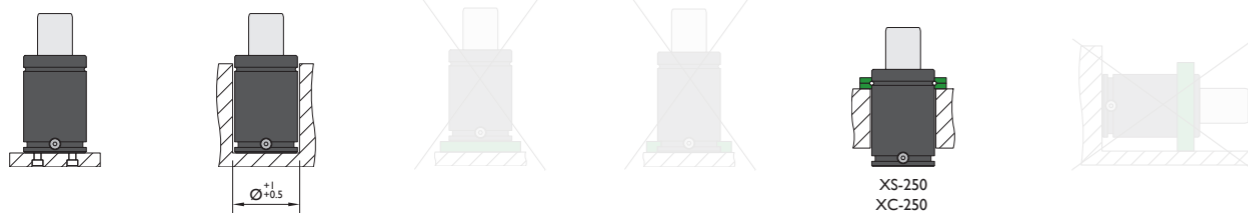

Flanges

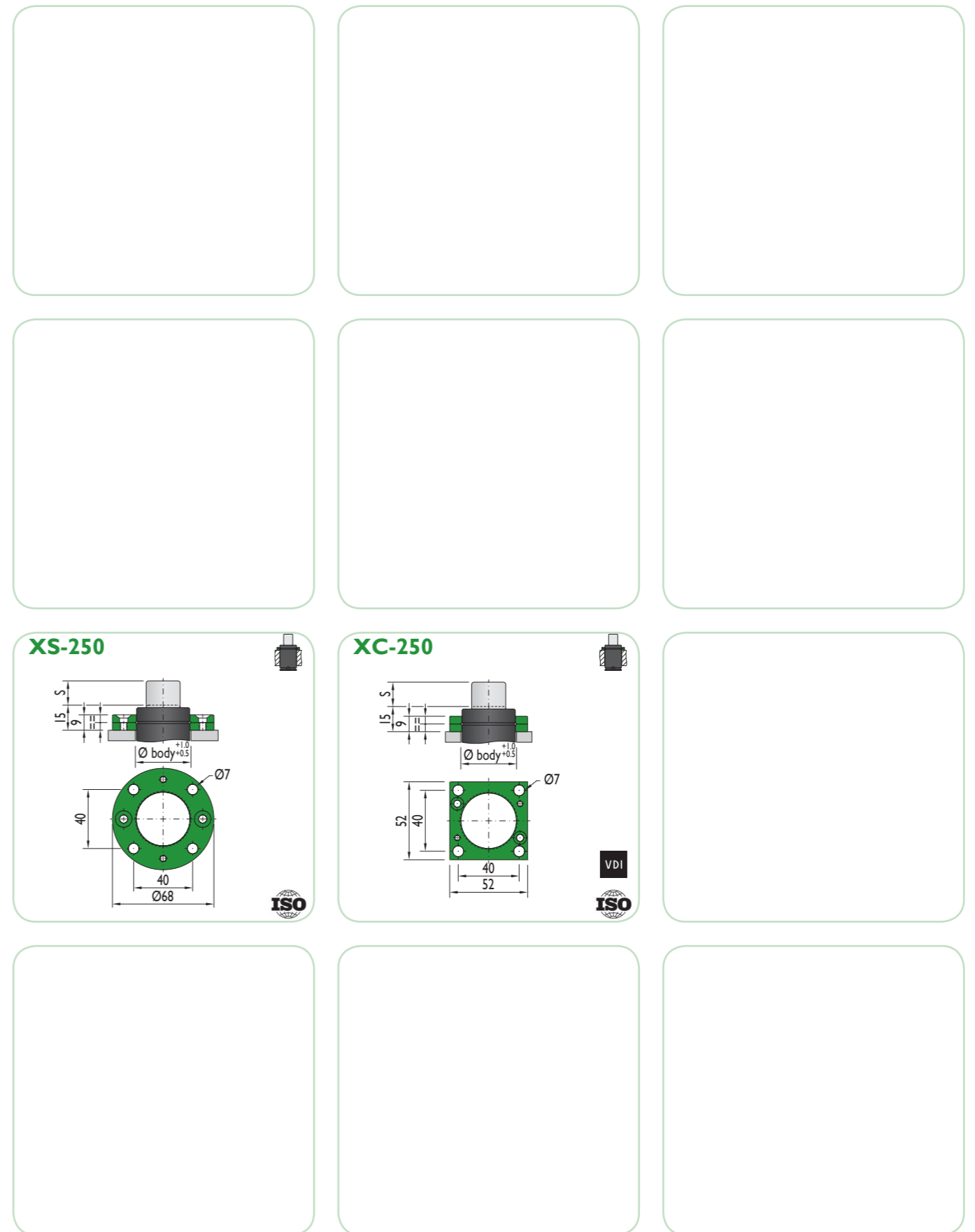

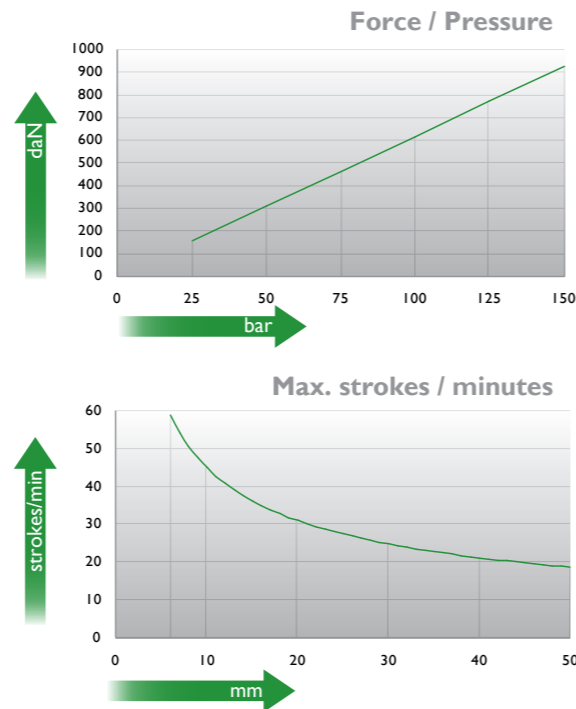
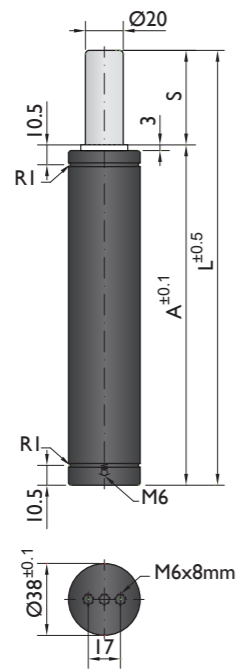

Ordering example: 4 x TS-1000-50

Order No.	S ⁽¹⁾ mm	L mm	A mm	F ₀ ⁽²⁾ daN (20°C, 150 bar)	F daN	kg
TS-1000-6	6	61	55		1300	0.36
TS-1000-10	10	78	68		1500	0.44
TS-1000-16	16	100	84		1400	0.52
TS-1000-25	25	135	110	920	1400	0.63
TS-1000-32	32	167	135		1400	0.73
TS-1000-40	40	195	155		1400	0.81
TS-1000-50	50	230	180		1400	0.98

⁽¹⁾ other strokes under request

⁽²⁾ alternative forces upon request



Pressure medium	N ₂	Working temperature	0-80°C	Min. security stroke	10%
Max. Charging pressure	150 bar	Temperature related force increase	+0.34%/°C	Repair Kit	KIT TS-1000
Min. Charging pressure	25 bar	Max. working speed	0.5 m/s	Linkable	No

Mounting possibilities

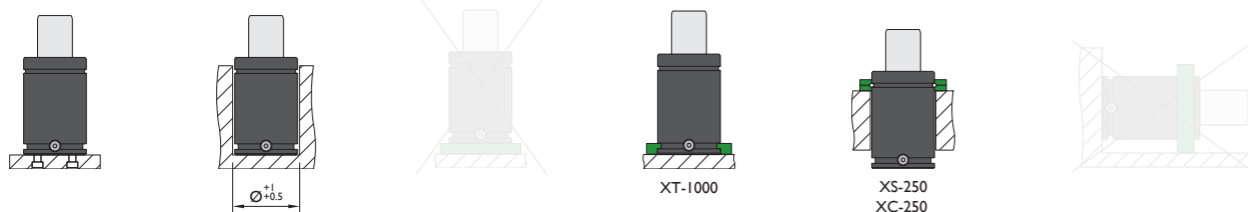

Flanges

XT-1000 		
XS-250 	XC-250 	

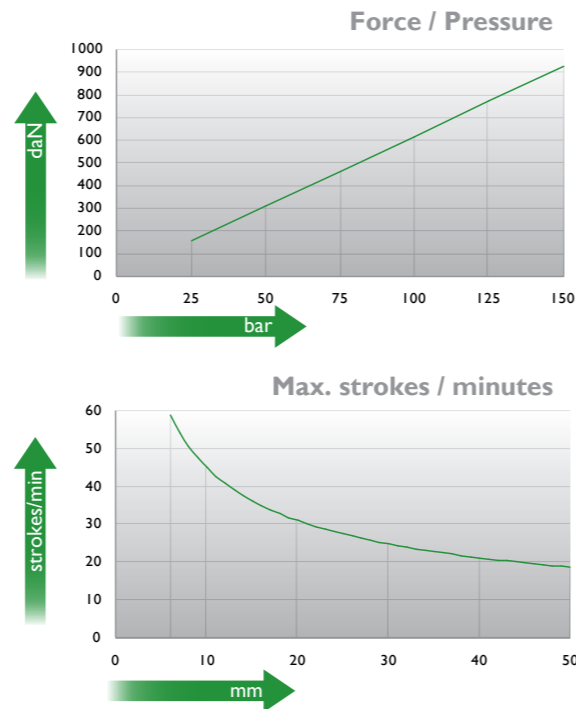
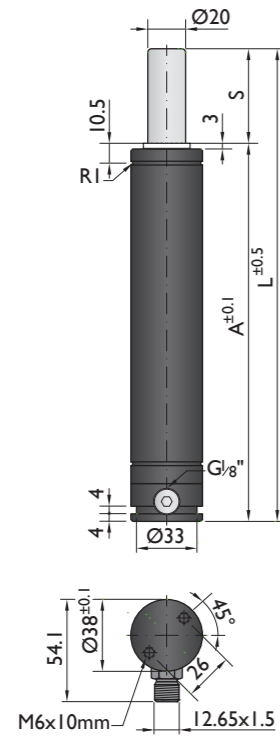

Ordering example: 4 x TSC-1000-50

Order No.	S ⁽¹⁾ mm	L mm	A mm	F ₀ ⁽²⁾ daN (20°C, 150 bar)	F daN		kg
TSC-1000-6	6	81	75		1300	No	0.50
TSC-1000-10	10	98	88		1500	No	0.58
TSC-1000-16	16	120	104		1400	No	0.66
TSC-1000-25	25	155	130	920	1400	No	0.77
TSC-1000-32	32	187	155		1400	No	0.87
TSC-1000-40	40	215	175		1400	No	0.95
TSC-1000-50	50	250	200		1400	No	1.12

⁽¹⁾ other strokes under request

⁽²⁾ alternative forces upon request



Pressure medium	N ₂	Working temperature	0-80°C	Min. security stroke	10%
Max. Charging pressure	150 bar	Temperature related force increase	+0.34%/°C	Repair Kit	KIT TSC-1000
Min. Charging pressure	25 bar	Max. working speed	0.5 m/s	Linkable	G1/8"

Mounting possibilities

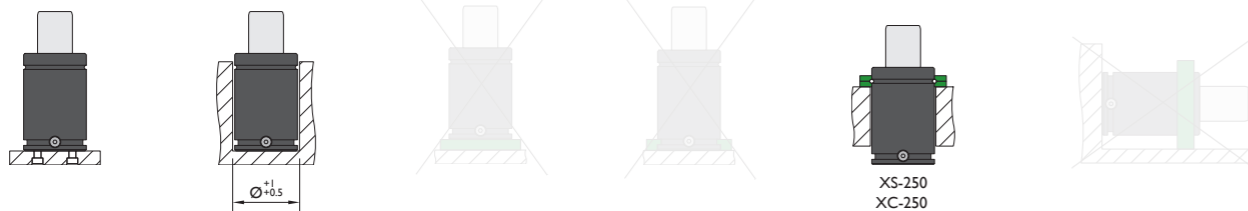

Flanges

