

## Force 1500 daN

### Piston Rod Sealed gas springs

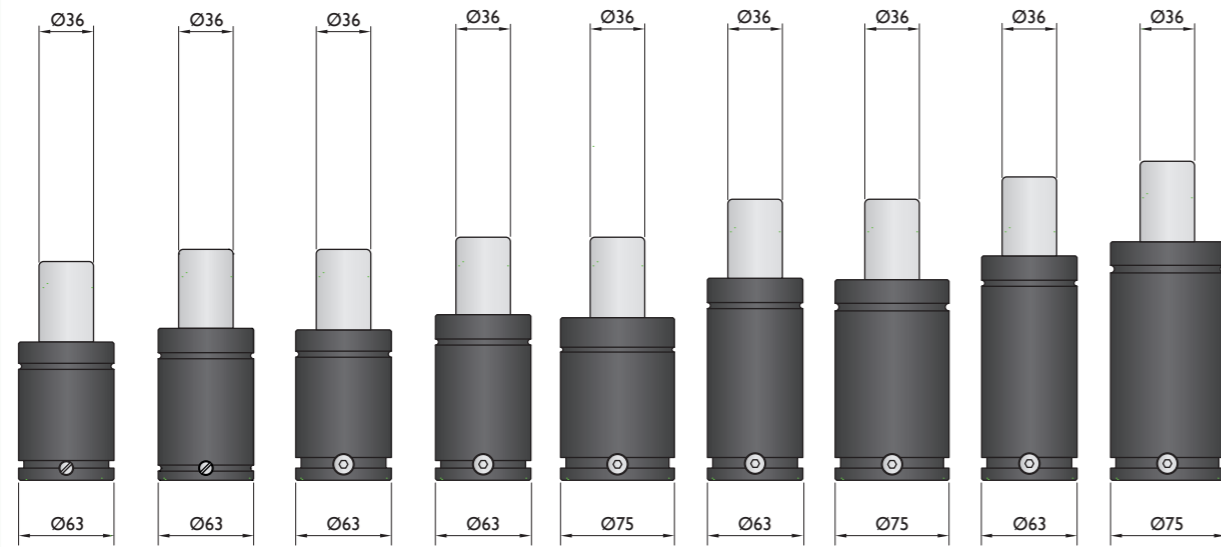
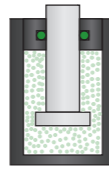

Model	KP-1500	KC-1500	NR-1500	K-1500	KH-1500	M-1500	HG-1500	HD-1500	G-1500
Initial F (daN)	1500	1500	1500	1500	1500	1500	1500	1500	1500
L max (mm)	2xStroke+44	2xStroke+52	2xStroke+52	2xStroke+60	2xStroke+60	2xStroke+85	2xStroke+85	2xStroke+95	2xStroke+110
Stroke (mm)	13-125	12-125	13-125	12-125	25-125	25-160	25-200	25-300	25-300

\* other strokes under request

### Standards

	PED 97/23/EC	PED 97/23/EC	PED 97/23/EC	PED 97/23/EC	PED 97/23/EC	PED 97/23/EC	PED 97/23/EC	PED 97/23/EC	PED 97/23/EC
ISO	ISO 11901	ISO 11901	ISO 11901	ISO 11901	ISO 11901	ISO 11901	ISO 11901	ISO 11901	ISO 11901
VDI	VDI 3003	VDI 3003	VDI 3003	VDI 3003	VDI 3003	VDI 3003	VDI 3003	VDI 3003	VDI 3003
CNOMO	CNOMO EM24.54.700	CNOMO EM24.54.700	CNOMO EM24.54.700	CNOMO EM24.54.700	CNOMO EM24.54.700	CNOMO EM24.54.700	CNOMO EM24.54.700	CNOMO EM24.54.700	CNOMO EM24.54.700

## Force 1500 daN

### Bore Sealed gas springs

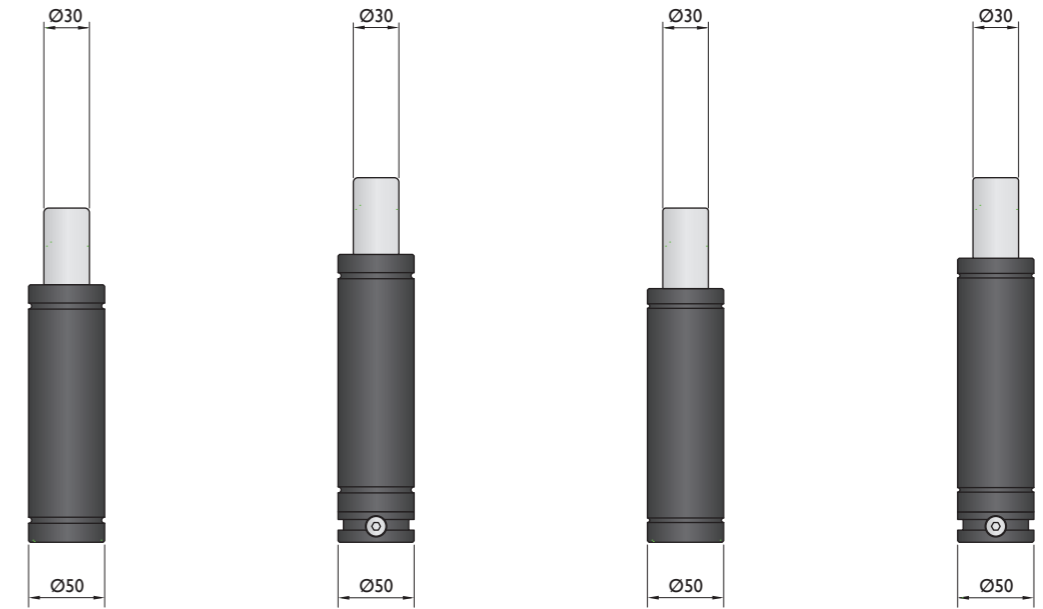

Model	T-1800	TC-1800	TS-1800	TSC-1800
Initial F (daN)	1800	1800	1800	1800
L max (mm)	66-220	86-240	66-271	86-291
Stroke (mm)	6-50	6-50	6-65	6-65

\* other strokes under request

### Standards

	PED 97/23/EC	PED 97/23/EC	PED 97/23/EC	PED 97/23/EC
ISO	ISO 11901	ISO 11901	ISO 11901	ISO 11901
VDI	VDI 3003	VDI 3003	VDI 3003	VDI 3003
CNOMO	CNOMO EM24.54.700	CNOMO EM24.54.700	CNOMO EM24.54.700	CNOMO EM24.54.700



\*The new cylinder will be supplied when the stock runs out.

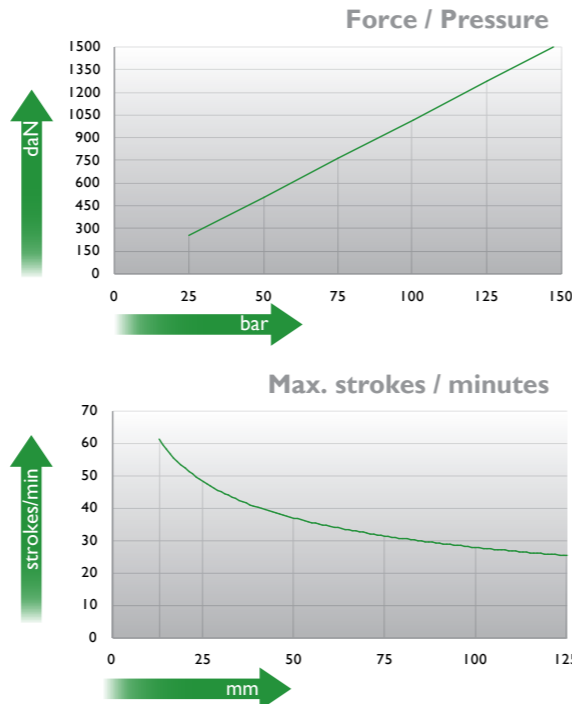
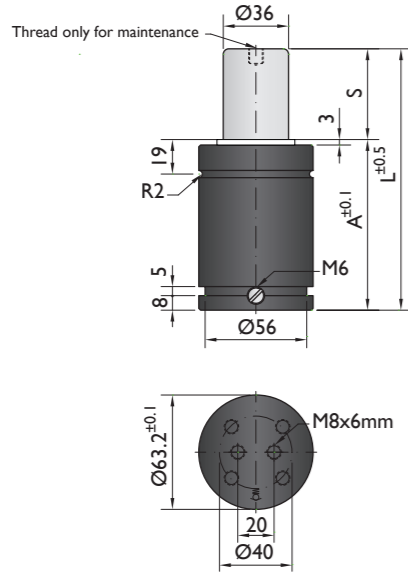

Ordering example: 4 x KP-1500-125

Order No.	S <sup>(1)</sup> mm	L mm	A mm	F <sub>0</sub> <sup>(2)</sup> daN (20°C, 150 bar)	F daN	<sup>(3)</sup>	kg
KP-1500-13	13	70	57	1500	2200	No	0.94
KP-1500-16	16	76	60		2200	No	1.01
KP-1500-19	19	82	63		2200	No	1.06
KP-1500-25	25	94	69		2200	No	1.16
KP-1500-32	32	108	76		2300	No	1.27
KP-1500-38	38	120	82		2300	No	1.37
KP-1500-50	50	144	94		2400	Yes	1.57
KP-1500-63	63	170	107		2400	Yes	1.78
KP-1500-75	75	194	119		2400	Yes	1.98
KP-1500-80	80	204	124		2400	Yes	2.06
KP-1500-100	100	244	144		2400	Yes	2.37
KP-1500-125	125	294	169		2400	Yes	2.80

<sup>(1)</sup> other strokes under request      <sup>(2)</sup> alternative forces upon request      <sup>(3)</sup> ESK available for other strokes



Pressure medium	N <sub>2</sub>	Working temperature	0-80°C	Min. security stroke	10%
Max. Charging pressure	150 bar	Temperature related force increase	+0.34%/°C	Repair Kit	KIT KP-1500
Min. Charging pressure	25 bar	Max. working speed	1.6 m/s	Linkable	M6

### Mounting possibilities

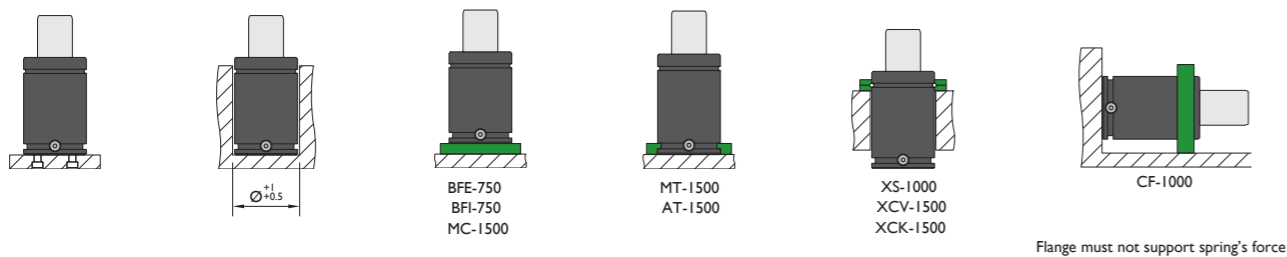

Flange must not support spring's force

## Flanges

### BFE-750

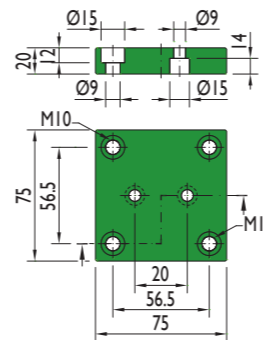

### BFI-750

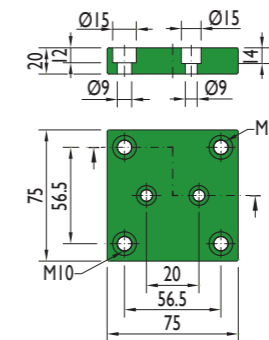

### MC-1500

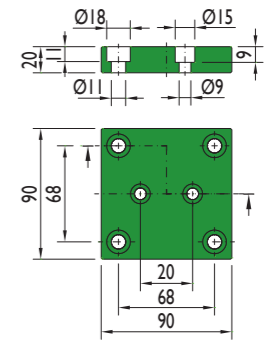

### MT-1500

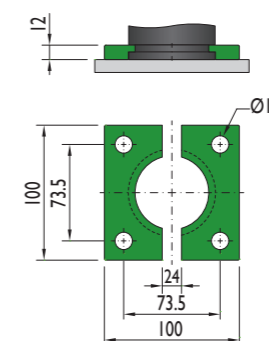

### AT-1500

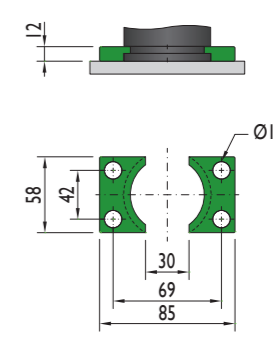

### XS-1000

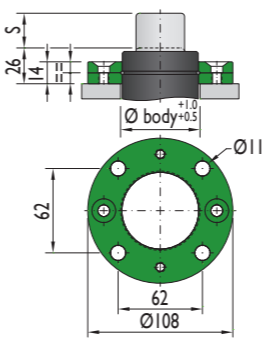

### XCV-1500

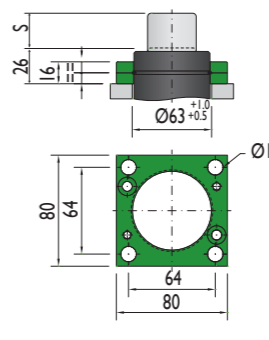

### XCK-1500

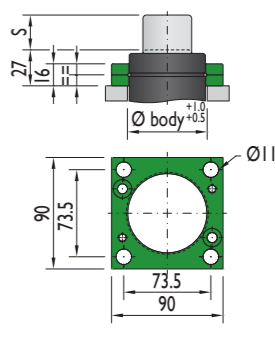

### CF-1000

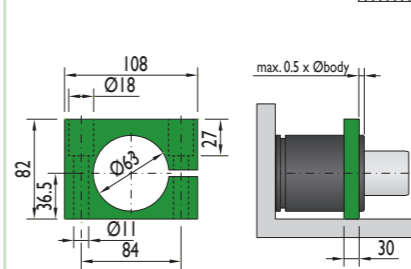

Flange must not support spring's force



\*The new cylinder will be supplied when the stock runs out.

NEW MODEL\*

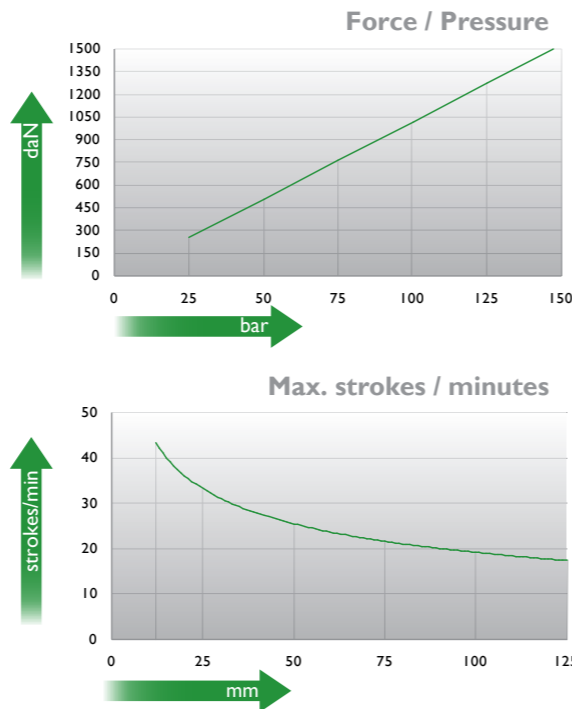
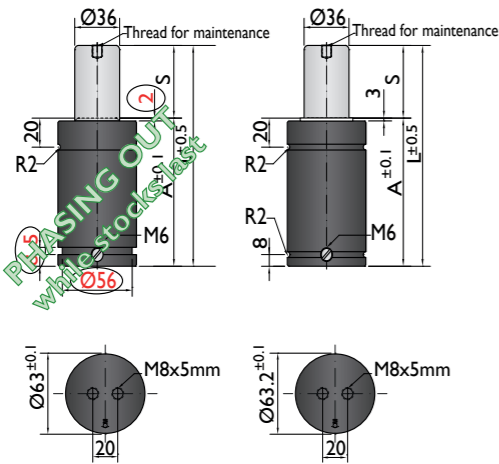

Ordering example: 4 x KC-1500-125

Order No.	S <sup>(1)</sup> mm	L mm	A mm	F <sub>0</sub> <sup>(2)</sup> daN (20°C, 150 bar)	F daN	(3)	kg
KC-1500-12	12	76	64	1500	1800	No	1.02
KC-1500-25	25	102	77		2400	No	1.24
KC-1500-38	38	128	90		2500	No	1.45
KC-1500-50	50	152	102		2600	Yes	1.65
KC-1500-63	63	178	115		2700	Yes	1.86
KC-1500-80	80	212	132		2700	Yes	2.14
KC-1500-100	100	252	152		2700	Yes	2.45
KC-1500-125	125	302	177		2700	Yes	2.88

(1) other strokes under request

(2) alternative forces upon request

(3) ESK available for other strokes



Pressure medium	N <sub>2</sub>	Working temperature	0-80°C	Min. security stroke	10%
Max. Charging pressure	150 bar	Temperature related force increase	+0.34%/°C	Repair Kit	KIT KC-1500
Min. Charging pressure	25 bar	Max. working speed	1.6 m/s	Linkable	M6

### Mounting possibilities

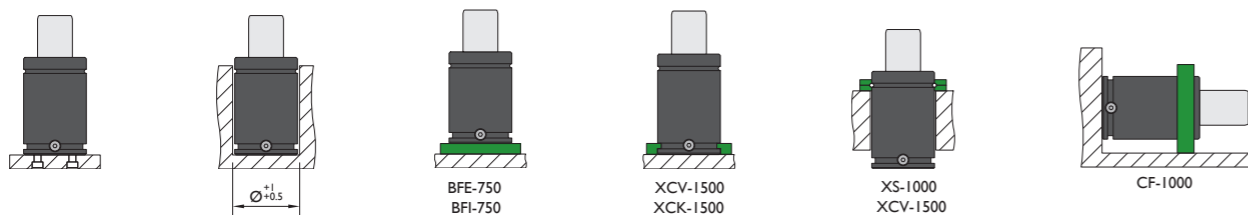

Flange must not support spring's force

## Flanges

### BFE-750

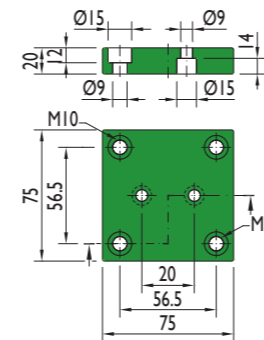

### BFI-750

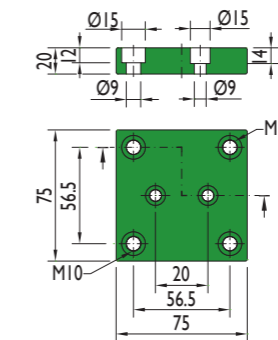

### MC-1500

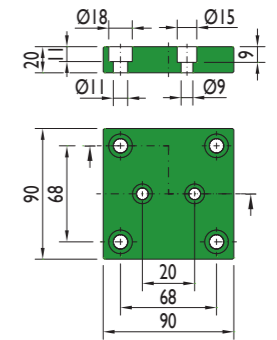

### XCV-1500

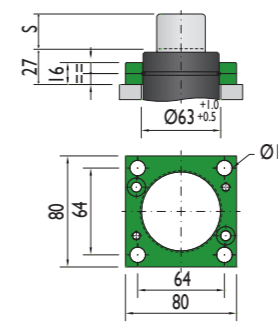

### XCK-1500

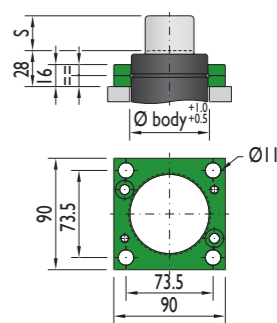

### XS-1000

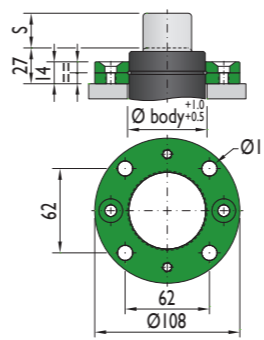

### XCV-1500

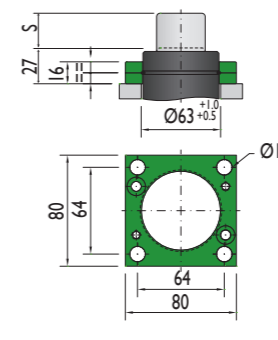

### XCK-1500

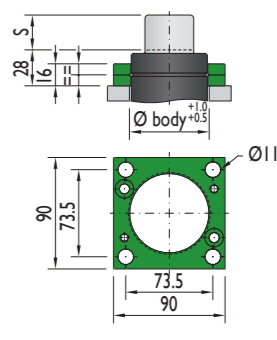

### CF-1000

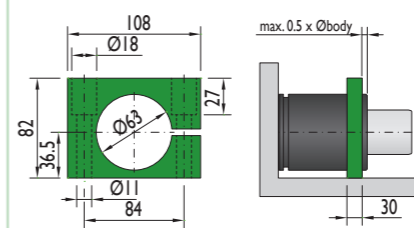

Flange must not support spring's force

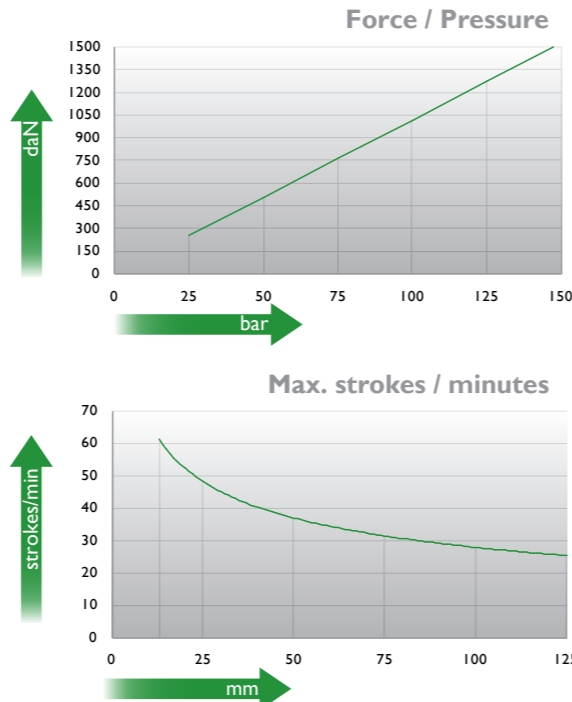
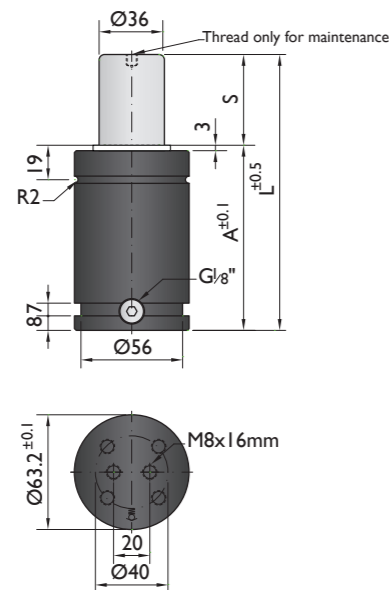

Ordering example: 4 x NR-1500-125

Order No.	S <sup>(1)</sup> mm	L mm	A mm	F <sub>0</sub> <sup>(2)</sup> daN	F daN	(3)	kg
NR-1500-13	13	78	65	2100	2100	No	0.97
NR-1500-16	16	84	68	2200	2200	No	1.04
NR-1500-19	19	90	71	2200	2200	No	1.09
NR-1500-25	25	102	77	2200	2200	No	1.09
NR-1500-32	32	116	84	2300	2300	No	1.30
NR-1500-38	38	128	90	2300	2300	No	1.40
NR-1500-50	50	152	102	2400	2400	Yes	1.60
NR-1500-63	63	178	115	2400	2400	Yes	1.81
NR-1500-75	75	202	127	2400	2400	Yes	2.01
NR-1500-80	80	212	132	2400	2400	Yes	2.09
NR-1500-100	100	252	152	2400	2400	Yes	2.40
NR-1500-125	125	302	177	2400	2400	Yes	2.83

(1) other strokes under request      (2) alternative forces upon request      (3) ESK available for other strokes

	Pressure medium	N <sub>2</sub>	Working temperature	0-80°C	Min. security stroke	10%
	Max. Charging pressure	150 bar	Temperature related force increase	+0.34%/°C	Repair Kit	KIT NR-1500
	Min. Charging pressure	25 bar	Max. working speed	1.6 m/s	Linkable	G1/8"

### Mounting possibilities

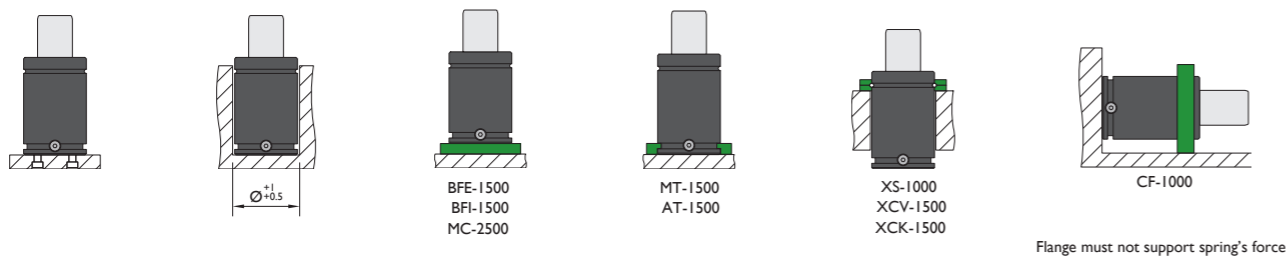

## Flanges

### BFE-1500

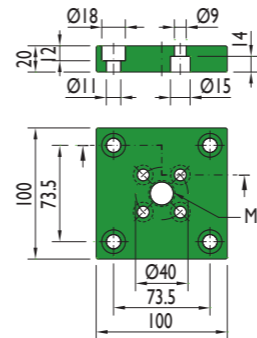

### BFI-1500

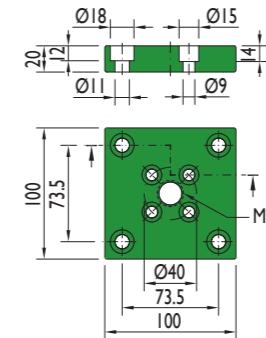

### MC-2500

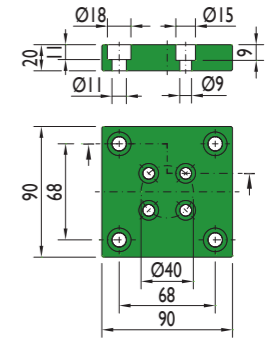

### MT-1500

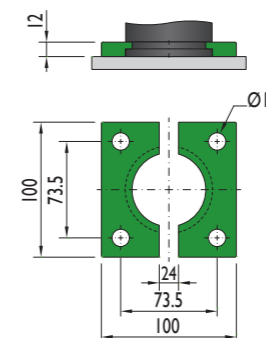

### AT-1500

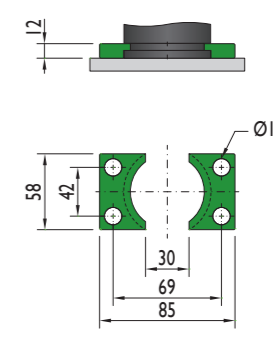

### XS-1000

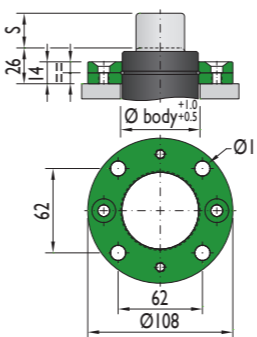

### XCV-1500

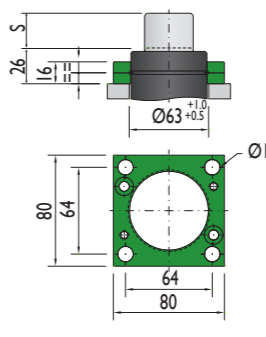

### XCK-1500

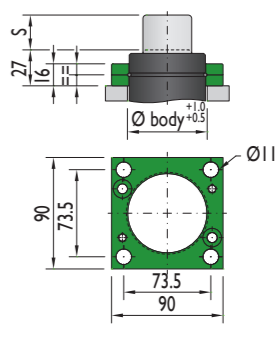

### CF-1000

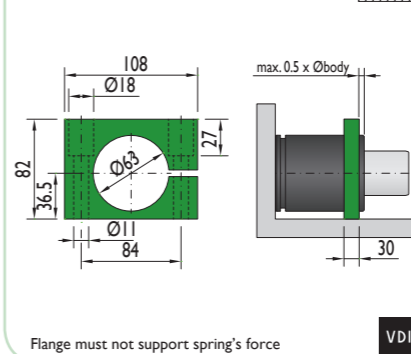

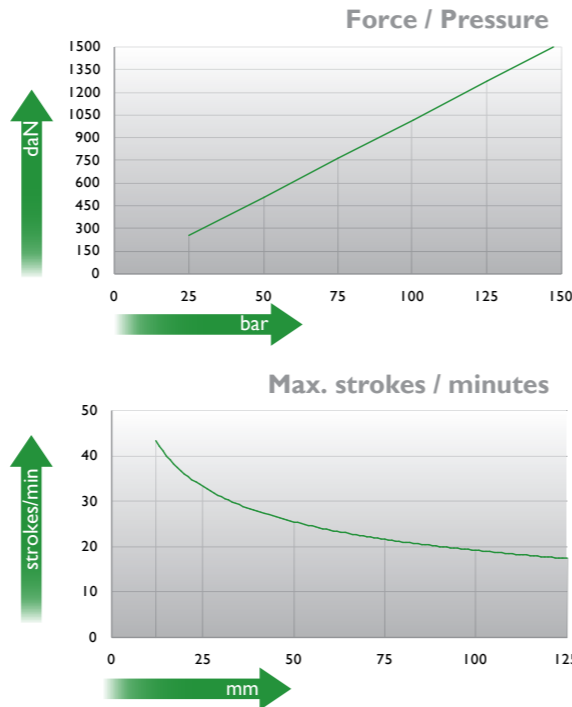
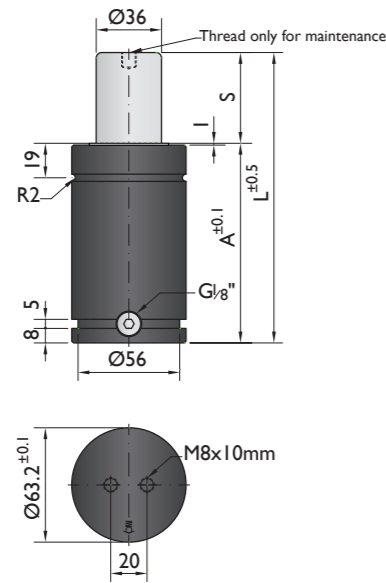

Ordering example: 4 x K-1500-125

Order No.	S <sup>(1)</sup> mm	L mm	A mm	F <sub>0</sub> <sup>(2)</sup> daN	F daN	(3)	kg
K-1500-12	12	84	72	1500 (20°C, 150 bar)	2100	No	1.32
K-1500-25	25	110	85		2300	No	1.49
K-1500-38	38	136	98		2500	No	1.60
K-1500-50	50	160	110		2600	Yes	1.85
K-1500-63	63	186	123		2600	Yes	2.01
K-1500-80	80	220	140		2600	Yes	2.27
K-1500-100	100	260	160		2600	Yes	2.60
K-1500-125	125	310	185		2600	Yes	3.04

other strokes under request

alternative forces upon request

ESK available for other strokes



Pressure medium	N <sub>2</sub>	Working temperature	0-80°C	Min. security stroke	10%
Max. Charging pressure	150 bar	Temperature related force increase	+0.34%/°C	Repair Kit	KIT K-1500
Min. Charging pressure	25 bar	Max. working speed	1.6 m/s	Linkable	G1/8"

### Mounting possibilities

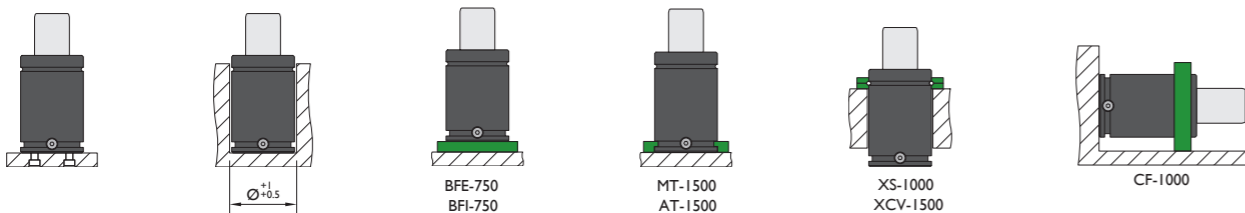

Flange must not support spring's force

## Flanges

### BFE-750

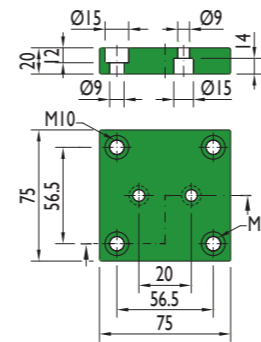

### BFI-750

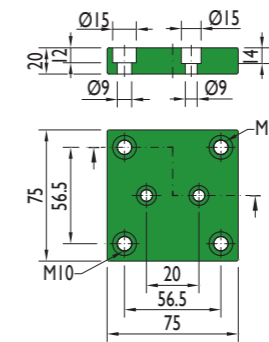

### MC-1500

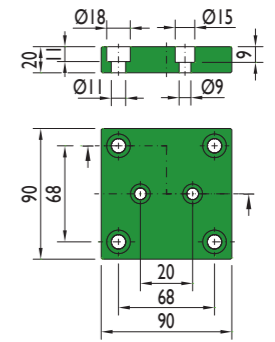

### MT-1500

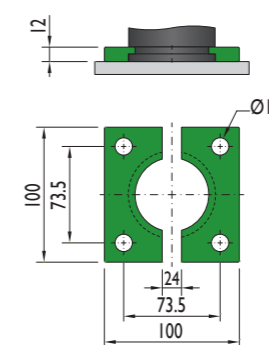

### AT-1500

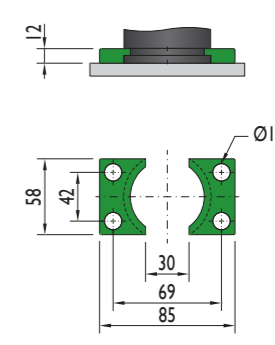

### XS-1000

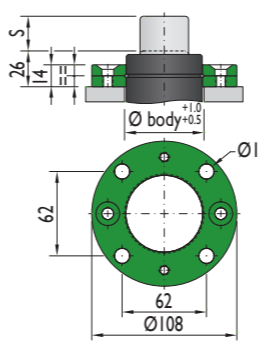

### XCV-1500

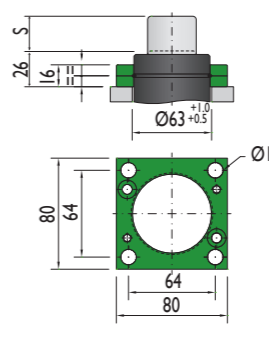

### XCK-1500

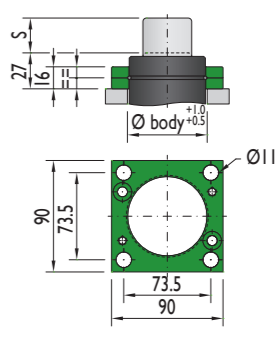

### CF-1000

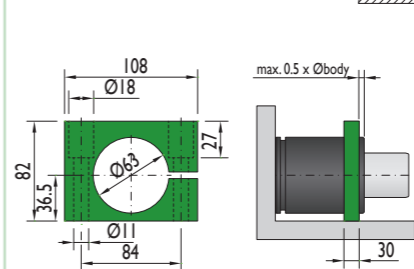

Flange must not support spring's force



CNOMO  
EM24.54.700

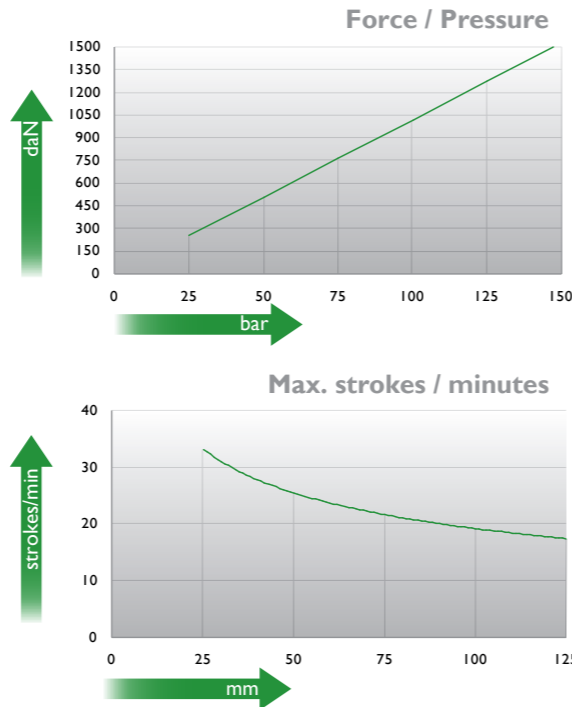
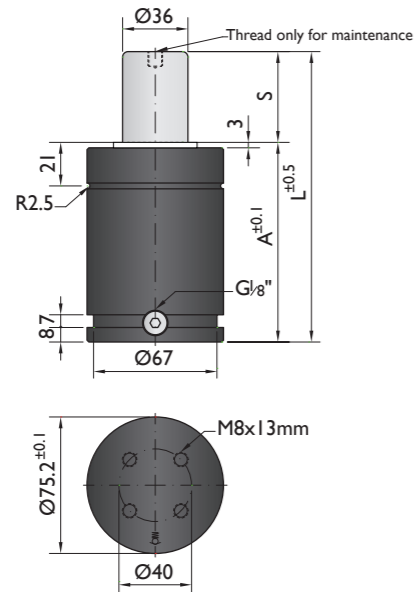

Ordering example: 4 x KH-1500-125

Order No.	S <sup>(1)</sup> mm	L mm	A mm	F <sub>0</sub> <sup>(2)</sup> daN	F daN	(3)	kg
KH-1500-25	25	110	85	1500	2100	No	2.08
KH-1500-38	38.1	136.2	98.1	1500	2200	No	2.33
KH-1500-50	50	160	110	1500	2300	Yes	2.50
KH-1500-63	63.5	187	123.5	1500	2300	Yes	2.73
KH-1500-80	80	220	140	1500	2300	Yes	3.04
KH-1500-100	100	260	160	1500	2300	Yes	3.60
KH-1500-125	125	310	185	1500	2300	Yes	4.75

<sup>(1)</sup> other strokes under request

<sup>(2)</sup> alternative forces upon request

<sup>(3)</sup> ESK available for other strokes



Pressure medium	N <sub>2</sub>	Working temperature	0-80°C	Min. security stroke	10%
Max. Charging pressure	150 bar	Temperature related force increase	+0.34%/°C	Repair Kit	KIT KH-1500
Min. Charging pressure	25 bar	Max. working speed	1.6 m/s	Linkable	G1/8"

### Mounting possibilities

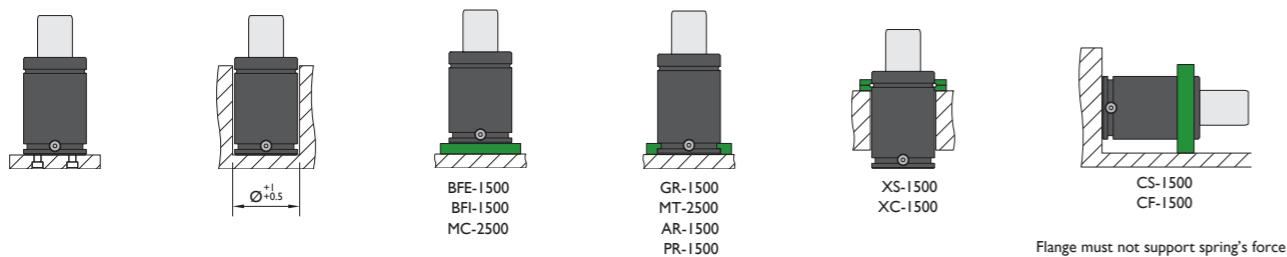

## Flanges

### BFE-1500

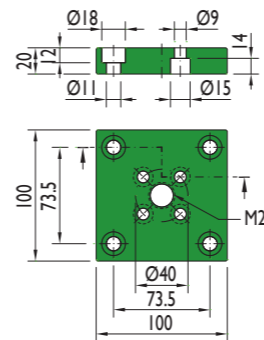

### BFI-1500

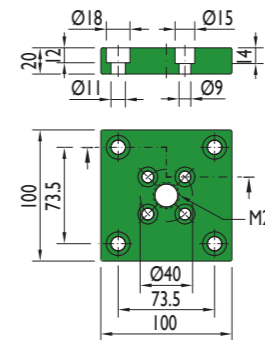

### MC-2500

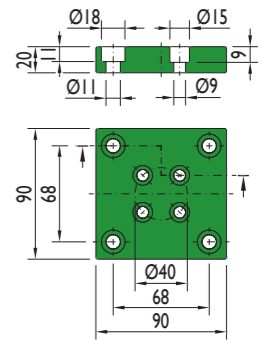

### GR-1500

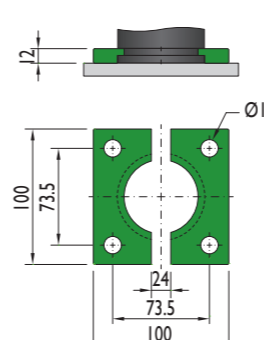

### MT-2500

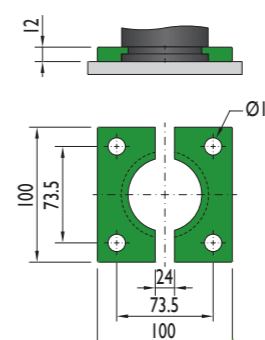

### AR-1500

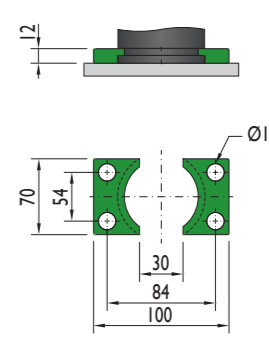

### XS-1500

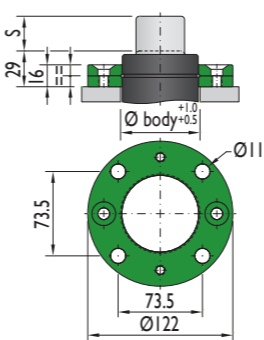

### XC-1500

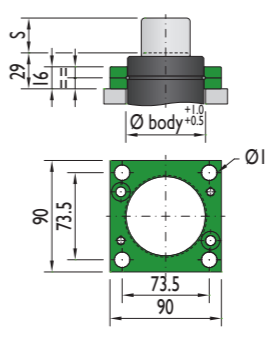

### PR-1500

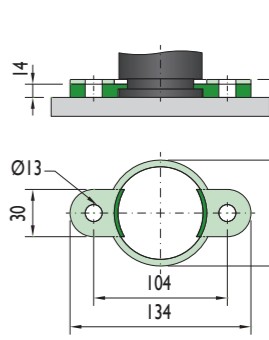

### CS-1500

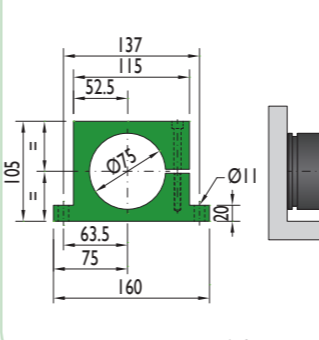

### CF-1500

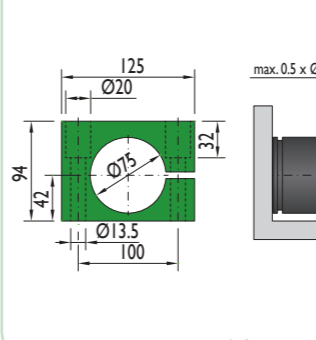



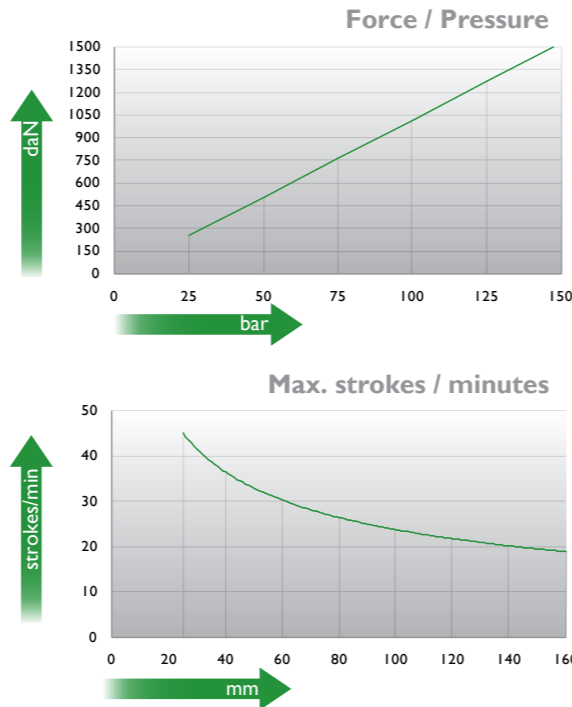
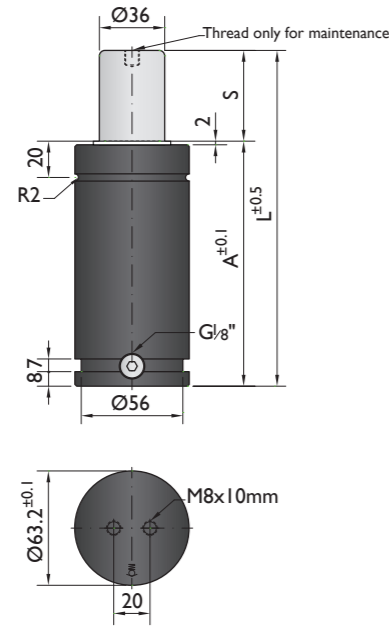

Ordering example: 4 x M-1500-125

Order No.	S <sup>(1)</sup> mm	L mm	A mm	F <sub>0</sub> <sup>(2)</sup> daN (20°C, 150 bar)	F daN	(3)	kg
M-1500-25	25	135	110	1500	2200	No	1.88
M-1500-38	38	161	123		2400	No	2.15
M-1500-50	50	185	135		2400	No	2.25
M-1500-63	63	211	148		2500	No	2.50
M-1500-80	80	245	165		2500	Yes	2.58
M-1500-100	100	285	185		2500	Yes	2.85
M-1500-125	125	345	220		2500	Yes	3.32
M-1500-160	160	415	255		2500	Yes	3.77

<sup>(1)</sup> other strokes under request

<sup>(2)</sup> alternative forces upon request

<sup>(3)</sup> ESK available for other strokes



Pressure medium	N <sub>2</sub>	Working temperature	0-80°C	Min. security stroke	10%
Max. Charging pressure	150 bar	Temperature related force increase	+0.34%/°C	Repair Kit	KIT M-1500
Min. Charging pressure	25 bar	Max. working speed	1.6 m/s	Linkable	G1/8"

### Mounting possibilities

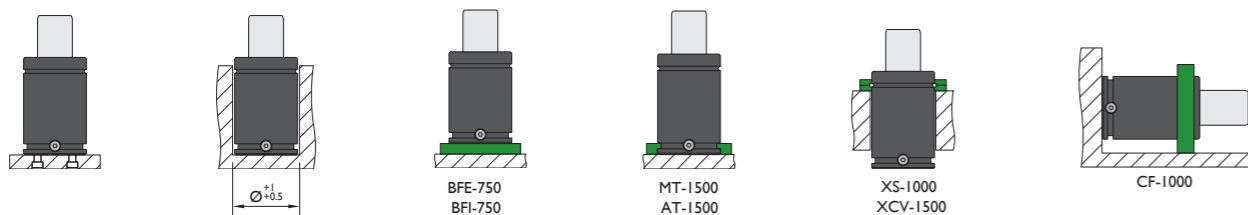

Flange must not support spring's force

## Flanges

### BFE-750

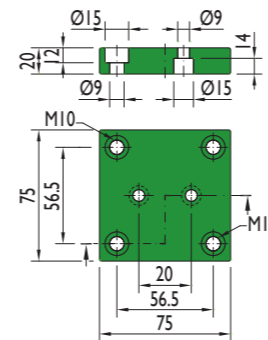

### BFI-750

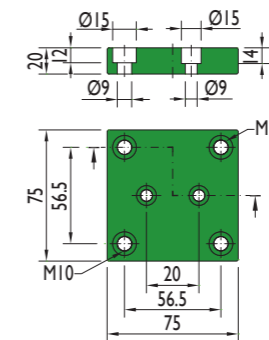

### MC-1500

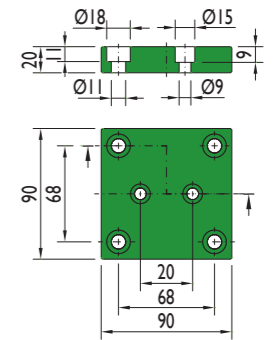

### MT-1500

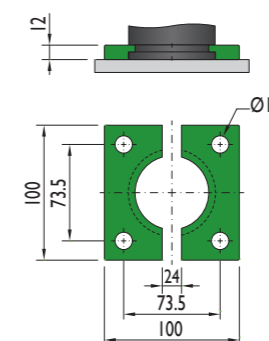

### AT-1500

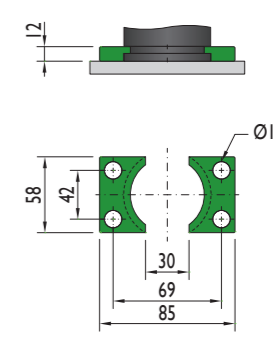

### XS-1000

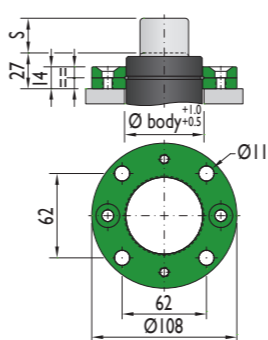

### XCV-1500

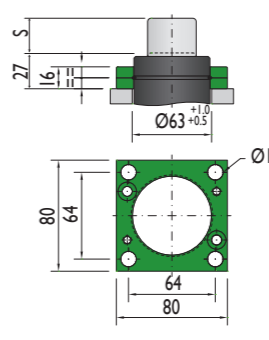

### XCK-1500

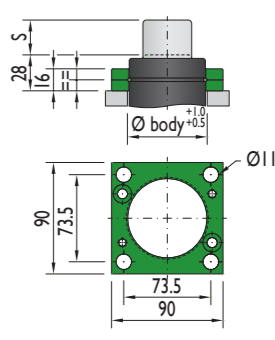

### CF-1000

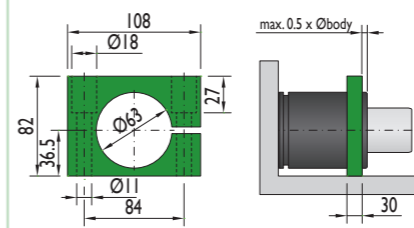

Flange must not support spring's force

Special mounts available on  
[www.nitrogas.com](http://www.nitrogas.com)

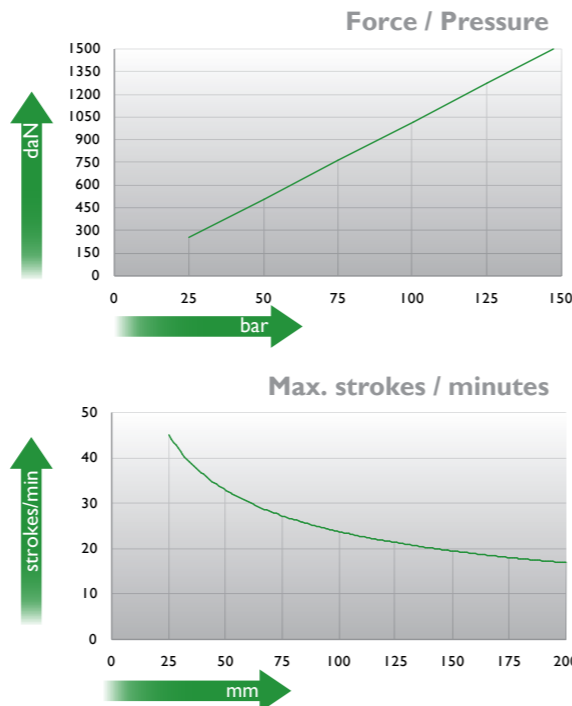
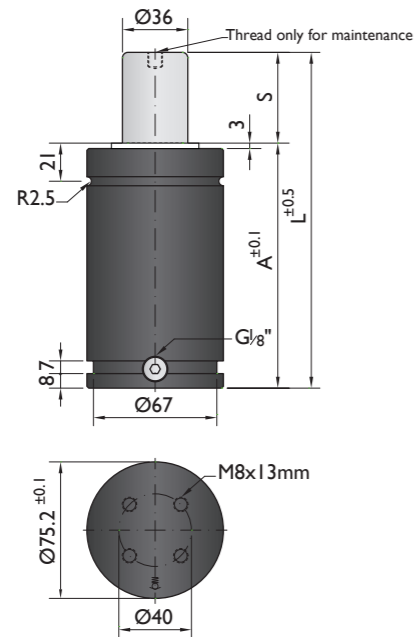

Ordering example: 4 x HG-1500-125

Order No.	S <sup>(1)</sup> mm	L mm	A mm	F <sub>0</sub> <sup>(2)</sup> daN (20°C, 150 bar)	F daN	<sup>(3)</sup>	kg
HG-1500-25	25	135	110	1500	1900	No	2.95
HG-1500-38	37.5	160	122.5		2000	No	3.18
HG-1500-50	50	185	135		2000	No	3.41
HG-1500-63	62.5	210	147.5		2000	No	3.64
HG-1500-80	80	245	165		2100	Yes	3.95
HG-1500-100	100	285	185		2100	Yes	4.33
HG-1500-125	125	335	210		2100	Yes	4.78
HG-1500-160	160	405	245		2200	Yes	5.43
HG-1500-200	200	485	285		2200	Yes	6.15

<sup>(1)</sup> other strokes under request

<sup>(2)</sup> alternative forces upon request

<sup>(3)</sup> ESK available for other strokes



Pressure medium	N <sub>2</sub>	Working temperature	0-80°C	Min. security stroke	10%
Max. Charging pressure	150 bar	Temperature related force increase	+0.34%/°C	Repair Kit	KIT HG-1500
Min. Charging pressure	25 bar	Max. working speed	1.6 m/s	Linkable	G1/8"

### Mounting possibilities

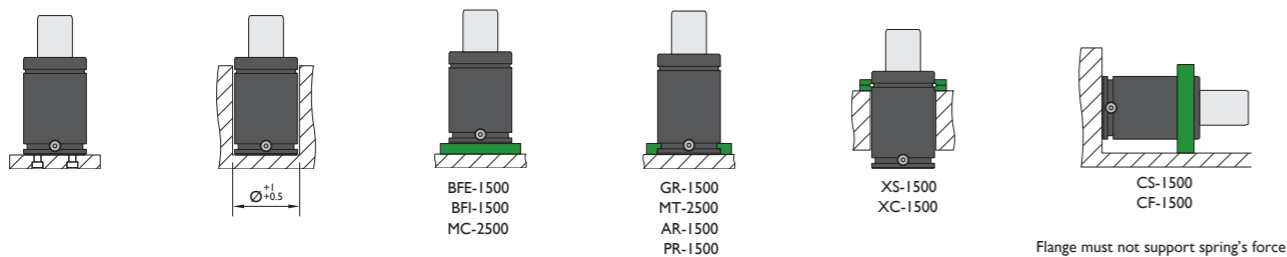

## Flanges

### BFE-1500

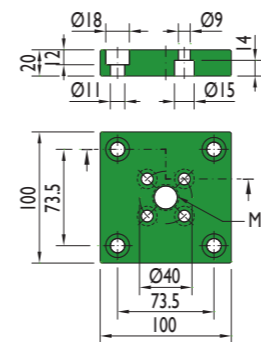

### BFI-1500

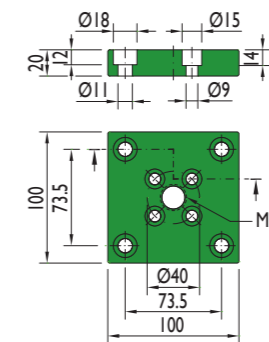

### MC-2500

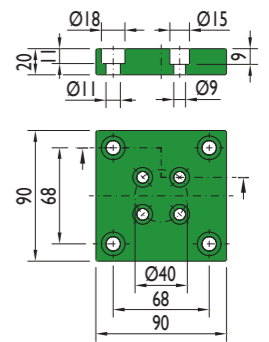

### GR-1500

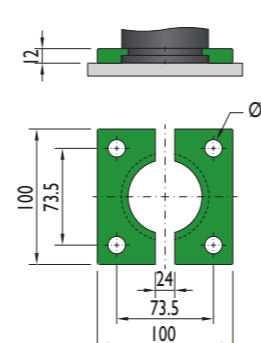

### MT-2500

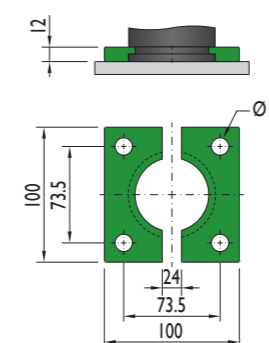

### AR-1500

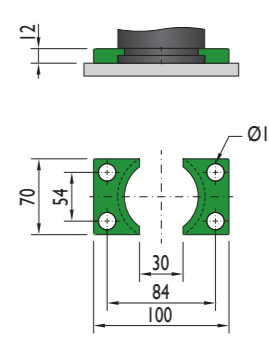

### XS-1500

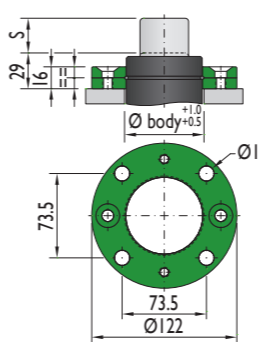

### XC-1500

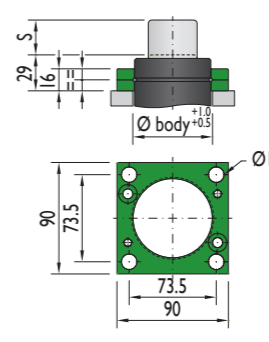

### PR-1500

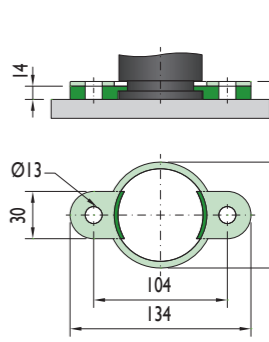

### CS-1500

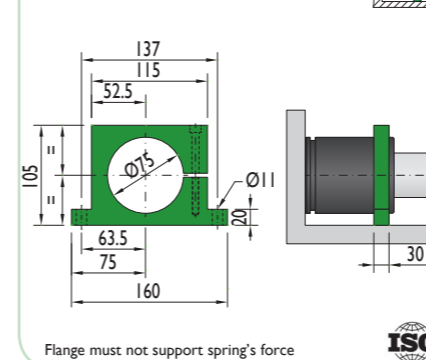

### CF-1500

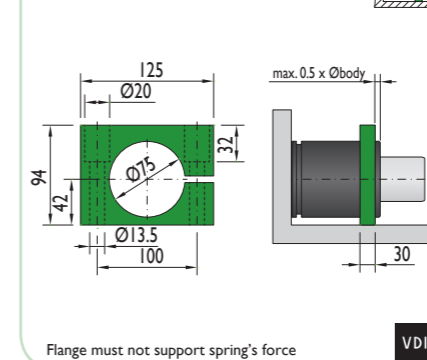



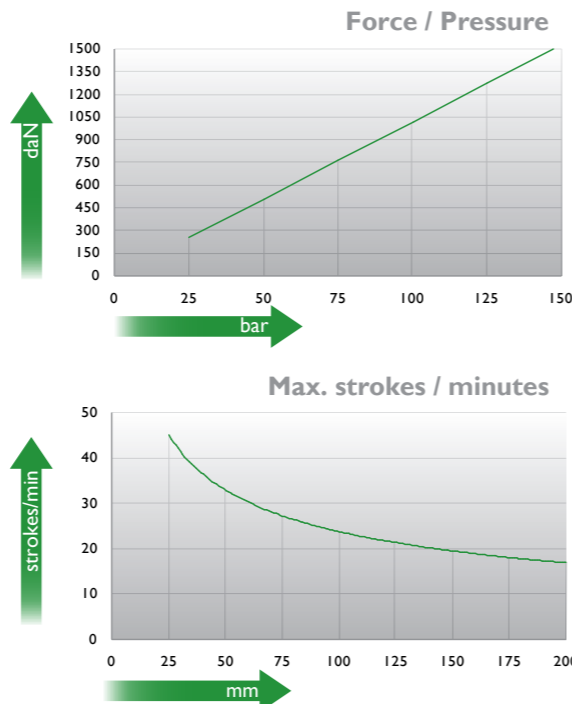
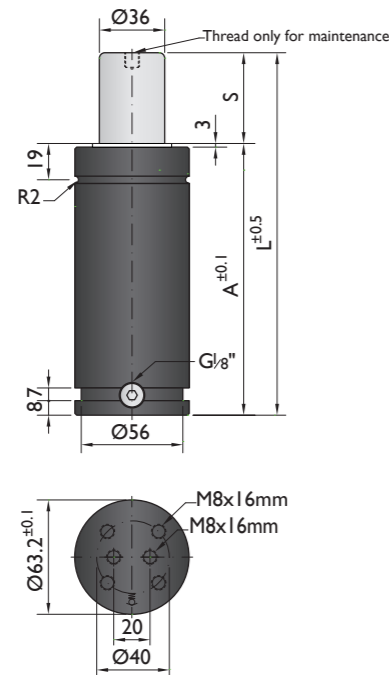

Ordering example: 4 x HD-1500-125

Order No.	S <sup>(1)</sup> mm	L mm	A mm	F <sub>0</sub> <sup>(2)</sup> daN (20°C, 150 bar)	F daN	(3)	kg
HD-1500-25	25	145	120	1500	2000	No	1.89
HD-1500-38	38	171	133		2000	No	2.16
HD-1500-50	50	195	145		2100	No	2.26
HD-1500-63	63	221	158		2200	No	2.51
HD-1500-80	80	255	175		2300	Yes	2.59
HD-1500-100	100	295	195		2300	Yes	2.86
HD-1500-125	125	345	220		2400	Yes	3.33
HD-1500-160	160	415	255		2400	Yes	3.78
HD-1500-200	200	495	295		2400	Yes	4.23
HD-1500-250	250	595	345		2500	Yes	4.80
HD-1500-300	300	695	395	2500	Yes	5.38	

other strokes<sup>(1)</sup> under request

alternative forces<sup>(2)</sup> upon request

ESK available for other strokes<sup>(3)</sup>



Pressure medium	N <sub>2</sub>	Working temperature	0-80°C	Min. security stroke	10%
Max. Charging pressure	150 bar	Temperature related force increase	+0.34%/°C	Repair Kit	KIT HD-1500
Min. Charging pressure	25 bar	Max. working speed	1.6 m/s	Linkable	G1/8"

### Mounting possibilities

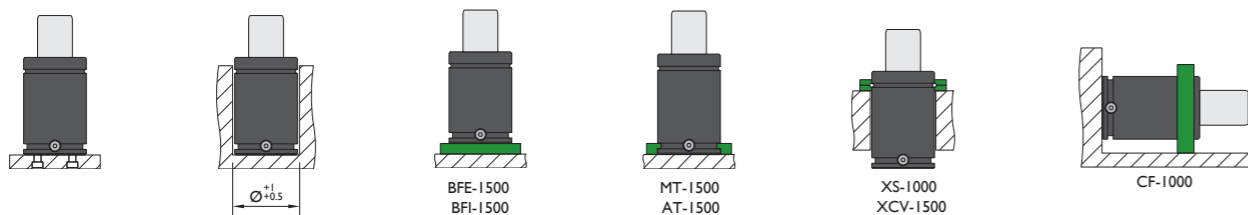

Flange must not support spring's force

## Flanges

### BFE-1500

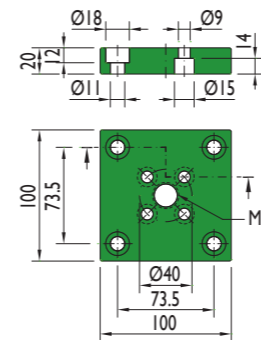

### BFI-1500

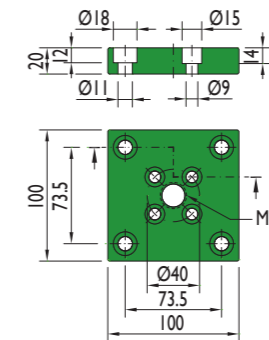

### MC-2500

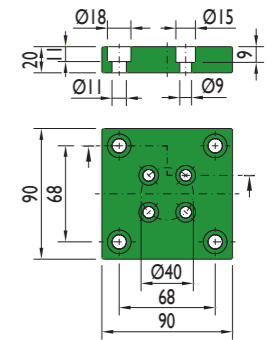

### MT-1500

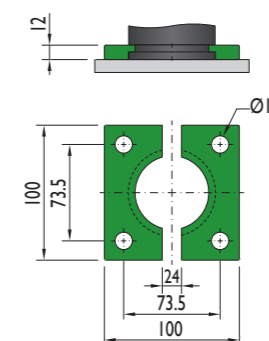

### AT-1500

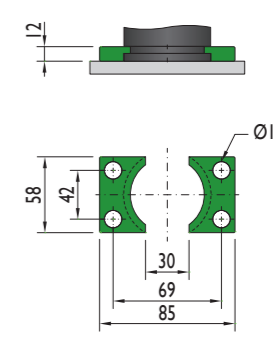

### XS-1000

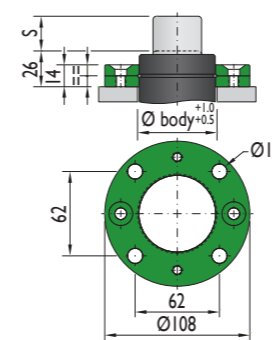

### XCV-1500

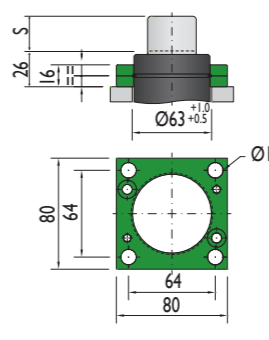

### XCK-1500

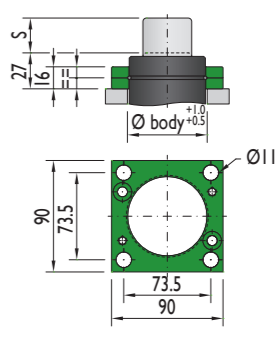

### CF-1000

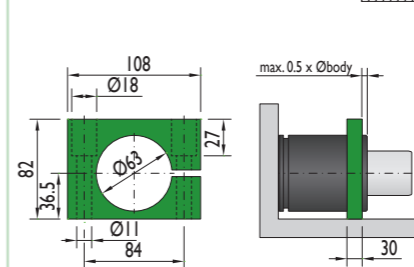

Flange must not support spring's force



CNOMO  
EM24.54.700

PSA  
E24.54.815.G

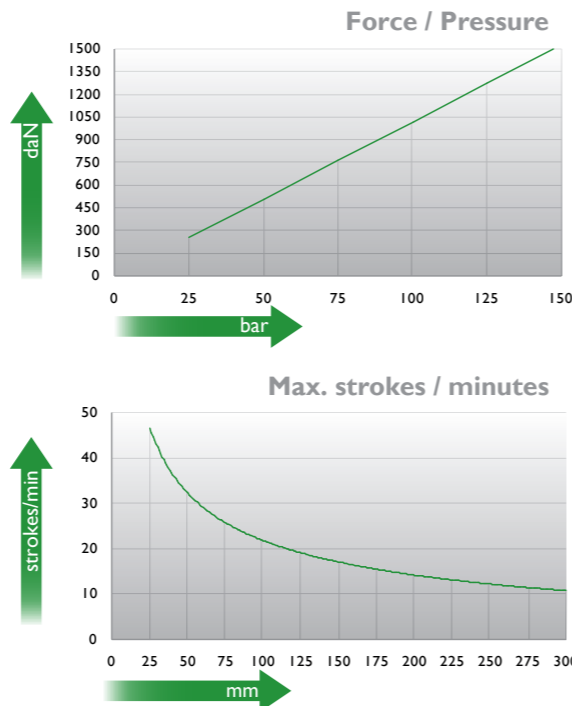
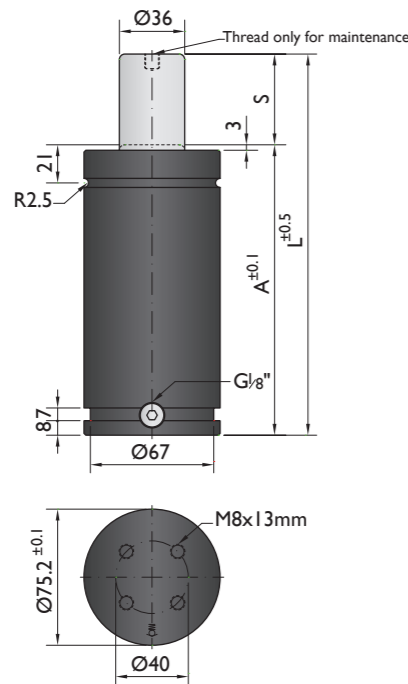

Ordering example: 4 x G-1500-125

Order No.	S <sup>(1)</sup> mm	L mm	A mm	F <sub>0</sub> <sup>(2)</sup> daN	F daN	(3)	kg
G-1500-25	25	160	135		1800	No	3.48
G-1500-38	38.1	186.2	148.1		1900	No	3.71
G-1500-50	50	210	160		2000	No	4.05
G-1500-63	63.5	237	173.5		2000	No	4.28
G-1500-80	80	270	190		2000	No	4.37
G-1500-100	100	310	210	1500	2000	Yes	4.44
G-1500-125	125	360	235		2100	Yes	4.87
G-1500-160	160	430	270		2100	Yes	5.29
G-1500-200	200	510	310		2100	Yes	6.75
G-1500-250	250	610	360		2100	Yes	7.62
G-1500-300	300	710	410		2100	Yes	8.48

(1) other strokes under request

(2) alternative forces upon request

(3) ESK available for other strokes



Pressure medium	N <sub>2</sub>	Working temperature	0-80°C	Min. security stroke	10%
Max. Charging pressure	150 bar	Temperature related force increase	+0.34%/°C	Repair Kit	KIT G-1500
Min. Charging pressure	25 bar	Max. working speed	1.6 m/s	Linkable	G1/8"

### Mounting possibilities

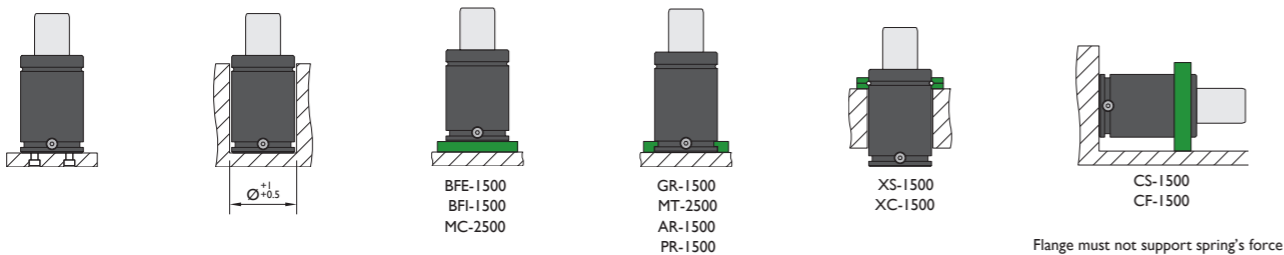

## Flanges

### BFE-1500

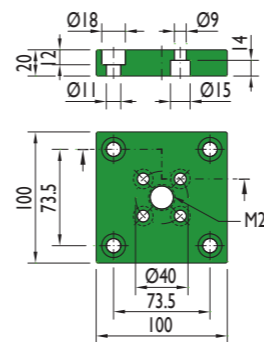

### BFI-1500

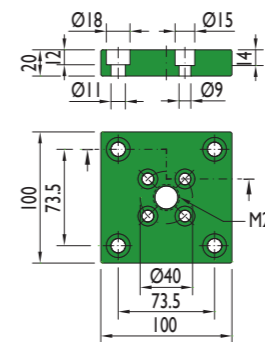

### MC-2500

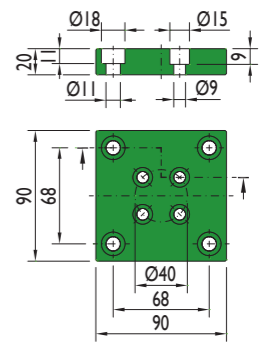

### GR-1500

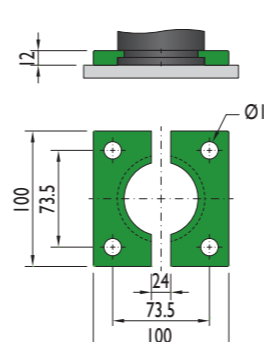

### MT-2500

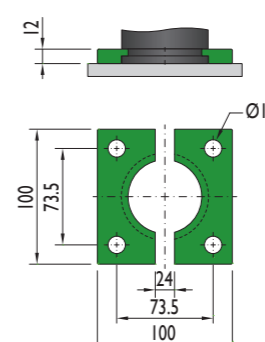

### AR-1500

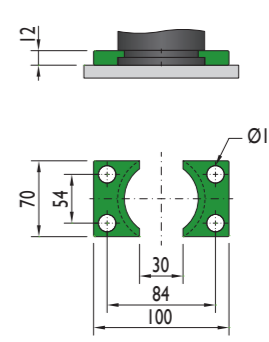

### XS-1500

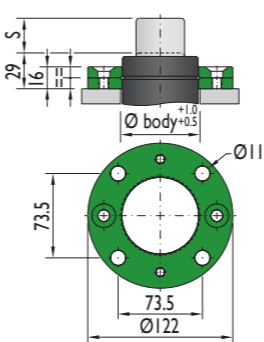

### XC-1500

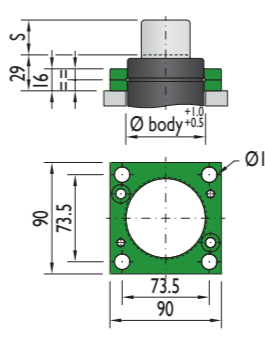

### PR-1500

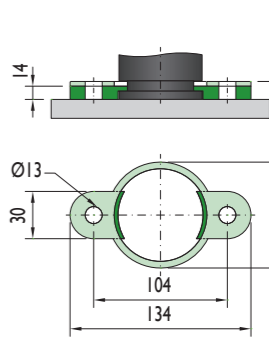

### CS-1500

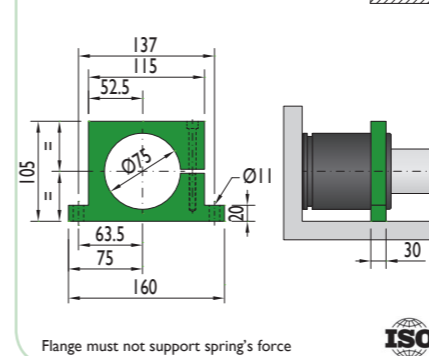

### CF-1500

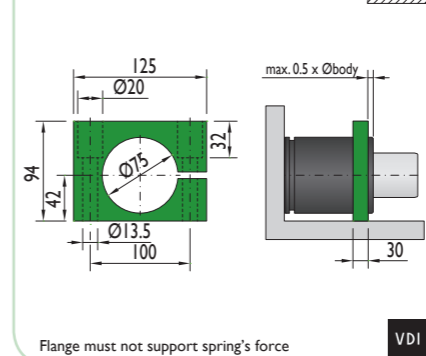

Special mounts available on  
[www.nitrogas.com](http://www.nitrogas.com)

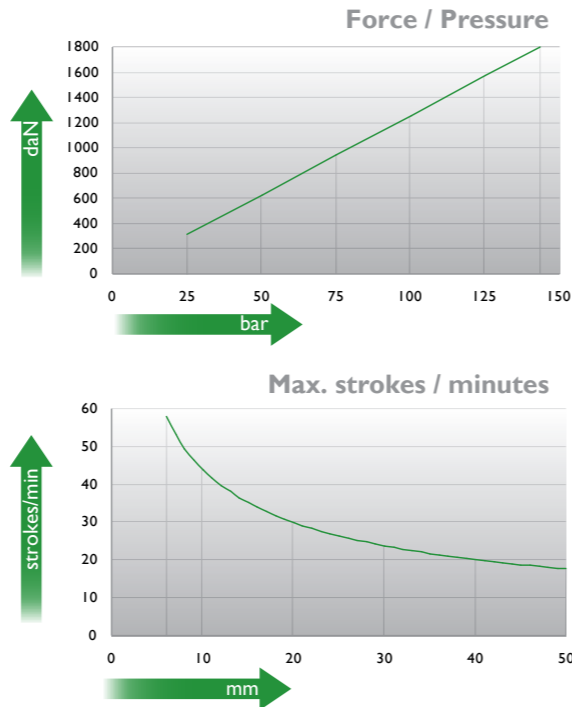
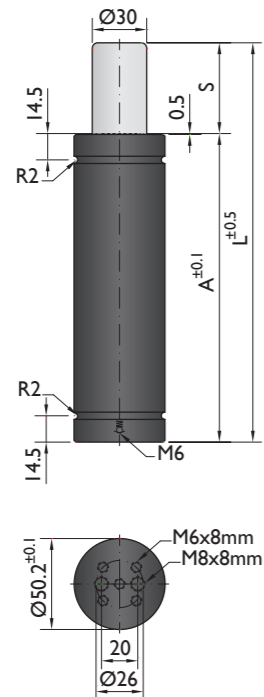

Ordering example: 4 x T-1800-50

Order No.	S <sup>(1)</sup> mm	L mm	A mm	F <sub>0</sub> <sup>(2)</sup> daN (20°C, 145 bar)	F daN	<sup>(3)</sup>	kg
T-1800-6	6	66	60	1800	2400	No	0.63
T-1800-10	10	80	70		2700	No	0.74
T-1800-16	16	106	90		2700	No	0.89
T-1800-25	25	135	110		2700	No	1.00
T-1800-32	32	162	130		2700	No	1.15
T-1800-40	40	190	150		2700	No	1.31
T-1800-50	50	220	170	2700	No	1.48	

<sup>(1)</sup> other strokes under request

<sup>(2)</sup> alternative forces upon request

<sup>(3)</sup> ESK under request



Pressure medium	N <sub>2</sub>	Working temperature	0-80°C	Min. security stroke	10%
Max. Charging pressure	145 bar	Temperature related force increase	+0.34%/°C	Repair Kit	KIT T-1800
Min. Charging pressure	25 bar	Max. working speed	0.5 m/s	Linkable	No

### Mounting possibilities

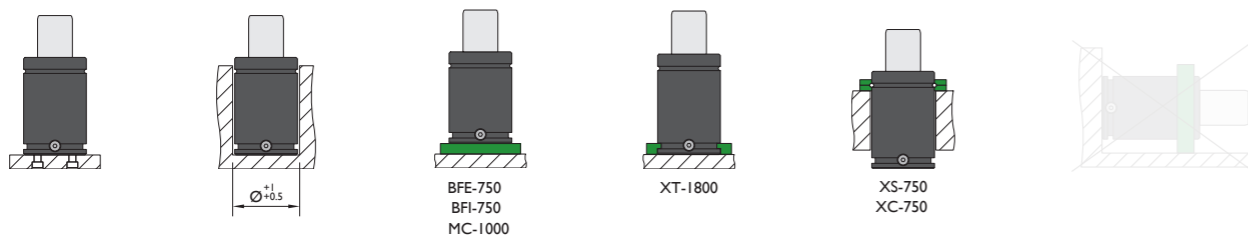

## Flanges

### BFE-750

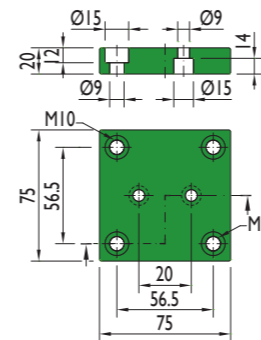

### BFI-750

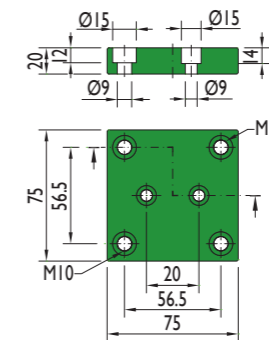

### MC-1000

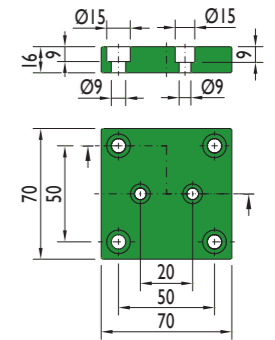

### XT-1800

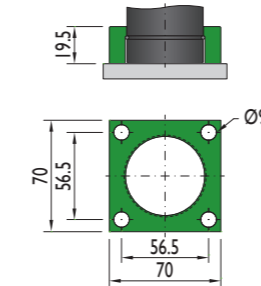

### XS-750

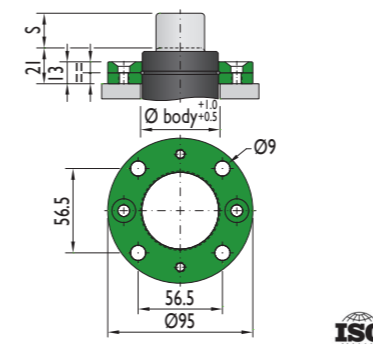

### XC-750

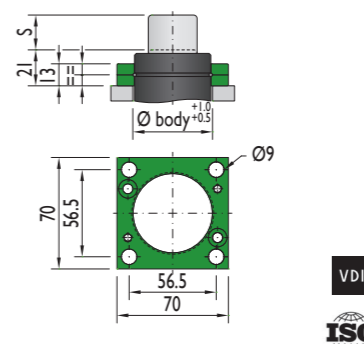

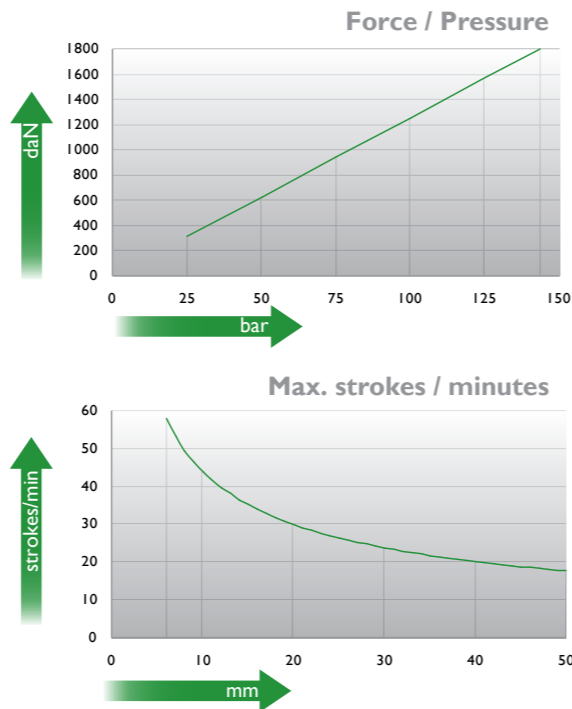
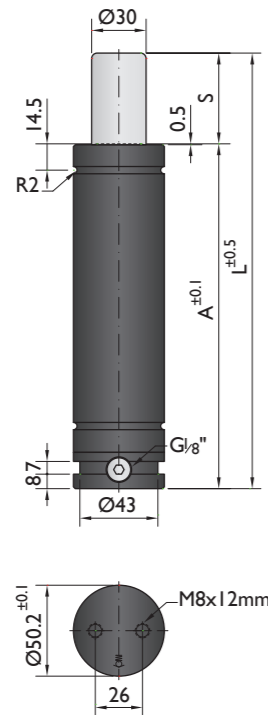

Ordering example: 4 x TC-1800-50

Order No.	S <sup>(1)</sup> mm	L mm	A mm	F <sub>0</sub> <sup>(2)</sup> daN (20°C, 145 bar)	F daN	<sup>(3)</sup> ESK	kg
TC-1800-6	6	86	80	1800	2400	No	0.87
TC-1800-10	10	100	90		2700	No	0.98
TC-1800-16	16	126	110		2700	No	1.13
TC-1800-25	25	155	130		2700	No	1.24
TC-1800-32	32	182	150		2700	No	1.39
TC-1800-40	40	210	170		2700	No	1.55
TC-1800-50	50	240	190	2700	No	1.72	

<sup>(1)</sup> other strokes under request

<sup>(2)</sup> alternative forces upon request

<sup>(3)</sup> ESK under request



Pressure medium	N <sub>2</sub>	Working temperature	0-80°C	Min. security stroke	10%
Max. Charging pressure	145 bar	Temperature related force increase	+0.34%/°C	Repair Kit	KIT TC-1800
Min. Charging pressure	25 bar	Max. working speed	0.5 m/s	Linkable	G1/8"

### Mounting possibilities

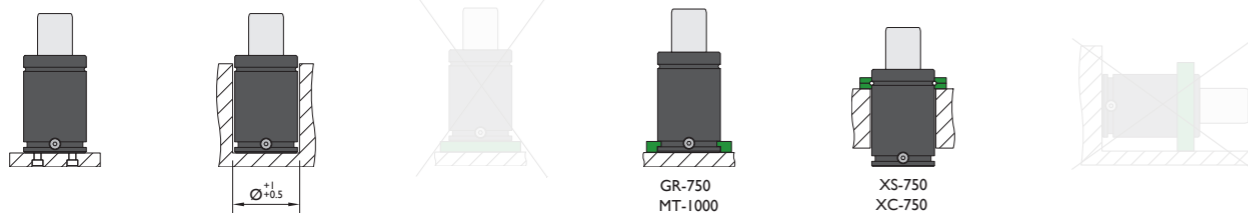

## Flanges

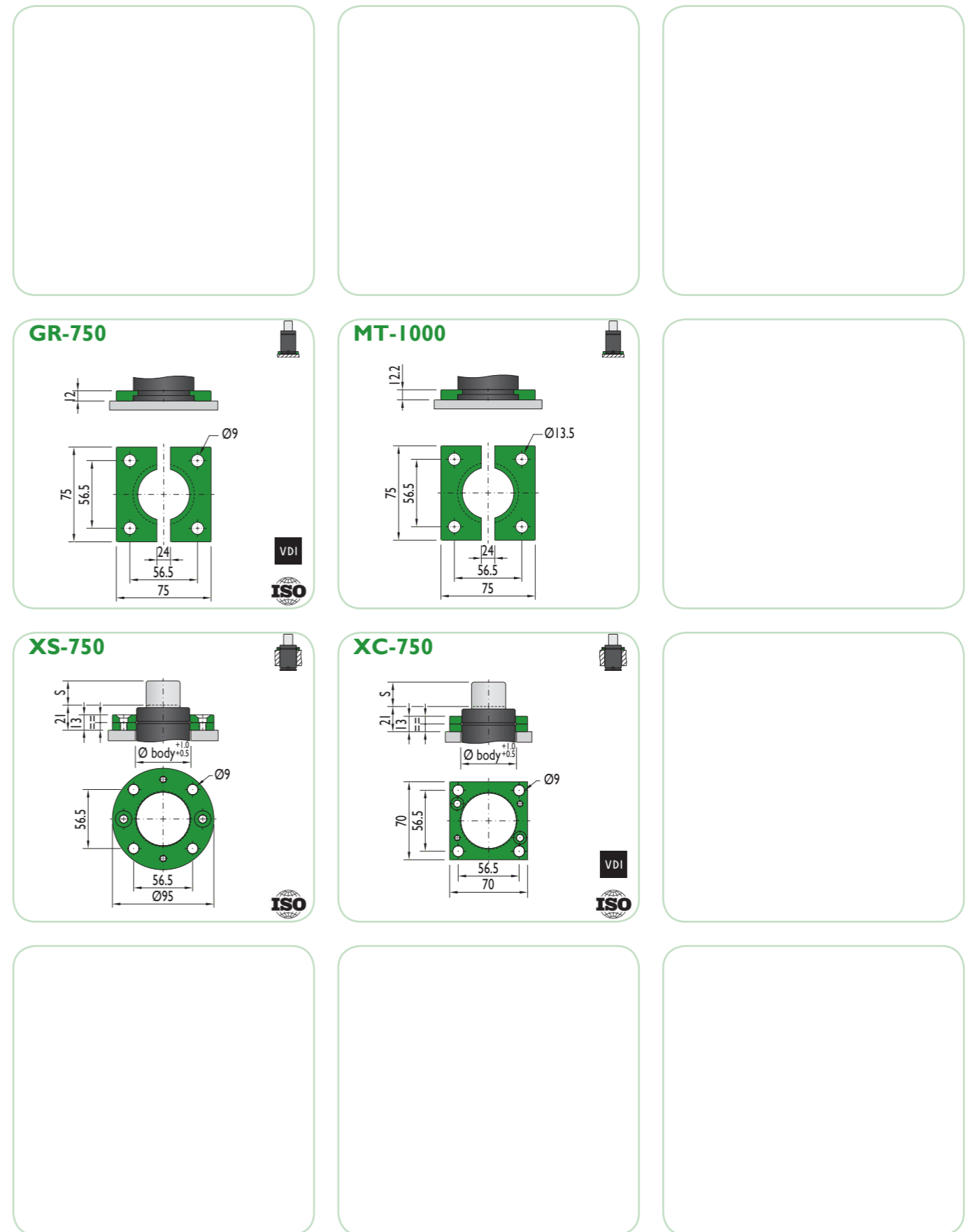

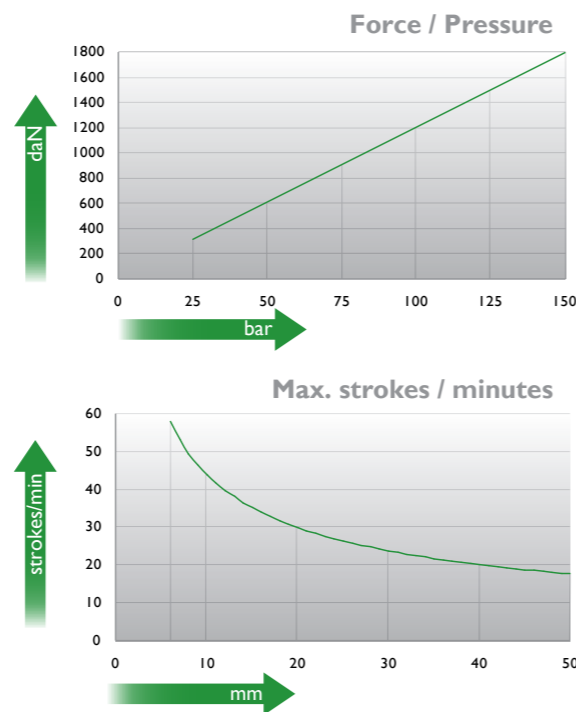
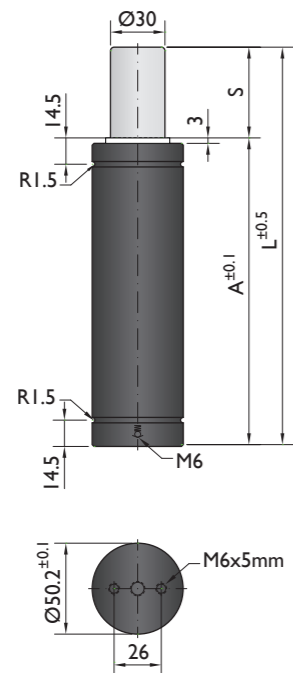

Ordering example: 4 x TS-1800-65

Order No.	S <sup>(1)</sup> mm	L mm	A mm	F <sub>0</sub> <sup>(2)</sup> daN	F daN	 <sup>(3)</sup>	kg
TS-1800-6	6	66	60	1800 (20°C, 150 bar)	2400	No	0.63
TS-1800-10	10	80	70		2700	No	0.74
TS-1800-16	16	106	90		2700	No	0.89
TS-1800-25	25	135	110		2700	No	1.00
TS-1800-32	32	162	130		2700	No	1.15
TS-1800-40	40	190	150		2700	No	1.31
TS-1800-50	50	220	170		2700	No	1.48
TS-1800-65	65	271	206		2700	No	1.58

<sup>(1)</sup> other strokes under request

<sup>(2)</sup> alternative forces upon request

<sup>(3)</sup> ESK under request



Pressure medium	N <sub>2</sub>	Working temperature	0-80°C	Min. security stroke	10%
Max. Charging pressure	150 bar	Temperature related force increase	+0.34%/°C	Repair Kit	KIT TS-1800
Min. Charging pressure	25 bar	Max. working speed	0.5 m/s	Linkable	No

### Mounting possibilities

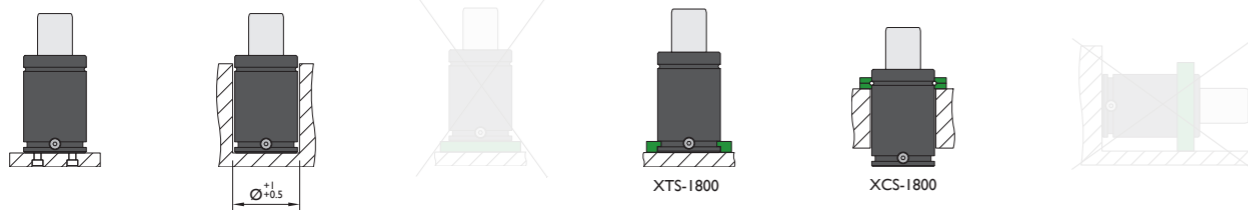

## Flanges

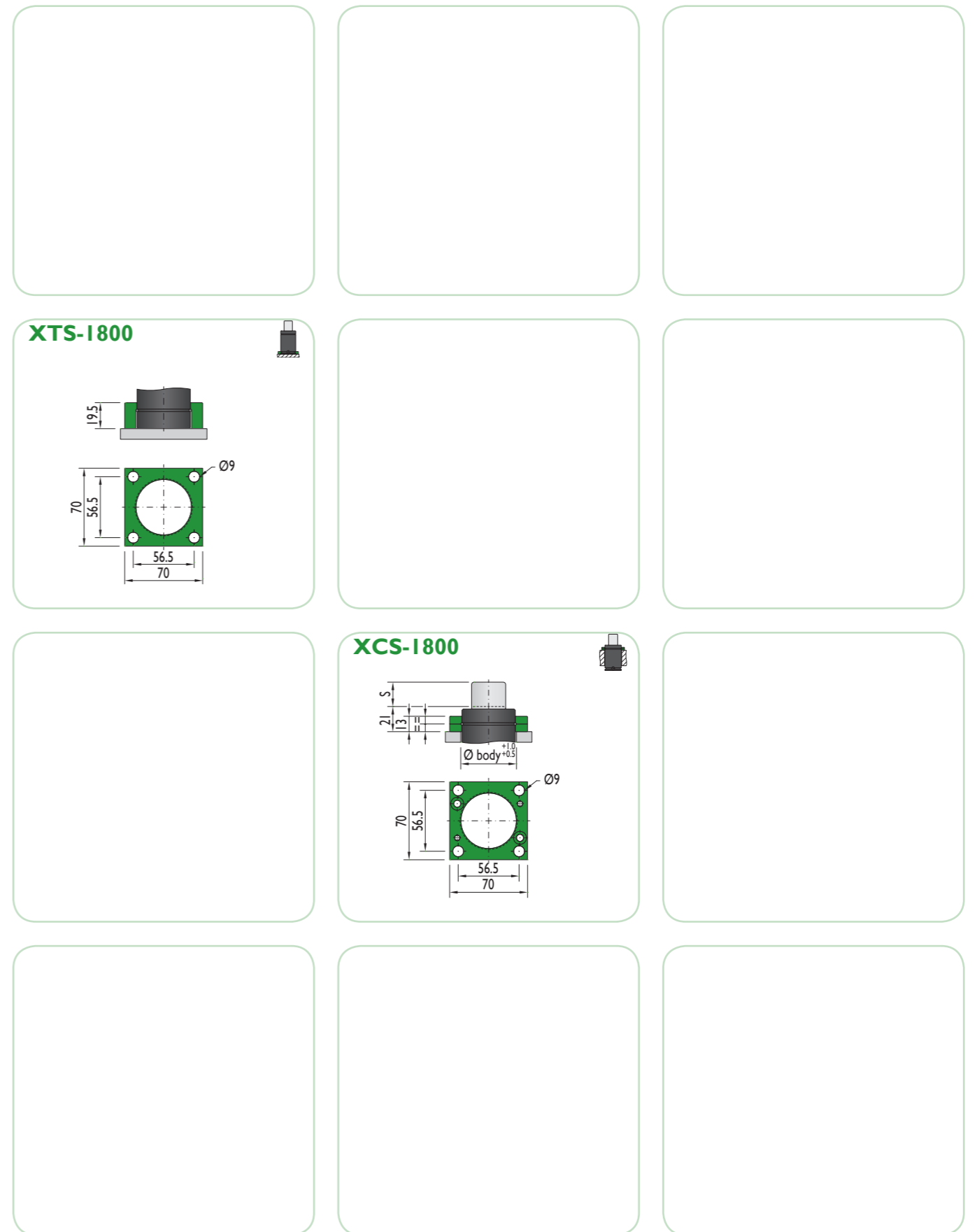



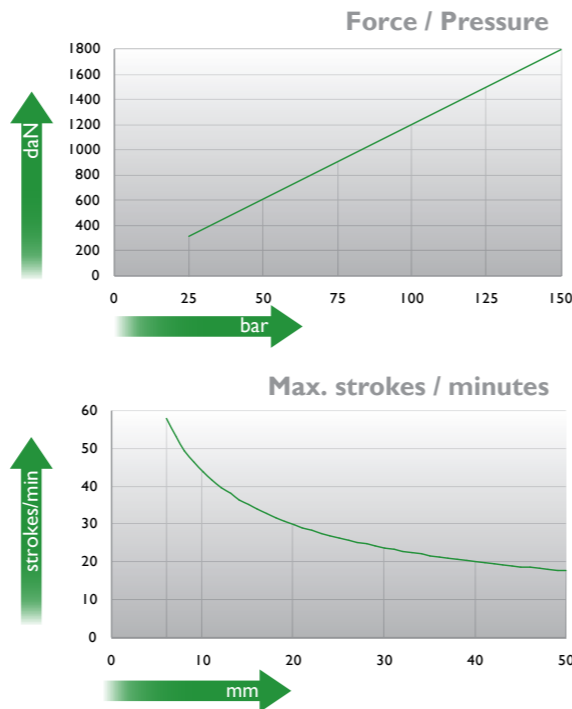
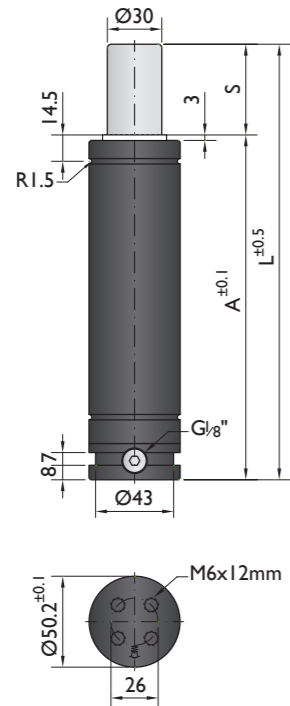

Ordering example: 4 x TSC-1800-65

Order No.	S <sup>(1)</sup> mm	L mm	A mm	F <sub>0</sub> <sup>(2)</sup> daN (20°C, 150 bar)	F daN	<sup>(3)</sup>	kg
TSC-1800-6	6	86	80	1800	2400	No	0.87
TSC-1800-10	10	100	90		2700	No	0.98
TSC-1800-16	16	126	110		2700	No	1.13
TSC-1800-25	25	155	130		2700	No	1.24
TSC-1800-32	32	182	150		2700	No	1.39
TSC-1800-40	40	210	170		2700	No	1.55
TSC-1800-50	50	240	190		2700	No	1.72
TSC-1800-65	65	291	226		2700	No	1.89

<sup>(1)</sup> other strokes under request

<sup>(2)</sup> alternative forces upon request

<sup>(3)</sup> ESK under request



Pressure medium	N <sub>2</sub>	Working temperature	0-80°C	Min. security stroke	10%
Max. Charging pressure	150 bar	Temperature related force increase	+0.34%/°C	Repair Kit	KIT TSC-1800
Min. Charging pressure	25 bar	Max. working speed	0.5 m/s	Linkable	G1/8"

### Mounting possibilities

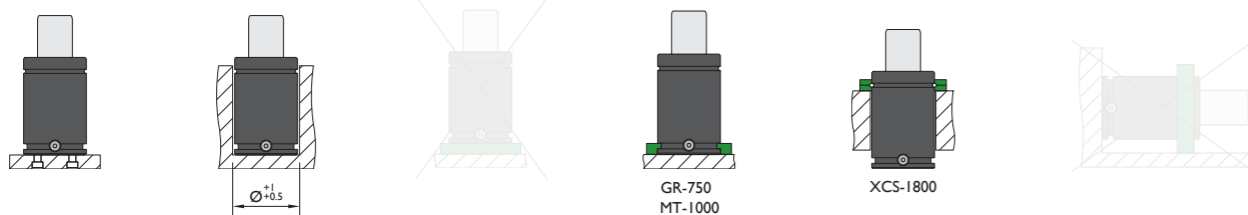

## Flanges

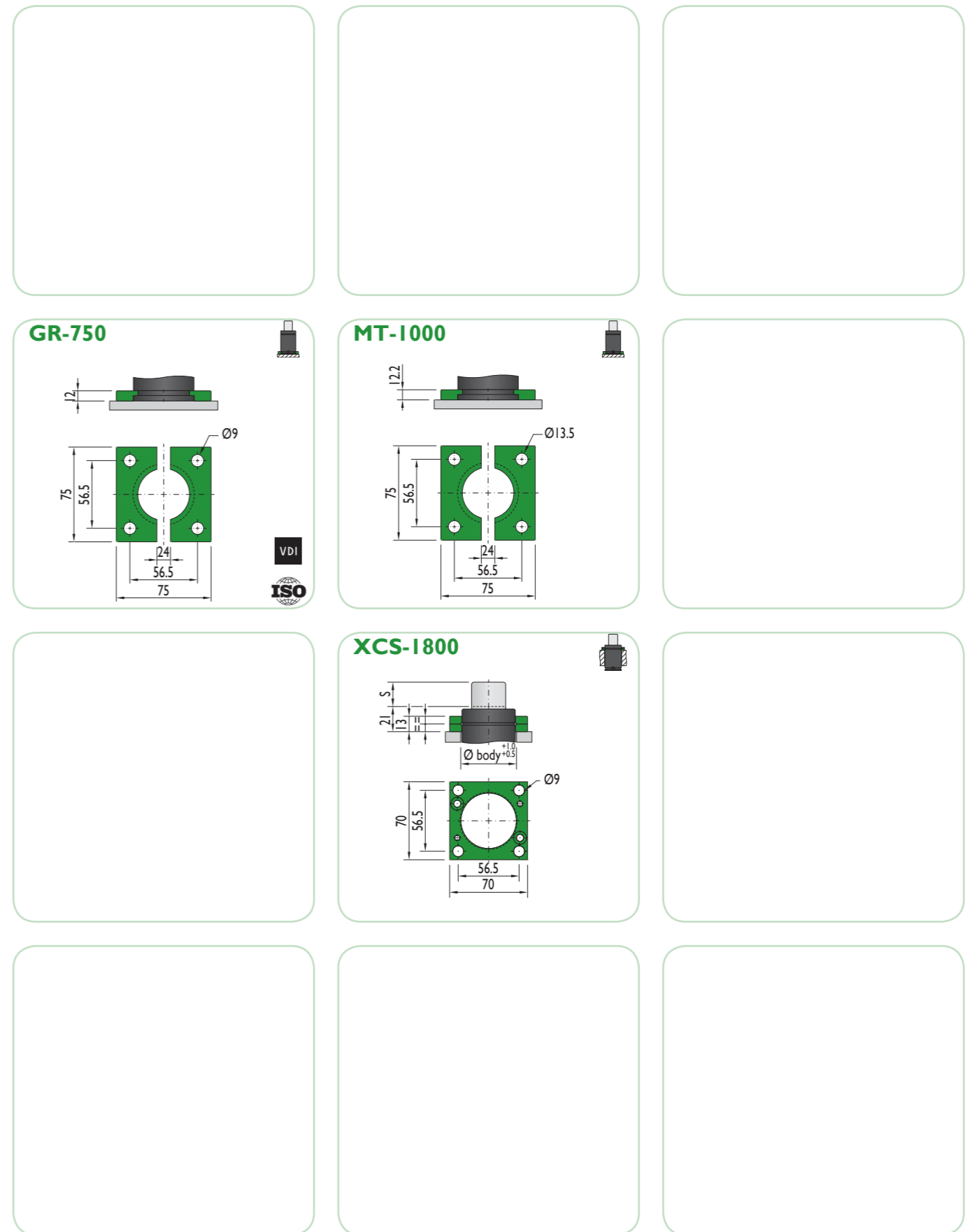

GR-750

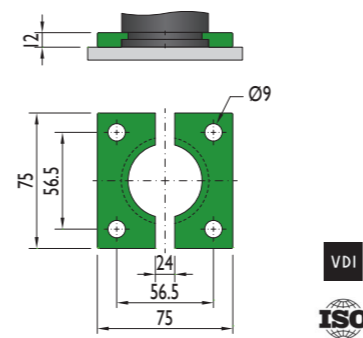

MT-1000

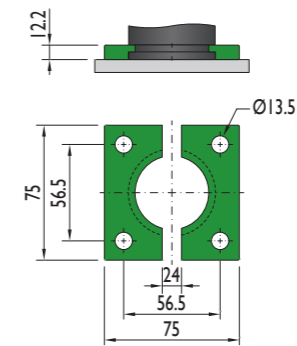

XCS-1800

