

Force 150 - 200 daN

Piston Rod Sealed
gas springs

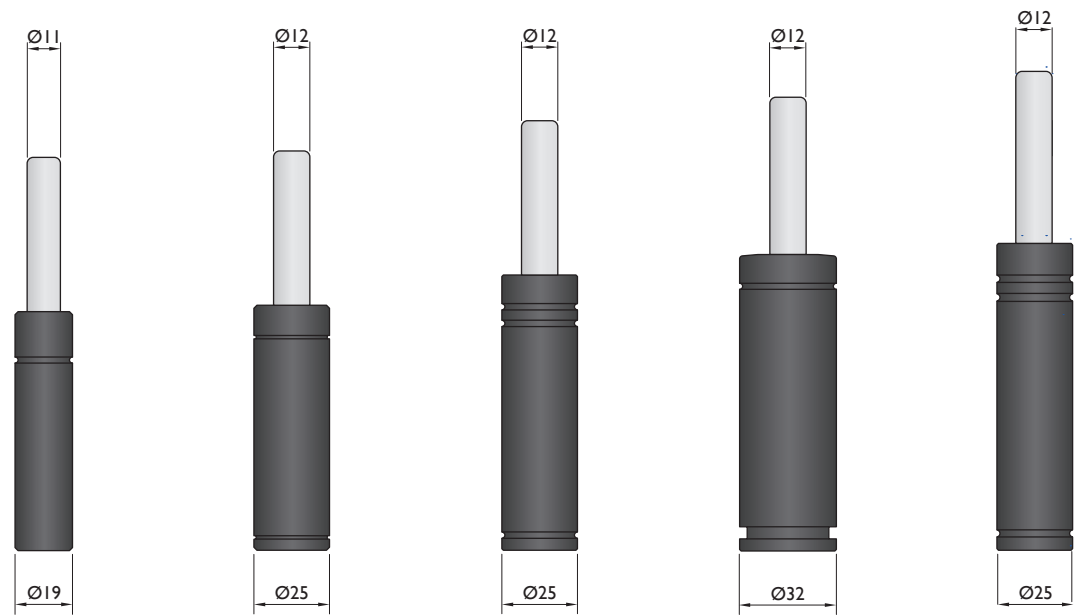
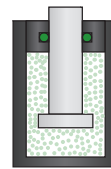

Model	KP-150	K-200	R-200	CN-150	G-200
Initial F (daN)	150	50-200	50-200	150	50-200
L max (mm)	2xStroke+30	2xStroke+32	2xStroke+42	2xStroke+50	2xStroke+54
Stroke (mm)	7-125	7-125	10-125	10-125	12-125

* other strokes under request

Standards

PED 97/23/EC	PED 97/23/EC	PED 97/23/EC	PED 97/23/EC	PED 97/23/EC
ISO 11901	ISO 11901	ISO 11901	ISO 11901	ISO 11901
VDI 3003	VDI 3003	VDI 3003	VDI 3003	VDI 3003
CNOMO EM24.54.700	CNOMO EM24.54.700	CNOMO EM24.54.700	CNOMO EM24.54.700	CNOMO EM24.54.700

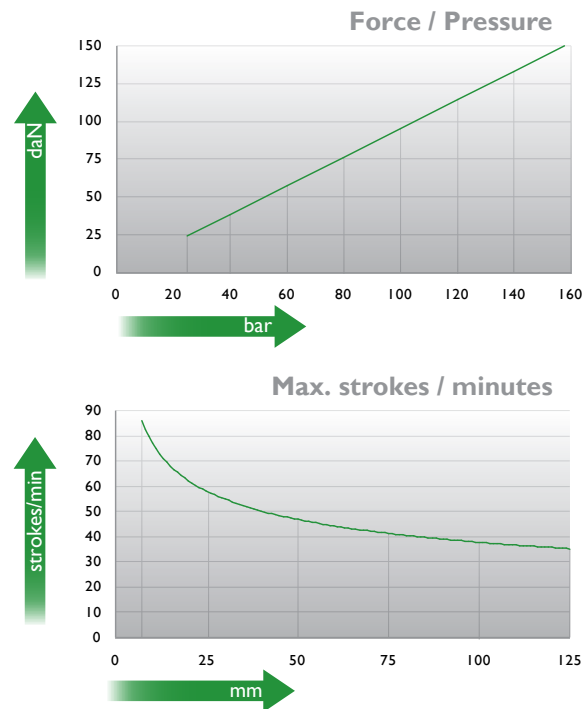
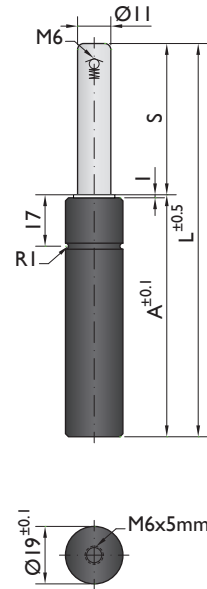

Ordering example: 4 x KP-150-125

Order No.	S ⁽¹⁾ mm	L mm	A mm	F ₀ ⁽²⁾ daN	F daN		kg
				(20°C, 160 bar)			
KP-150-7	7	44	37	150	240	No	0.05
KP-150-10	10	50	40	150	250	No	0.07
KP-150-15	15	60	45	150	280	No	0.07
KP-150-19	19	68	49	150	280	No	0.07
KP-150-25	25	80	55	150	280	No	0.09
KP-150-38	38	106	68	150	280	No	0.10
KP-150-50	50	130	80	150	280	No	0.12
KP-150-63	63	156	93	150	280	No	0.14
KP-150-75	75	185	110	150	280	No	0.15
KP-150-80	80	195	115	150	280	No	0.17
KP-150-100	100	235	135	150	280	No	0.20
KP-150-125	125	285	160	150	280	No	0.23

⁽¹⁾ other strokes under request

⁽²⁾ alternative forces upon request



Pressure medium	N ₂	Working temperature	0-80°C	Min. security stroke	10%
Max. Charging pressure	160 bar	Temperature related force increase	+0.34%/°C	Repair Kit	Non-repairable
Min. Charging pressure	25 bar	Max. working speed	1.6 m/s	Linkable	No

Mounting possibilities

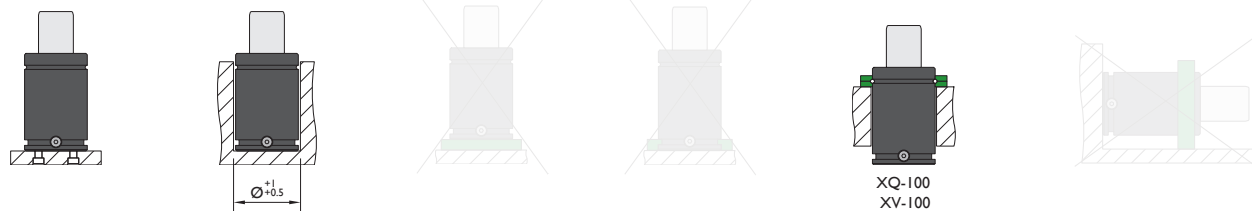

Flanges

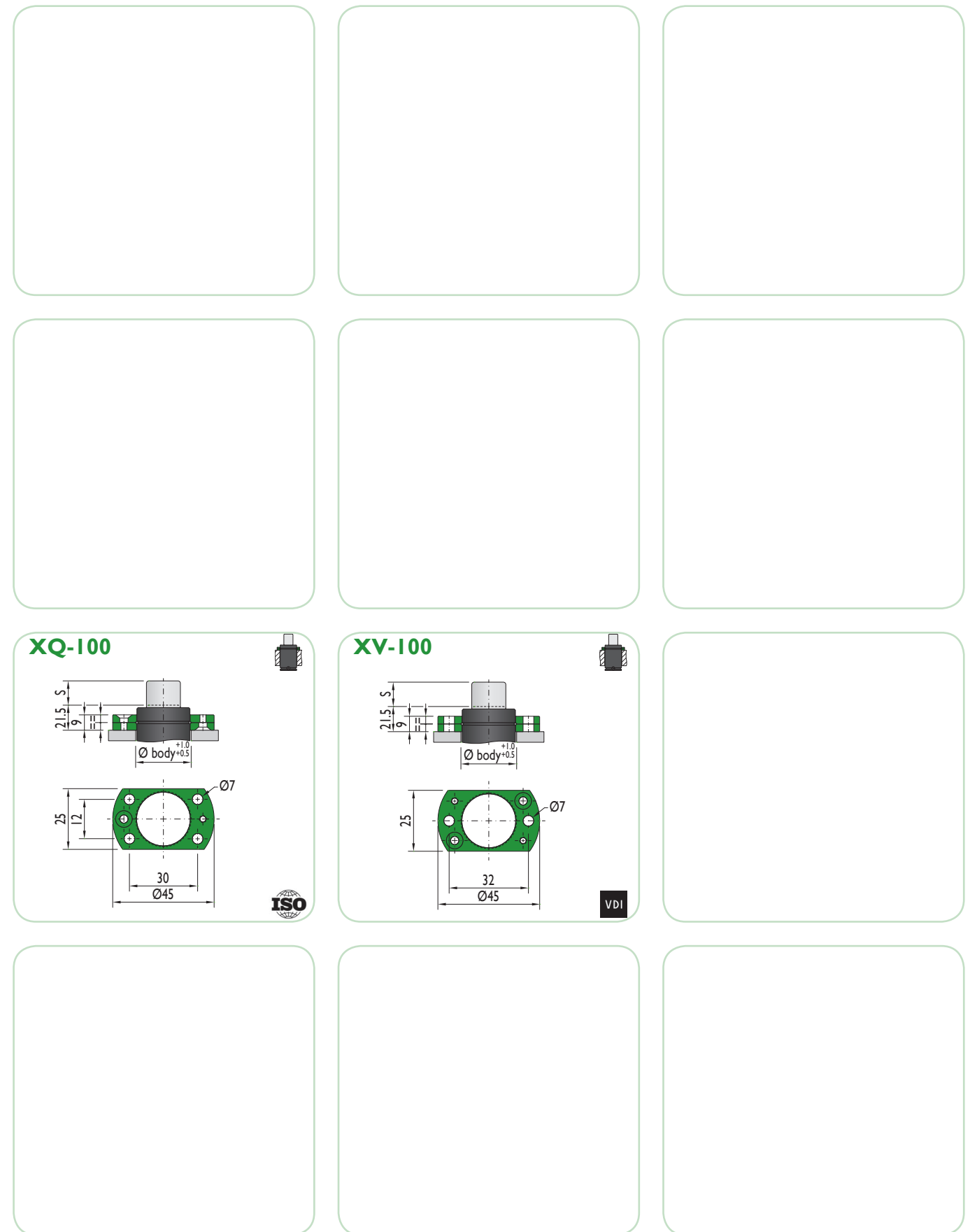

XQ-100

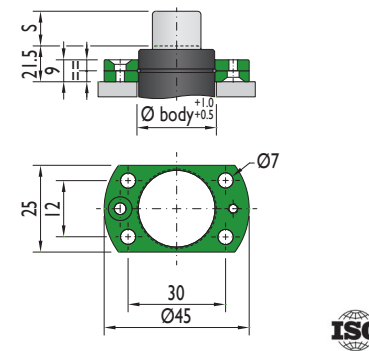

XV-100

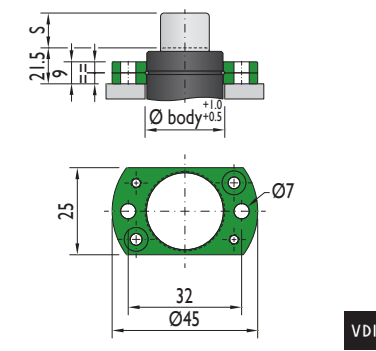

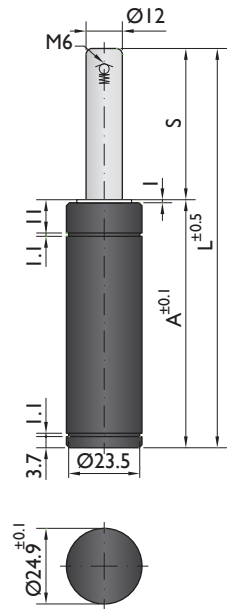

Force / Pressure

		daN	bar (20°C)
V	GREEN	50	45
Z	BLUE	100	90
R	RED	150	135
A	YELLOW	200	180

* maximum force if not specified

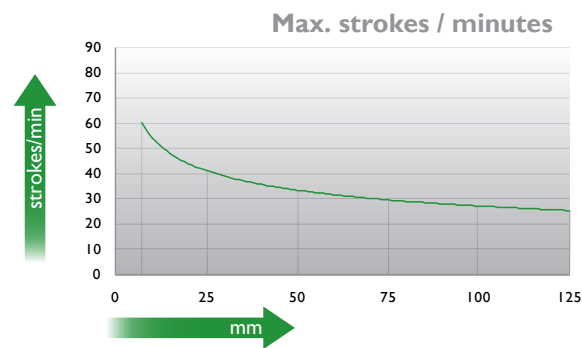

Ordering example: 4 x K-200-125 V

Order No.	S ⁽¹⁾ mm	L mm	A mm	F ₀ ⁽²⁾ daN (20°C, 180 bar)	F daN	kg
K-200-7	7	46	39	200	300	0.11
K-200-12	12	56	44		300	0.12
K-200-16	16	64	48		300	0.13
K-200-25	25	82	57		310	0.15
K-200-38	38	108	70		310	0.18
K-200-50	50	132	82		310	0.21
K-200-63	63	158	95		310	0.24
K-200-80	80	192	112		310	0.28
K-200-100	100	232	132		310	0.30
K-200-125	125	282	157		310	0.33

⁽¹⁾ other strokes under request

⁽²⁾ alternative forces upon request



Pressure medium	N ₂	Working temperature	0-80°C	Min. security stroke	10%
Max. Charging pressure	180 bar	Temperature related force increase	+0.34%/°C	Repair Kit	KIT K-200
Min. Charging pressure	25 bar	Max. working speed	1.6 m/s	Linkable	No

Mounting possibilities

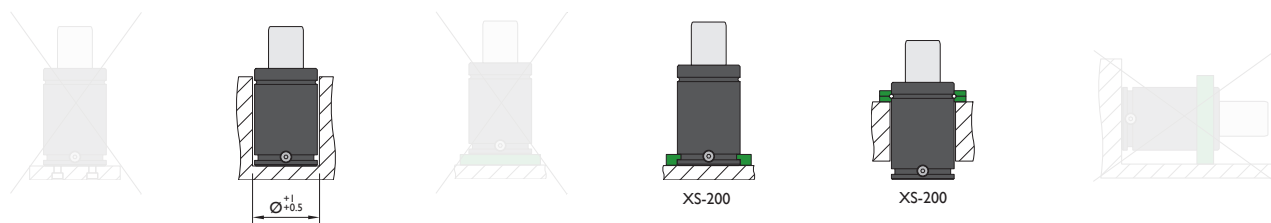

Flanges

XS-200

XS-200

Special mounts available on
www.nitrogas.com

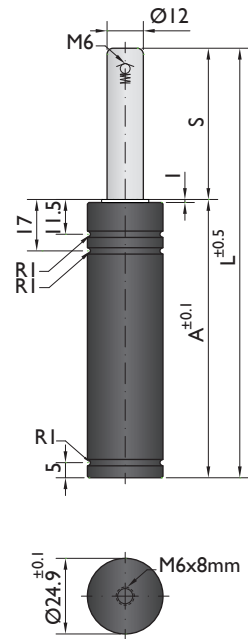

Force / Pressure

		daN	bar (20°C)
V	GREEN	50	45
Z	BLUE	100	90
R	RED	150	135
A	YELLOW	200	180

* maximum force if not specified

Max. strokes / minutes

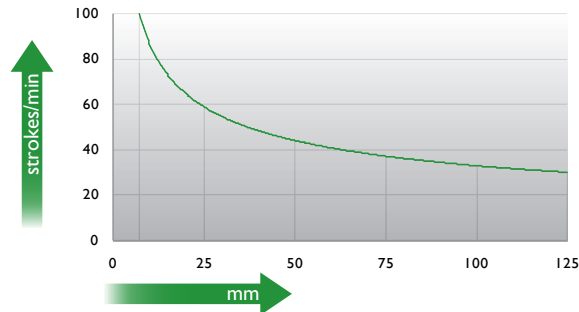

Ordering example: 4 x R-200-125 V

Order No.	S ⁽¹⁾ mm	L mm	A mm	F ₀ ⁽²⁾ daN (20°C, 180 bar)	F daN	kg
R-200-10	10	62	52		260	0.14
R-200-13	12.7	67.4	54.7		260	0.15
R-200-15	15	72	57		260	0.15
R-200-16	16	74	58		260	0.16
R-200-25	25	92	67		270	0.17
R-200-38	38.1	118.2	80.1	200	280	0.20
R-200-50	50	142	92		280	0.22
R-200-63	63.5	172	108.5		290	0.25
R-200-80	80	205	125		290	0.28
R-200-100	100	245	145		290	0.32
R-200-125	125	295	170		290	0.37

⁽¹⁾ other strokes under request

⁽²⁾ alternative forces upon request



Pressure medium	N ₂	Working temperature	0-80°C	Min. security stroke	10%
Max. Charging pressure	180 bar	Temperature related force increase	+0.34%/°C	Repair Kit	KIT R-200
Min. Charging pressure	25 bar	Max. working speed	1.6 m/s	Linkable	No

Mounting possibilities

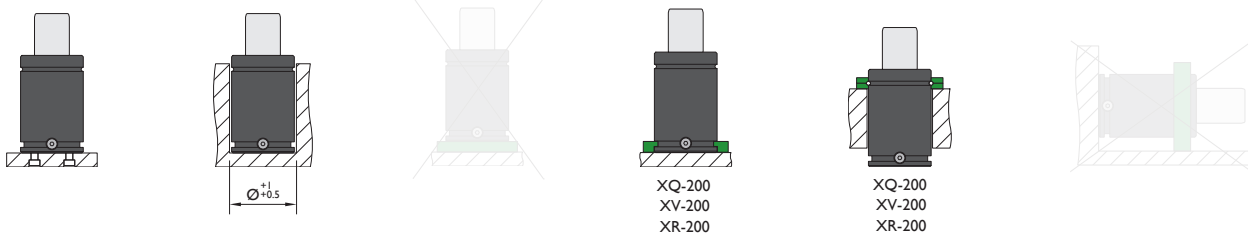

Flanges

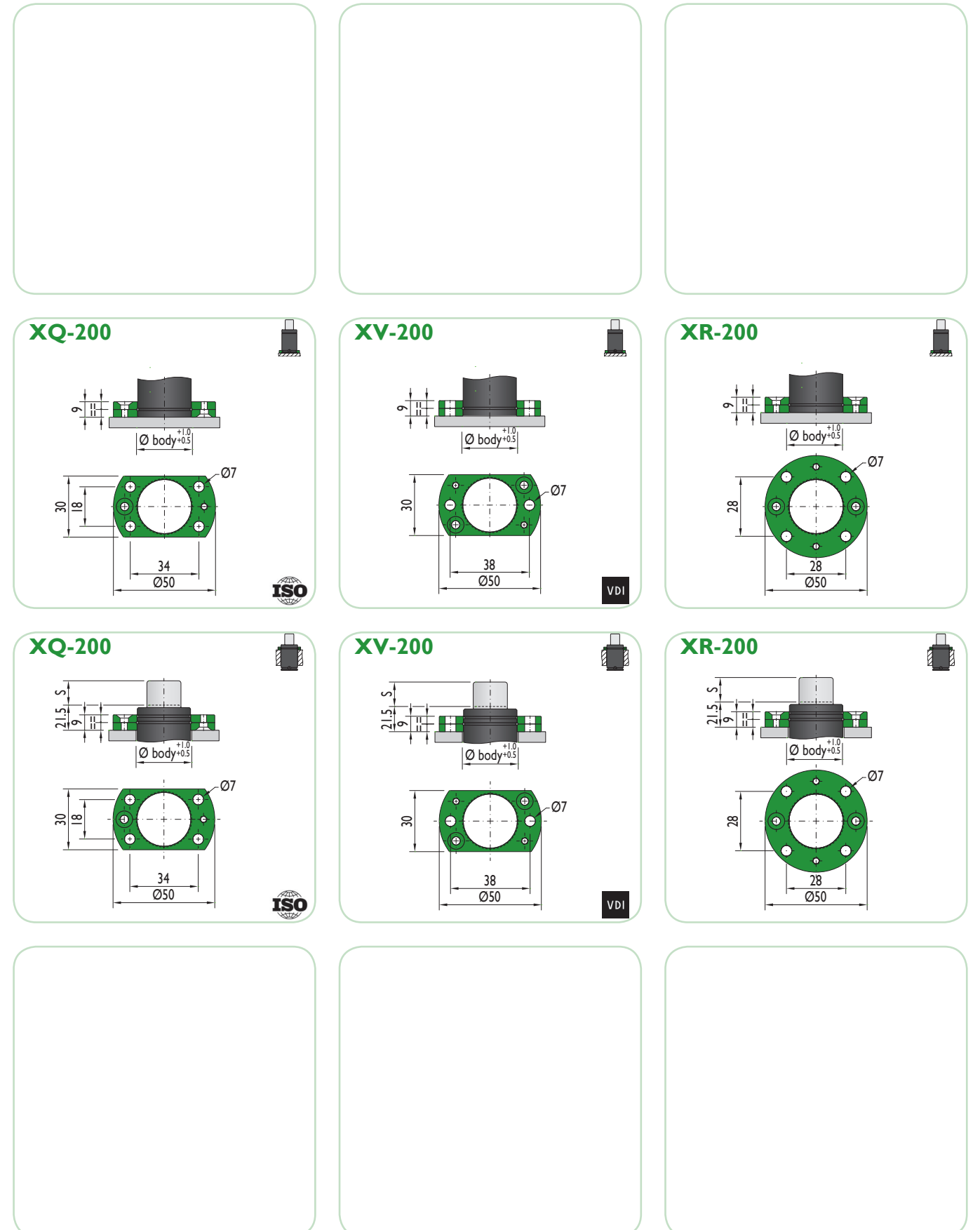



CNOMO
EM24.54.700

PSA
E24.54.815.G

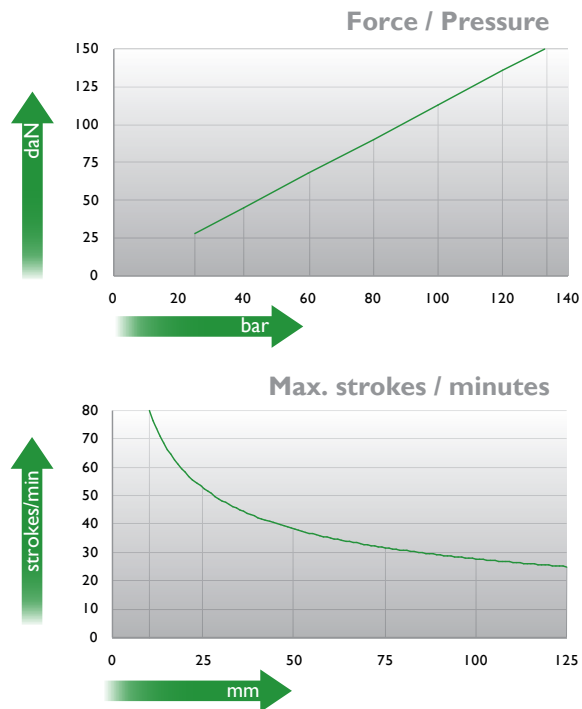
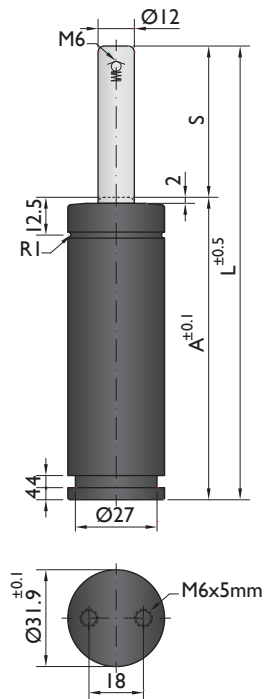

Ordering example: 4 x CN-150-125

Order No.	S ⁽¹⁾ mm	L mm	A mm	F ₀ ⁽²⁾ daN	F daN	kg
CN-150-10	10	70	60	170	No	0.27
CN-150-13	12.7	75.4	62.7	180	No	0.28
CN-150-16	16	82	66	180	No	0.29
CN-150-25	25	100	75	180	No	0.33
CN-150-38	38.1	126.2	88.1	180	No	0.38
CN-150-50	50	150	100	190	No	0.43
CN-150-63	63.5	177	113.5	200	No	0.48
CN-150-80	80	210	130	200	No	0.56
CN-150-100	100	250	150	200	No	0.64
CN-150-125	125	300	175	200	No	0.73

⁽¹⁾ other strokes under request

⁽²⁾ alternative forces upon request



Pressure medium	N ₂	Working temperature	0-80°C	Min. security stroke	10%
Max. Charging pressure	135 bar	Temperature related force increase	+0.34%/°C	Repair Kit	KIT CN-150
Min. Charging pressure	25 bar	Max. working speed	1.6 m/s	Linkable	No

Mounting possibilities

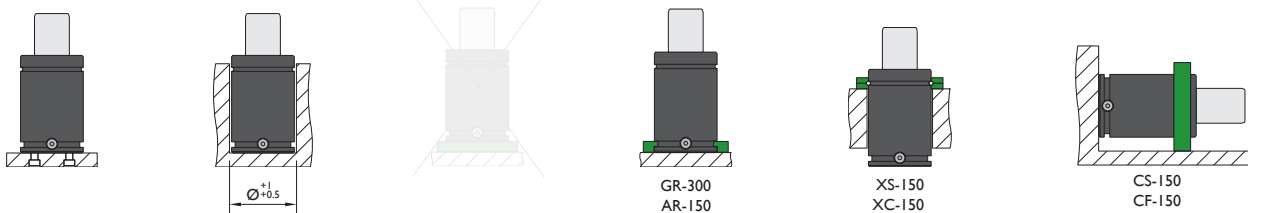

Flange must not support spring's force

Flanges

GR-300

AR-150

XS-150

XC-150

CS-150

CF-150

Flange must not support spring's force

Flange must not support spring's force



*The new cylinder will be supplied when the stock runs out.

NEW MODEL*

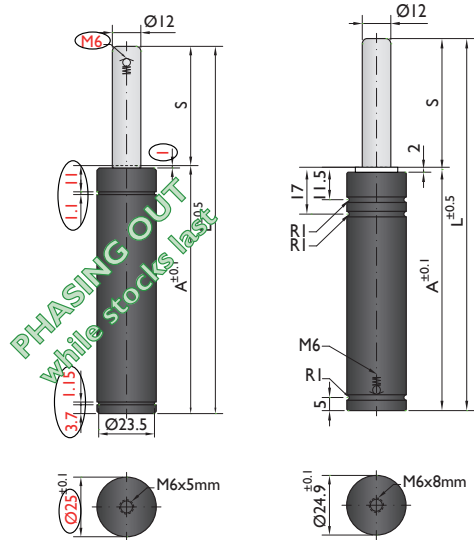

Force / Pressure

	daN	bar (20°C)
V GREEN	50	45
Z BLUE	100	90
R RED	150	135
A YELLOW	200	180

* maximum force if not specified

Max. strokes / minutes

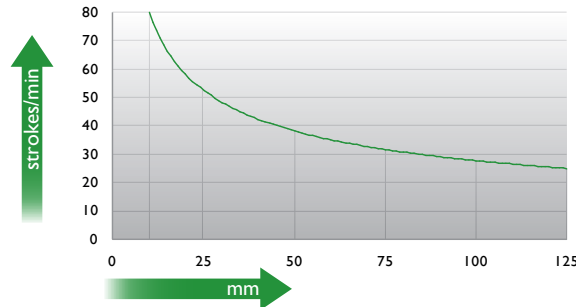

Ordering example: 4 x G-200-80 Z

Order No.	S ⁽¹⁾ mm	L mm	A mm	F ₀ ⁽²⁾ daN (20°C, 180 bar)	F daN	kg
G-200-12	12	78	66	200	230	0.16
G-200-25	25	104	79		250	0.19
G-200-38	38	130	92		260	0.22
G-200-50	50	154	104		270	0.25
G-200-63	63	180	117		290	0.29
G-200-80	80	214	134		290	0.33
G-200-100 (*)	100	254	145		310	0.36
G-200-125 (*)	125	304	170		310	0.42

(1) other strokes under request

(2) alternative forces upon request

* New version length



Pressure medium	N ₂	Working temperature	0-80°C	Min. security stroke	10%
Max. Charging pressure	180 bar	Temperature related force increase	+0.34%/°C	Repair Kit	KIT G-200
Min. Charging pressure	25 bar	Max. working speed	1.6 m/s	Linkable	No

Mounting possibilities

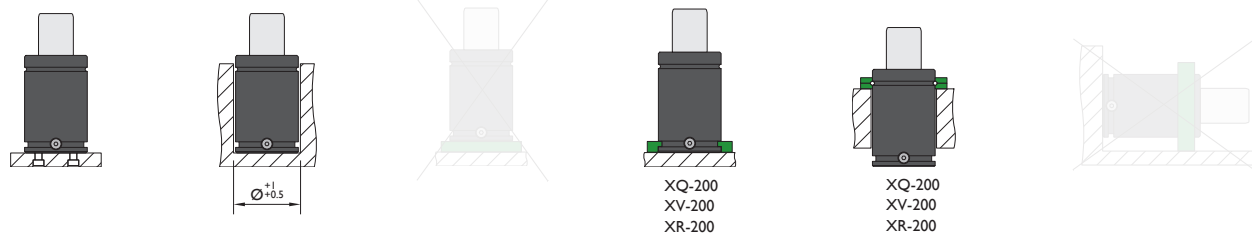

Flanges