

## Force 250 - 300 daN

### Piston Rod Sealed gas springs

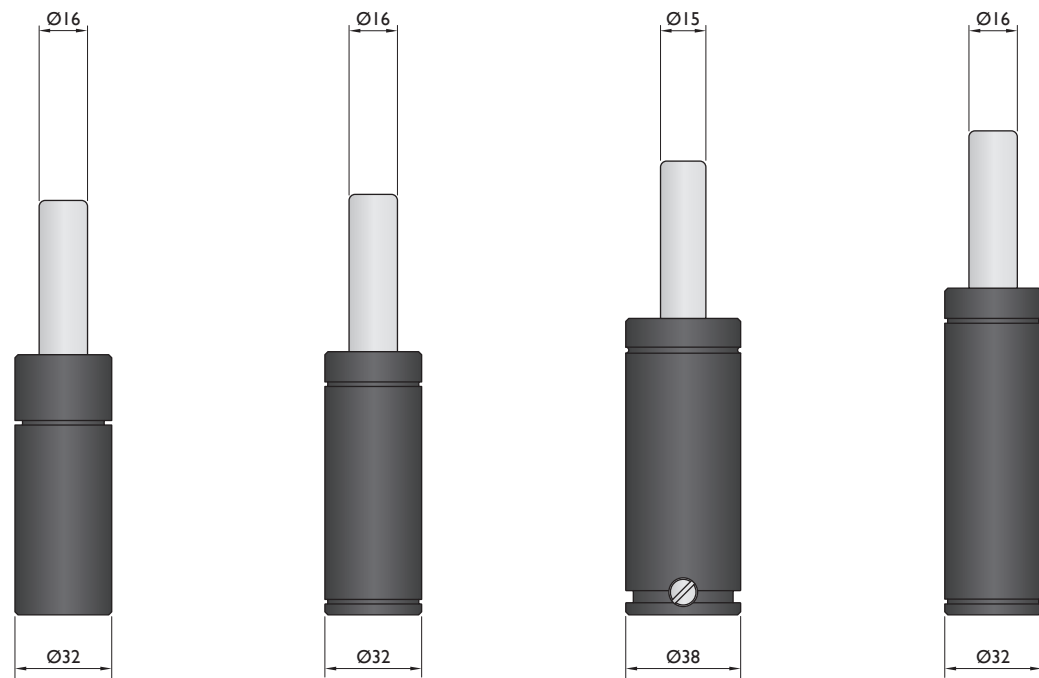
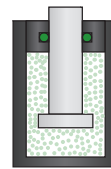

Model	KC-300	K-300	CN-250	G-300
Initial F (daN)	300	100-300	265	100-300
L max (mm)	2xStroke+37	2xStroke+39	2xStroke+50	2xStroke+60
Stroke (mm)	7-125	7-125	10-125	12-125

\* other strokes under request

### Standards

PED 97/23/EC	PED 97/23/EC	PED 97/23/EC	PED 97/23/EC
ISO 11901	ISO 11901	ISO 11901	ISO 11901
VDI 3003	VDI 3003	VDI 3003	VDI 3003
CNOMO EM24.54.700	CNOMO EM24.54.700	CNOMO EM24.54.700	CNOMO EM24.54.700

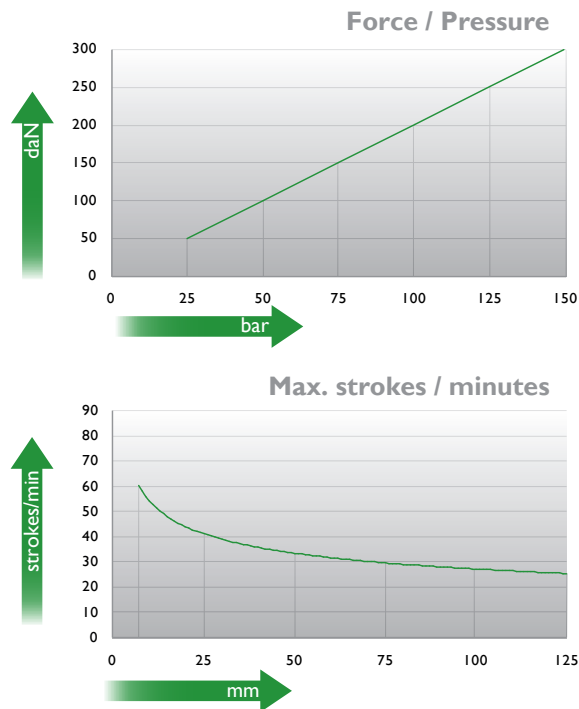
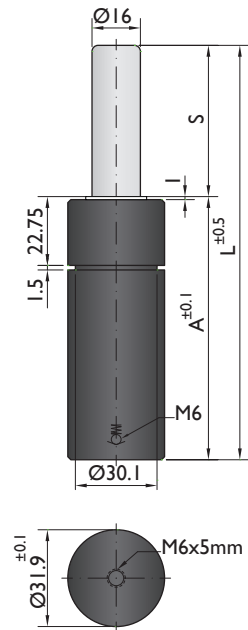

Ordering example: 4 x KC-300-125

Order No.	S <sup>(1)</sup> mm	L mm	A mm	F <sub>0</sub> <sup>(2)</sup> daN	F daN	kg
KC-300-7	7	51	44	300	420	0.19
KC-300-12	12	61	49		440	0.21
KC-300-16	16	69	53		440	0.23
KC-300-25	25	87	62		440	0.25
KC-300-38	38	113	75		450	0.30
KC-300-50	50	137	87		450	0.33
KC-300-63	63	163	100		450	0.38
KC-300-80	80	197	117		450	0.44
KC-300-100	100	237	137		450	0.51
KC-300-125	125	287	162		460	0.58

(1) other strokes under request      (2) alternative forces upon request

<b>i</b>	Pressure medium	N <sub>2</sub>	Working temperature	0-80°C	Min. security stroke	10%
	Max. Charging pressure	150 bar	Temperature related force increase	+0.34%/°C	Repair Kit	KIT KC-300
	Min. Charging pressure	25 bar	Max. working speed	1.6 m/s	Linkable	No

### Mounting possibilities

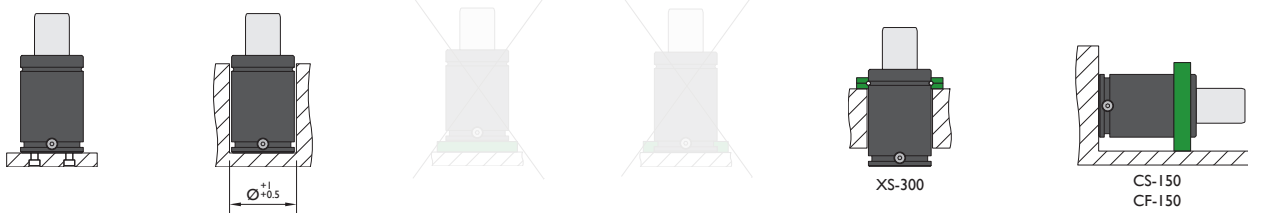

Flange must not support spring's force

## Flanges



### XS-300

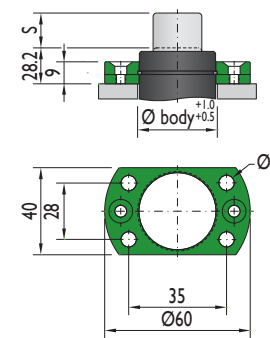

### CS-150

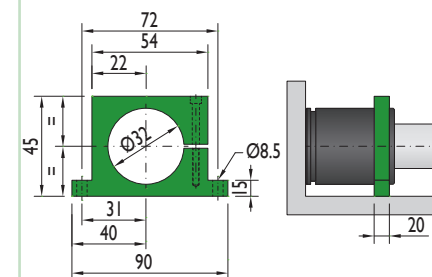

Flange must not support spring's force

### CF-150

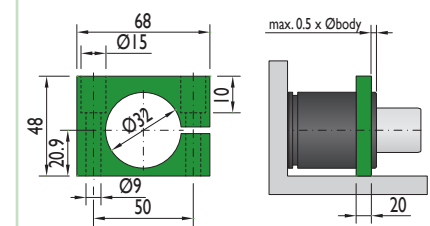

Flange must not support spring's force



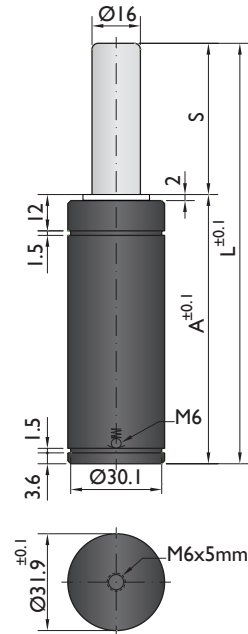

Force / Pressure

		daN	bar (20°C)
V	GREEN	100	50
Z	BLUE	200	100
R	RED	250	125
A	YELLOW	300	150

\* maximum force if not specified

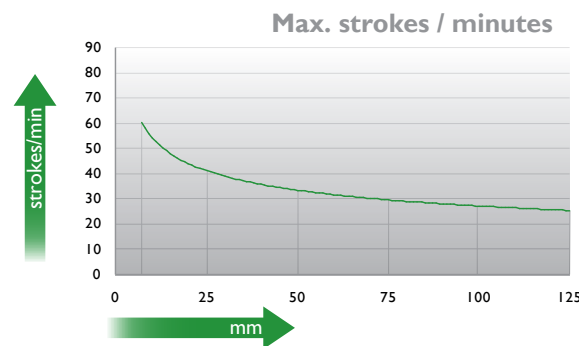

Ordering example: 4 x K-300-125 V

Order No.	S <sup>(1)</sup> mm	L mm	A mm	F <sub>0</sub> <sup>(2)</sup> daN (20°C, 150 bar)	F daN	kg
K-300-7	7	53	46	300	400	0.23
K-300-12	12	63	51		420	0.24
K-300-16	16	71	55		420	0.25
K-300-25	25	89	64		430	0.28
K-300-38	38	115	77		450	0.32
K-300-50	50	139	89		450	0.36
K-300-63	63	165	102		450	0.40
K-300-80	80	199	119		450	0.46
K-300-100	100	239	139		450	0.53
K-300-125	125	289	164		460	0.59

<sup>(1)</sup> other strokes under request

<sup>(2)</sup> alternative forces upon request



Pressure medium	N <sub>2</sub>	Working temperature	0-80°C	Min. security stroke	10%
Max. Charging pressure	150 bar	Temperature related force increase	+0.34%/°C	Repair Kit	KIT K-300
Min. Charging pressure	25 bar	Max. working speed	1.6 m/s	Linkable	No

### Mounting possibilities

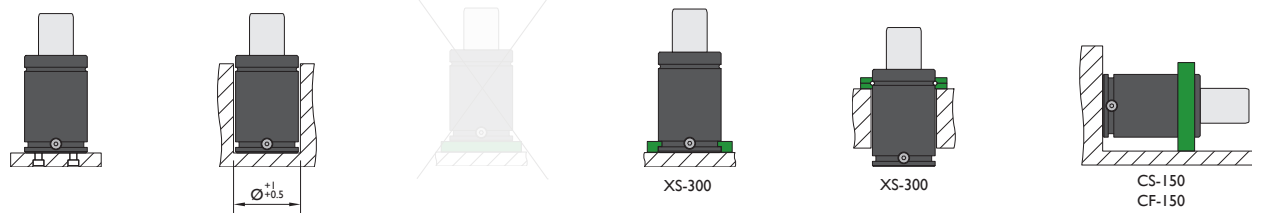

Flange must not support spring's force

## Flanges

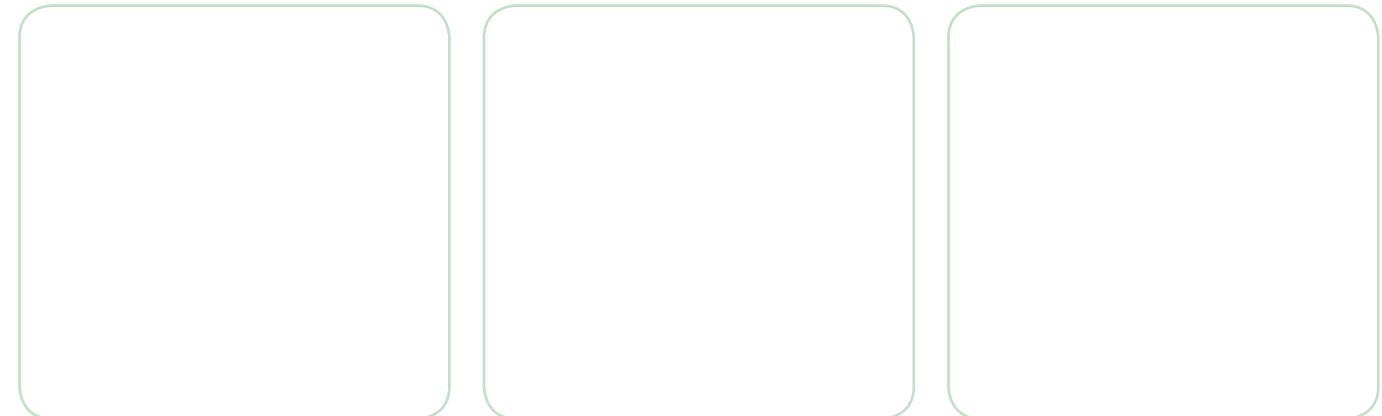

### XS-300

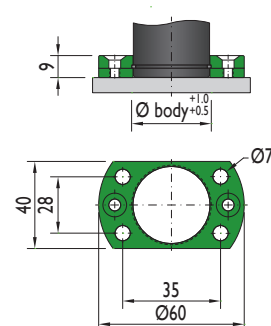

### XS-300

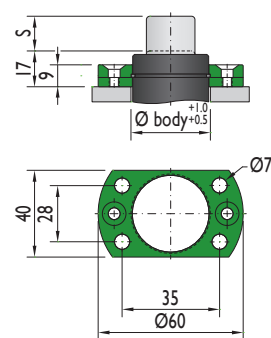

### CS-150

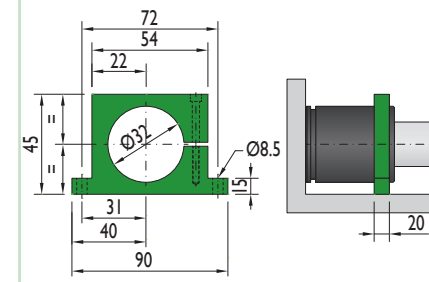

Flange must not support spring's force

### CF-150

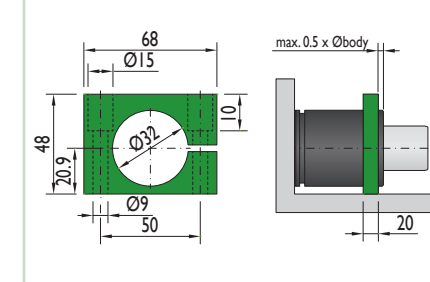

Flange must not support spring's force

Special mounts available on  
[www.nitrogas.com](http://www.nitrogas.com)



CNOMO  
EM24.54.700

PSA  
E24.54.815.G

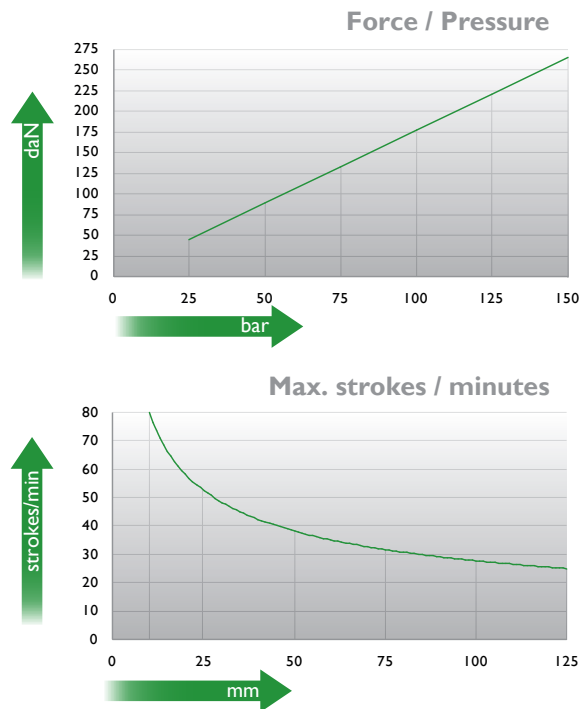
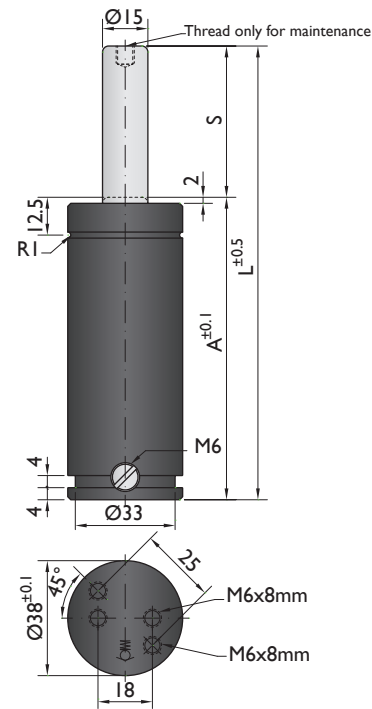

Ordering example: 4 x CN-250-125

Order No.	S <sup>(1)</sup> mm	L mm	A mm	F <sub>0</sub> <sup>(2)</sup> daN	F daN	kg
CN-250-10	10	70	60		310	0.40
CN-250-13	12.7	75.4	62.7		310	0.42
CN-250-16	16	82	66		320	0.43
CN-250-19	19	88	69		330	0.45
CN-250-25	25	100	75		330	0.51
CN-250-38	38.1	126.2	88.1	265	340	0.57
CN-250-50	50	150	100		350	0.63
CN-250-63	63.5	177	113.5		350	0.75
CN-250-80	80	210	130		360	0.81
CN-250-100	100	250	150		360	0.92
CN-250-125	125	300	175		360	1.10

<sup>(1)</sup> other strokes under request

<sup>(2)</sup> alternative forces upon request



Pressure medium	N <sub>2</sub>	Working temperature	0-80°C	Min. security stroke	10%
Max. Charging pressure	150 bar	Temperature related force increase	+0.34%/°C	Repair Kit	KIT CN-250
Min. Charging pressure	25 bar	Max. working speed	1.6 m/s	Linkable	M6

### Mounting possibilities

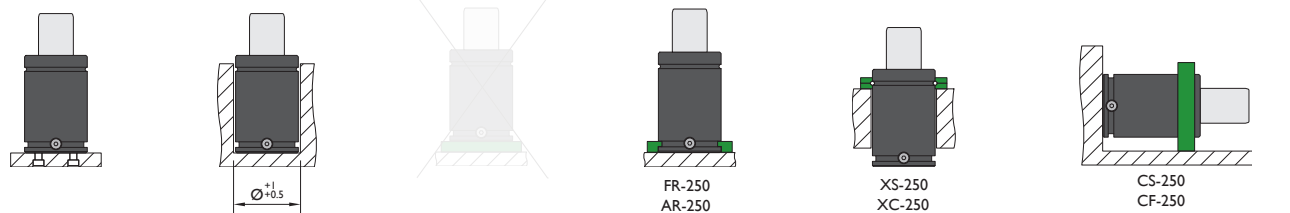

Flange must not support spring's force

## Flanges

**FR-250**

**AR-250**

**XS-250**

**XC-250**

**PR-250**

**CS-250**

**CF-250**

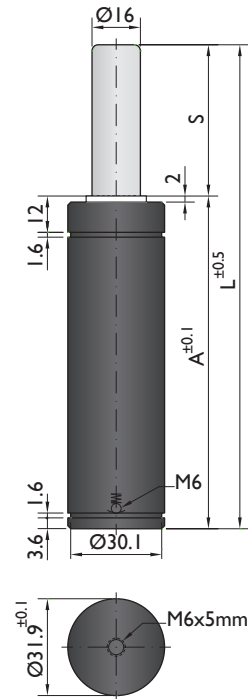

Force / Pressure

		daN	bar (20°C)
V	GREEN	100	50
Z	BLUE	200	100
R	RED	250	125
A	YELLOW	300	150

\* maximum force if not specified

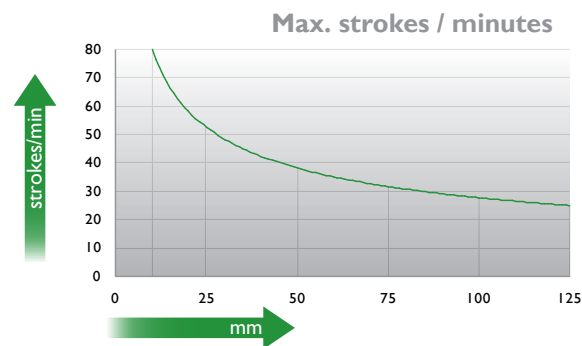

Ordering example: 4 x G-300-125 Z

Order No.	S <sup>(1)</sup> mm	L mm	A mm	F <sub>0</sub> <sup>(2)</sup> daN (20°C, 150 bar)	F daN	kg
G-300-12	12	84	72	300	340	0.28
G-300-25	25	110	85		370	0.33
G-300-38	38	136	98		380	0.37
G-300-50	50	160	110		390	0.41
G-300-63	63	186	123		420	0.49
G-300-80	80	220	140		430	0.56
G-300-100	100	260	160		440	0.64
G-300-125	125	310	185		450	0.74

<sup>(1)</sup> other strokes under request

<sup>(2)</sup> alternative forces upon request



Pressure medium	N <sub>2</sub>	Working temperature	0-80°C	Min. security stroke	10%
Max. Charging pressure	150 bar	Temperature related force increase	+0.34%/°C	Repair Kit	KIT G-300
Min. Charging pressure	25 bar	Max. working speed	1.6 m/s	Linkable	No

### Mounting possibilities

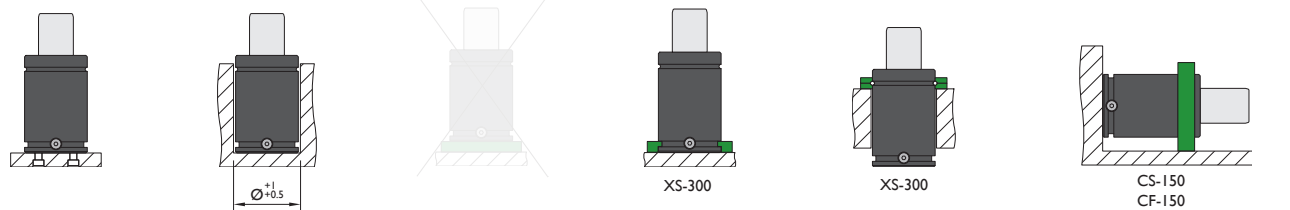

Flange must not support spring's force

## Flanges

<b>XS-300</b> 		
<b>XS-300</b> 		
<b>CS-150</b> 	<b>CF-150</b> 	
Flange must not support spring's force		VDI