

Force 3000 daN

Piston Rod Sealed gas springs

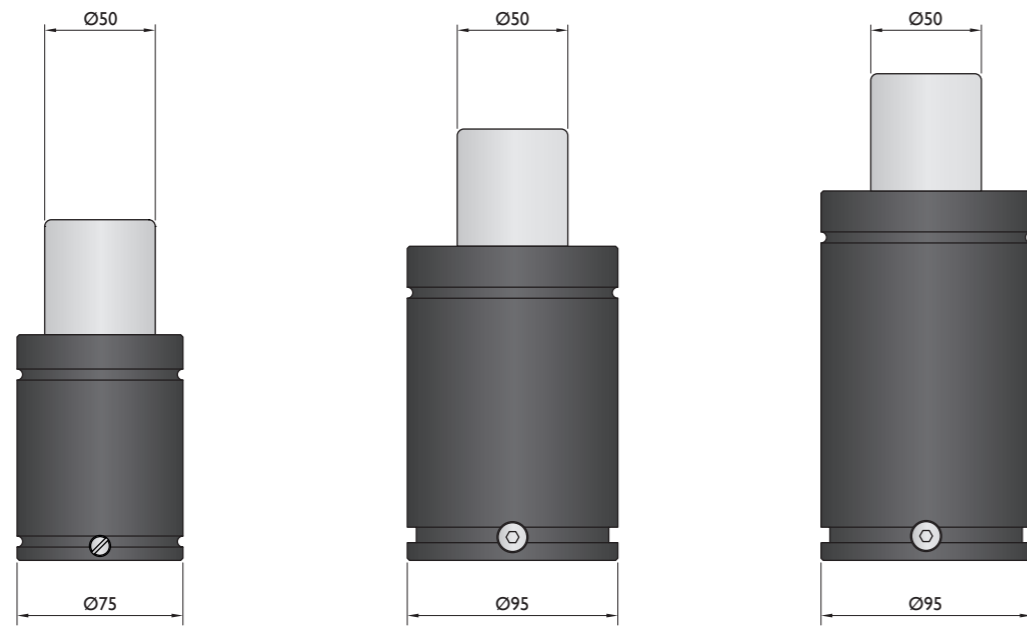
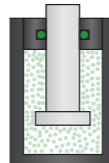

Model	KC-3000	HG-3000	G-3000
Initial F (daN)	3000	3000	3000
L max (mm)	2xStroke+54	2xStroke+95	2xStroke+120
Stroke (mm)	12-125	25-200	25-300

* other strokes under request

Standards

Model	KC-3000	HG-3000	G-3000
PED	97/23/EC	97/23/EC	97/23/EC
ISO	11901	11901	11901
VDI	3003	3003	3003
CNOMO	EM24.54.700	EM24.54.700	EM24.54.700

Force 3000 daN

Bore Sealed gas springs

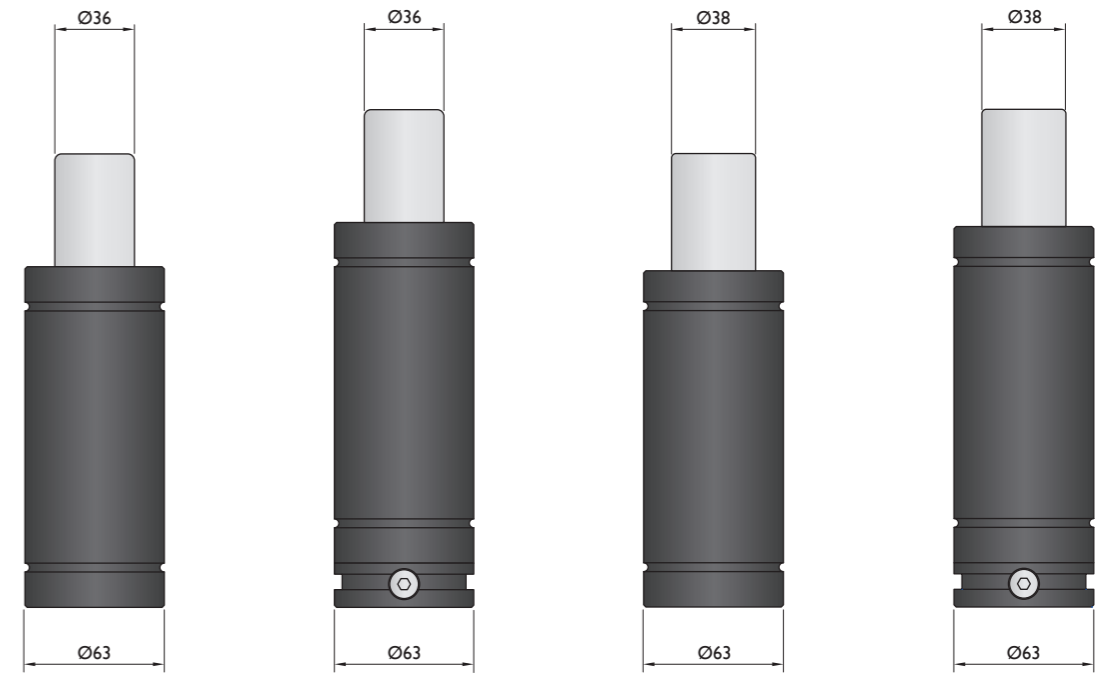
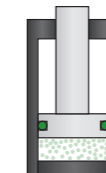

Model	T-3000	TC-3000	TS-3000	TSC-3000
Initial F (daN)	3000	3000	3000	3000
L max (mm)	85-205	105-225	85-256	105-276
Stroke (mm)	10-50	10-50	10-65	10-65

* other strokes under request

Standards

Model	T-3000	TC-3000	TS-3000	TSC-3000
PED	97/23/EC	97/23/EC	97/23/EC	97/23/EC
ISO	11901	11901	11901	11901
VDI	3003	3003	3003	3003
CNOMO	EM24.54.700	EM24.54.700	EM24.54.700	EM24.54.700



*The new cylinder will be supplied when the stock runs out.

NEW MODEL*

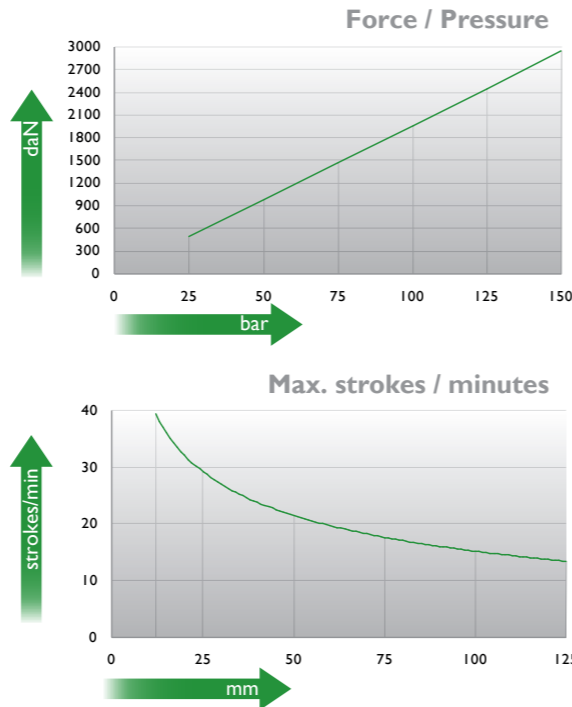
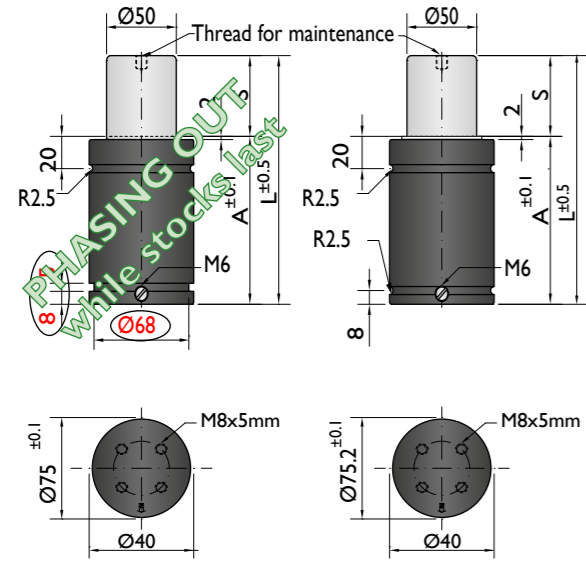

Ordering example: 4 x KC-3000-125

Order No.	S ⁽¹⁾ mm	L mm	A mm	F ₀ ⁽²⁾ daN	F daN	(3)	kg
KC-3000-12	12	78	66	3000 (20°C, 150 bar)	4300	No	1.65
KC-3000-25	25	104	79		4800	No	1.87
KC-3000-38	38	130	92		5000	No	2.12
KC-3000-50	50	154	104		5300	Yes	2.31
KC-3000-63	63	180	117		5300	Yes	2.60
KC-3000-80	80	214	134		5300	Yes	2.93
KC-3000-100	100	254	154		5300	Yes	3.20
KC-3000-125	125	304	179		5400	Yes	3.41

(1) other strokes under request

(2) alternative forces upon request

(3) ESK available for other strokes



Pressure medium	N ₂	Working temperature	0-80°C	Min. security stroke	10%
Max. Charging pressure	150 bar	Temperature related force increase	+0.34%/°C	Repair Kit	KIT KC-3000
Min. Charging pressure	25 bar	Max. working speed	1.6 m/s	Linkable	M6

Mounting possibilities

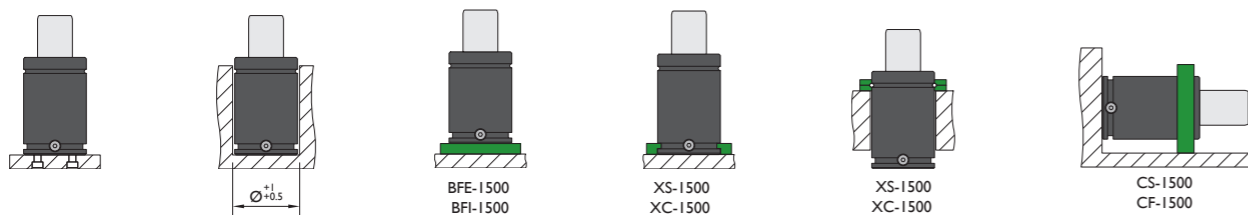

Flange must not support spring's force

Flanges

BFE-1500

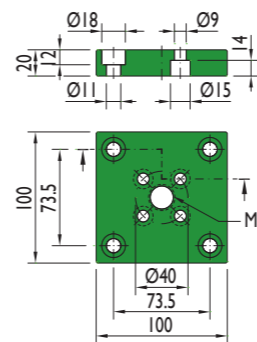

BFI-1500

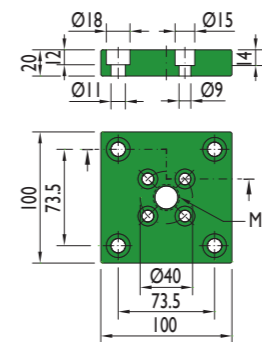

MC-2500

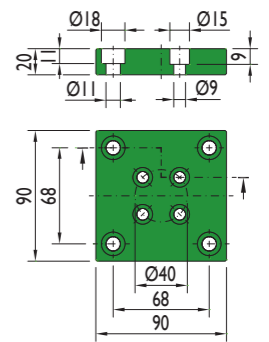

XS-1500

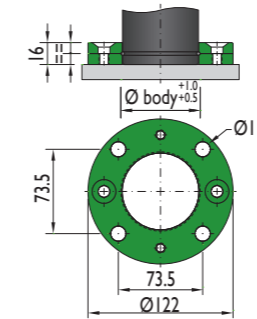

XC-1500

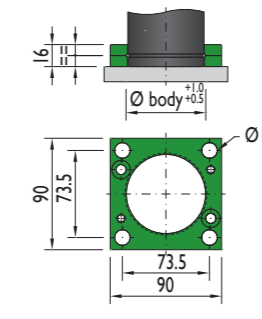

XS-1500

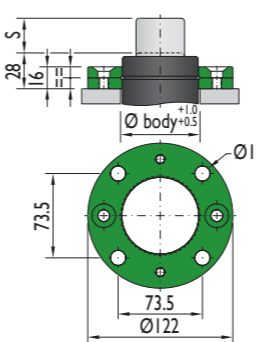

XC-1500

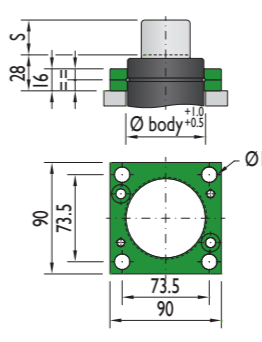

CS-1500

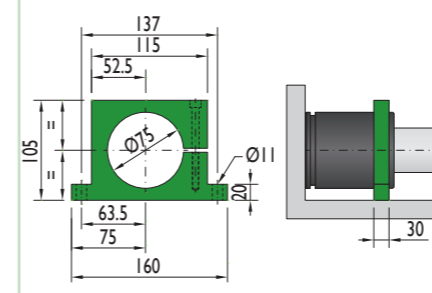

Flange must not support spring's force

CF-1500

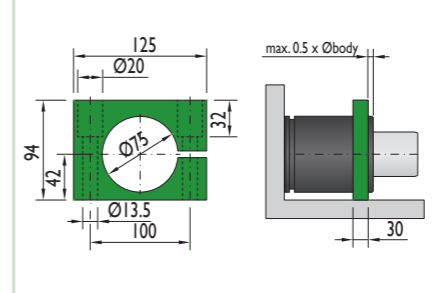

Flange must not support spring's force

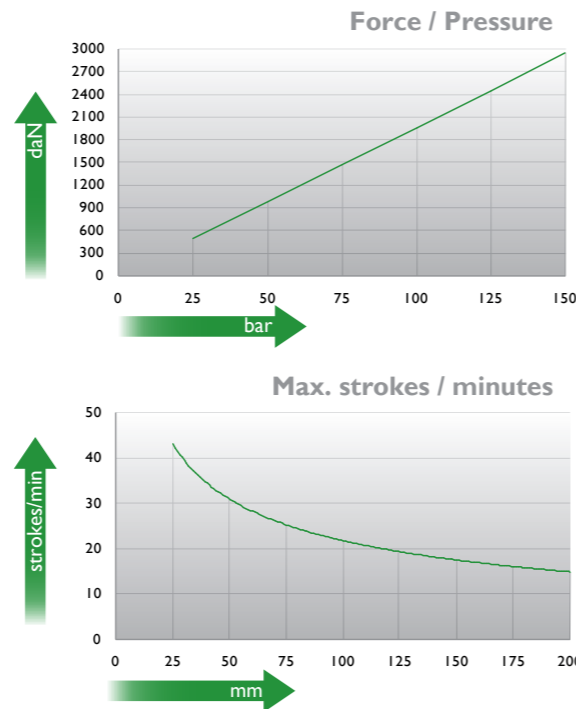
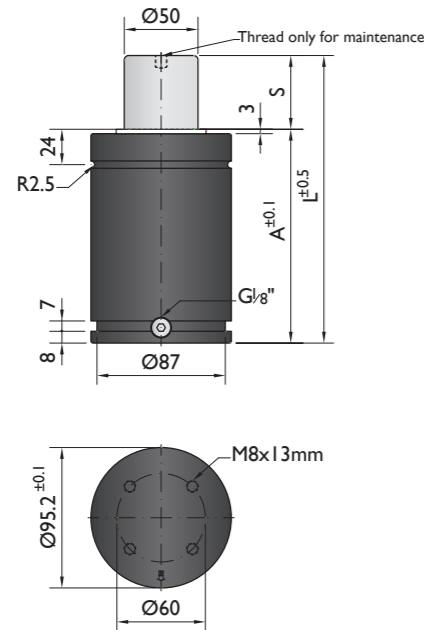

Ordering example: 4 x HG-3000-125

Order No.	S ⁽¹⁾ mm	L mm	A mm	F ₀ ⁽²⁾ daN (20°C, 150 bar)	F daN	(3)	kg
HG-3000-25	25	145	120	3000	4100	No	4.42
HG-3000-38	37.5	170	132.5		4300	No	4.72
HG-3000-50	50	195	145		4400	No	5.03
HG-3000-63	62.5	220	157.5		4500	No	5.34
HG-3000-80	80	255	175		4500	Yes	5.76
HG-3000-100	100	295	195		4600	Yes	6.25
HG-3000-125	125	345	220		4600	Yes	6.87
HG-3000-160	160	415	255		4600	Yes	7.72
HG-3000-200	200	495	295		4700	Yes	8.70

other strokes under request

alternative forces upon request

ESK available for other strokes



Pressure medium	N ₂	Working temperature	0-80°C	Min. security stroke	10%
Max. Charging pressure	150 bar	Temperature related force increase	+0.34%/°C	Repair Kit	KIT HG-3000
Min. Charging pressure	25 bar	Max. working speed	1.6 m/s	Linkable	G1/8"

Mounting possibilities

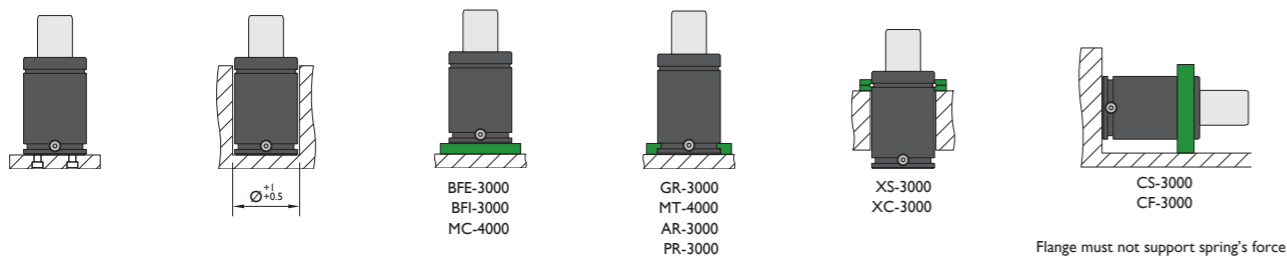

Flange must not support spring's force

Flanges

BFE-3000

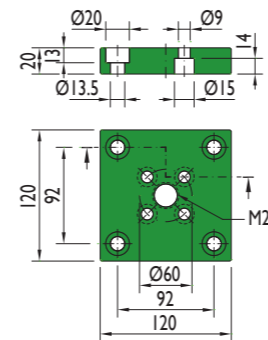

BFI-3000

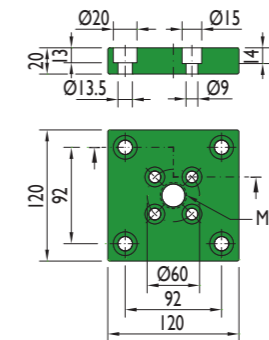

MC-4000

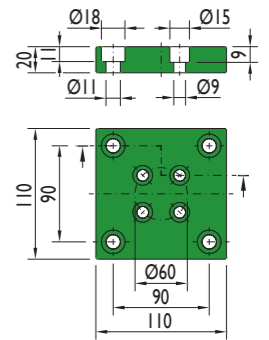

GR-3000

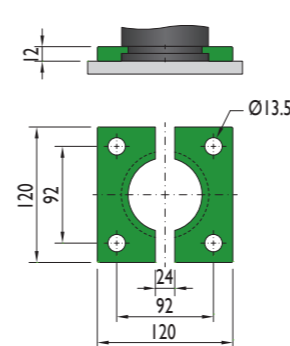

MT-4000

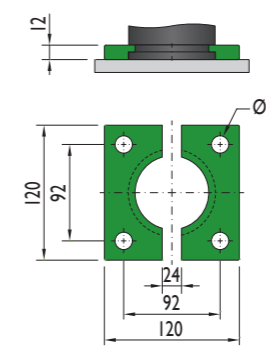

AR-3000

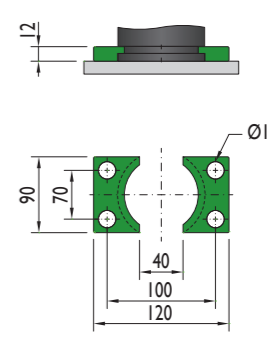

XS-3000

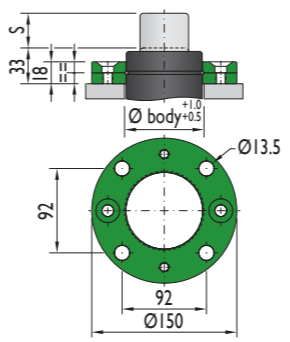

XC-3000

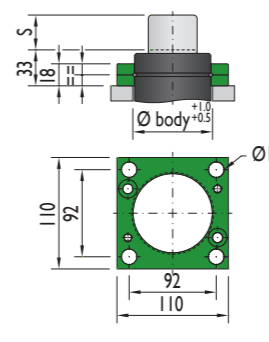

PR-3000

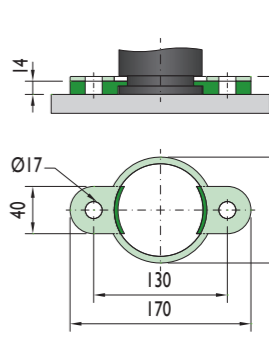

CS-3000

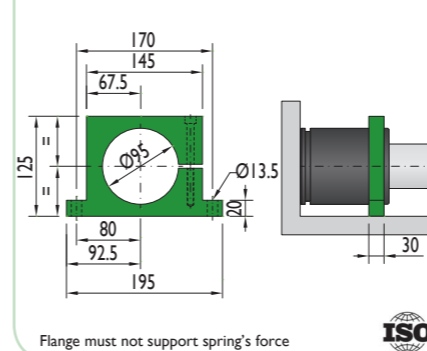

Flange must not support spring's force

CF-3000

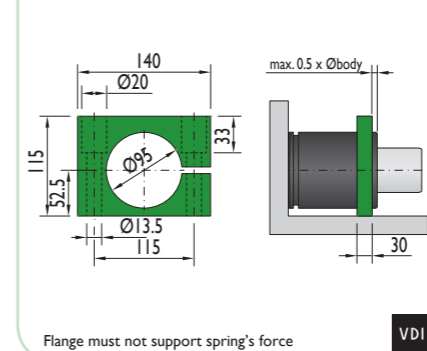

Flange must not support spring's force



CNOMO
EM24.54.700

PSA
E24.54.815.G

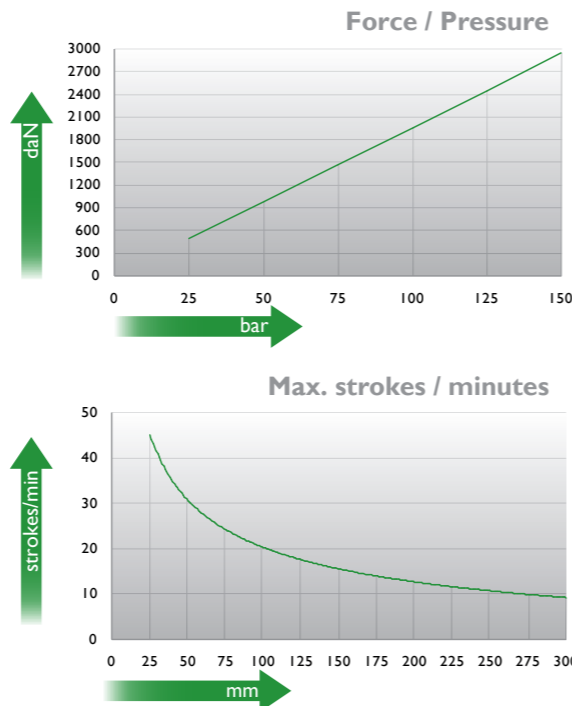
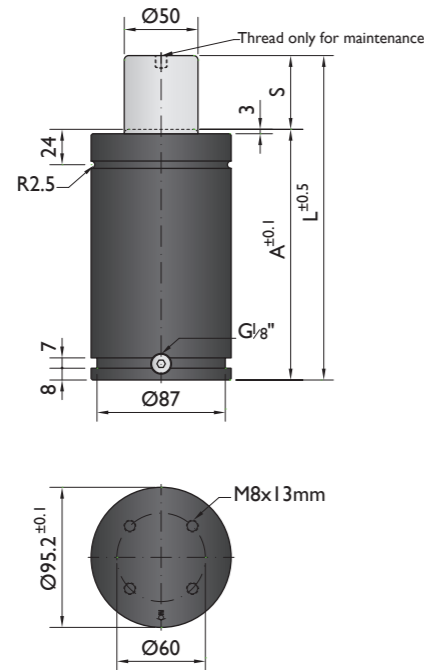

Ordering example: 4 x G-3000-125

Order No.	S ⁽¹⁾ mm	L mm	A mm	F ₀ ⁽²⁾ daN	F daN	(3)	kg
G-3000-25	25	170	145		3500	No	5.86
G-3000-38	38.1	196.2	158.1		3700	No	6.20
G-3000-50	50	220	170		3800	No	6.66
G-3000-63	63.5	247	183.5		3900	No	7.00
G-3000-80	80	280	200		4000	No	8.28
G-3000-100	100	320	220	3000	4200	Yes	8.65
G-3000-125	125	370	245		4200	Yes	8.97
G-3000-160	160	440	280		4200	Yes	9.86
G-3000-200	200	520	320		4300	Yes	10.92
G-3000-250	250	620	370		4300	Yes	12.25
G-3000-300	300	720	420		4400	Yes	13.58

(1) other strokes under request

(2) alternative forces upon request

(3) ESK available for other strokes



Pressure medium	N ₂	Working temperature	0-80°C	Min. security stroke	10%
Max. Charging pressure	150 bar	Temperature related force increase	+0.34%/°C	Repair Kit	KIT G-3000
Min. Charging pressure	25 bar	Max. working speed	1.6 m/s	Linkable	G1/8"

Mounting possibilities

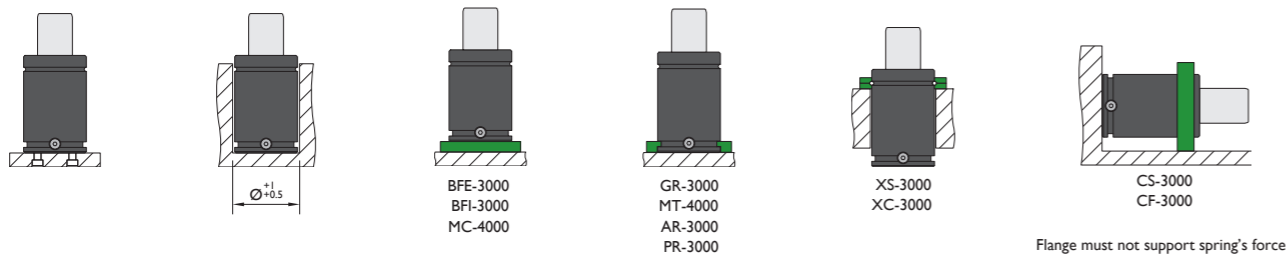

Flanges

BFE-3000

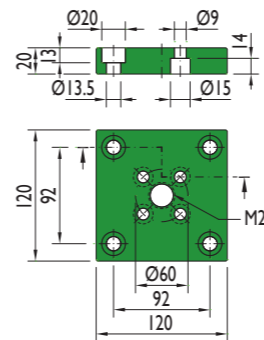

BFI-3000

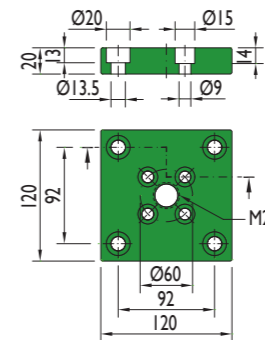

MC-4000

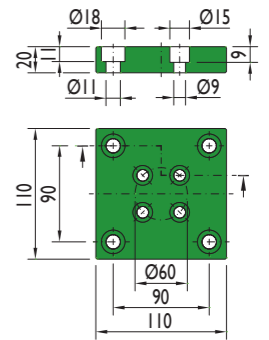

GR-3000

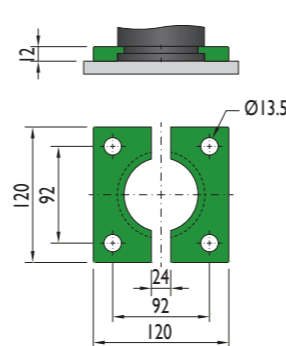

MT-4000

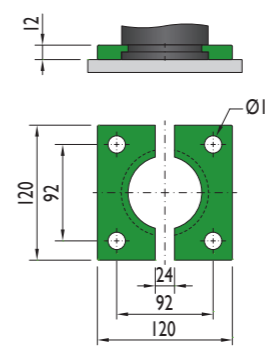

AR-3000

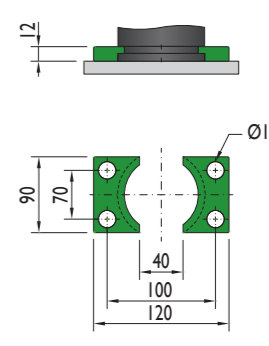

XS-3000

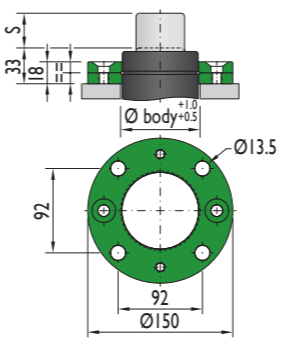

XC-3000

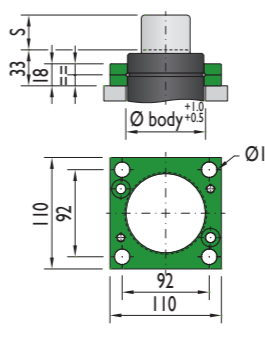

PR-3000

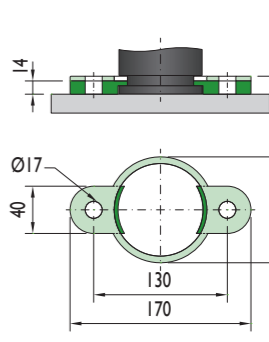

CS-3000

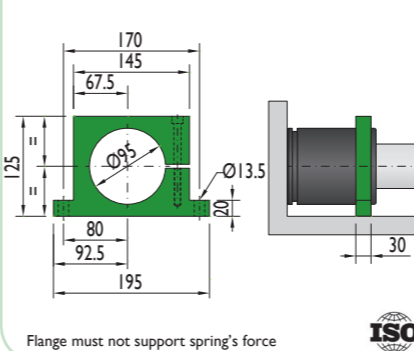

CF-3000

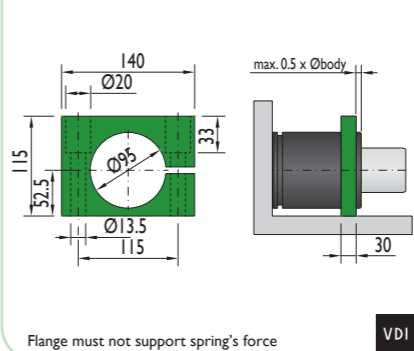

Special mounts available on
www.nitrogas.com

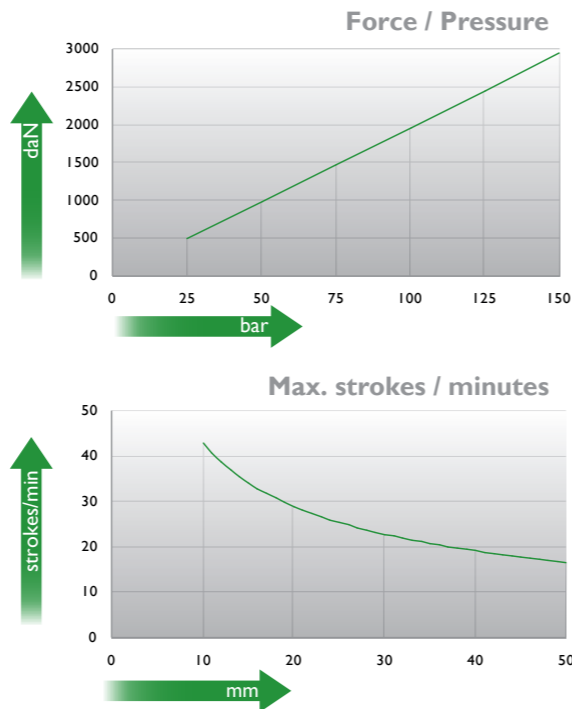
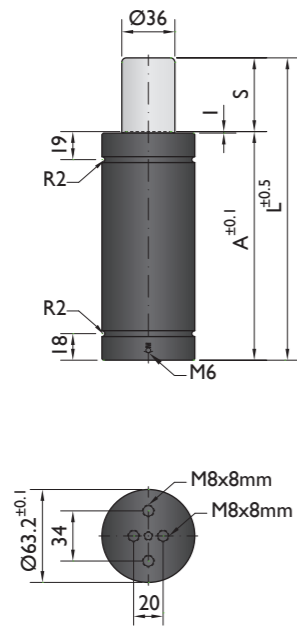

Ordering example: 4 x T-3000-50

Order No.	S ⁽¹⁾ mm	L mm	A mm	F ₀ ⁽²⁾ daN (20°C, 150 bar)	F daN	ESK ⁽³⁾	kg
T-3000-10	10	85	75	3000	4100	No	1.15
T-3000-16	16	103	87		4400	No	1.35
T-3000-25	25	130	105		4600	No	1.54
T-3000-32	32	150	118		4800	No	1.77
T-3000-40	40	175	135		4800	No	2.02
T-3000-50	50	205	155		4900	No	2.31

(1) other strokes under request (2) alternative forces upon request (3) ESK under request



Pressure medium	N ₂	Working temperature	0-80°C	Min. security stroke	10%
Max. Charging pressure	150 bar	Temperature related force increase	+0.34%/°C	Repair Kit	KIT T-3000
Min. Charging pressure	25 bar	Max. working speed	0.5 m/s	Linkable	No

Mounting possibilities

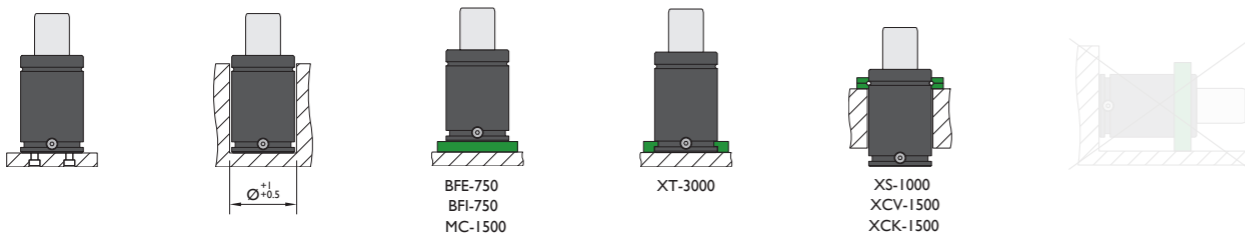

Flanges

BFE-750

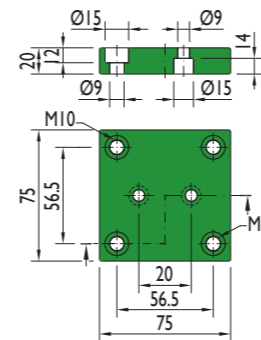

BFI-750

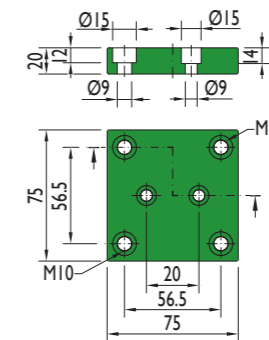

MC-1500

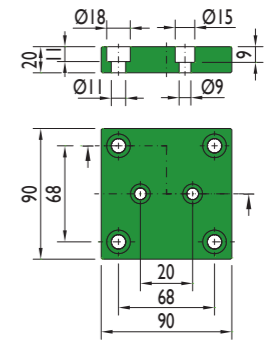

XT-3000

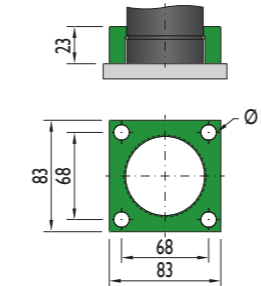

XS-1000

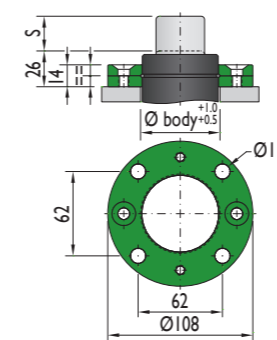

XCV-1500

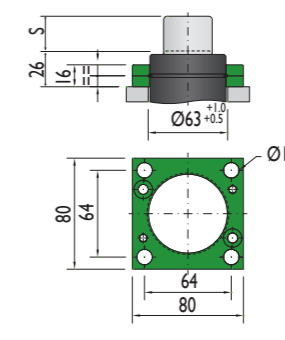

XCK-1500

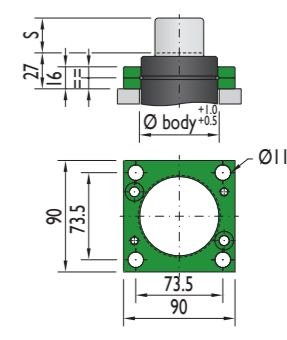

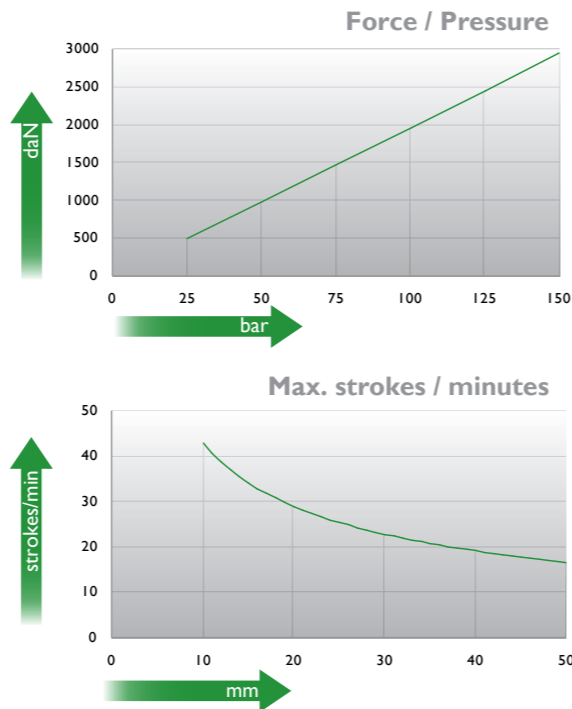
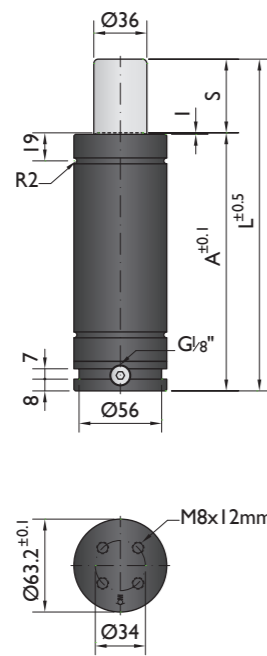

Ordering example: 4 x TC-3000-50

Order No.	S ⁽¹⁾ mm	L mm	A mm	F ₀ ⁽²⁾ daN (20°C, 150 bar)	F daN	(3)	kg
TC-3000-10	10	105	95	3000	4100	No	1.55
TC-3000-16	16	123	107		4400	No	1.75
TC-3000-25	25	150	125		4600	No	1.94
TC-3000-32	32	170	138		4800	No	2.17
TC-3000-40	40	195	155		4800	No	2.42
TC-3000-50	50	225	175		4900	No	2.71

(1) other strokes under request (2) alternative forces upon request (3) ESK under request



Pressure medium	N ₂	Working temperature	0-80°C	Min. security stroke	10%
Max. Charging pressure	150 bar	Temperature related force increase	+0.34%/°C	Repair Kit	KIT TC-3000
Min. Charging pressure	25 bar	Max. working speed	0.5 m/s	Linkable	G1/8"

Mounting possibilities

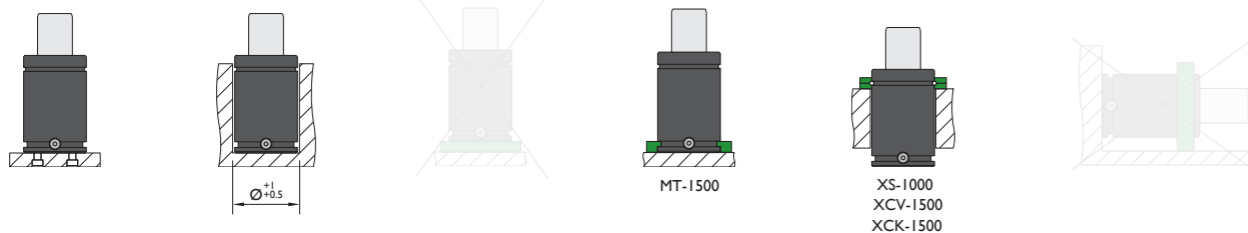

Flanges

MT-1500

XS-1000

XCV-1500

VDI

XCK-1500

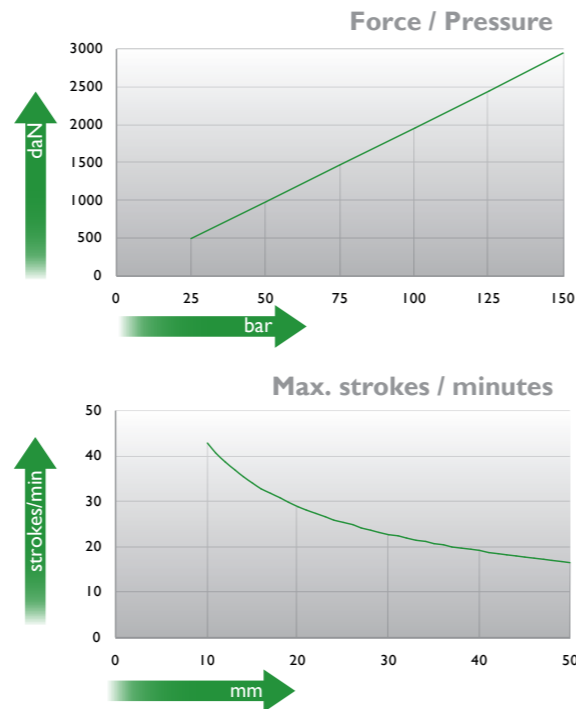
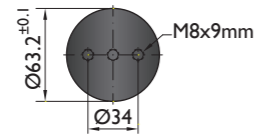
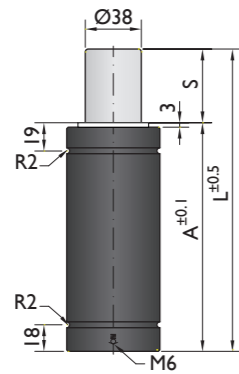

Ordering example: 4 x TS-3000-65

Order No.	S ⁽¹⁾ mm	L mm	A mm	F ₀ ⁽²⁾ daN (20°C, 150 bar)	F daN	 ⁽³⁾	kg
TS-3000-10	10	85	75	3000	4100	No	1.15
TS-3000-16	16	103	87		4400	No	1.35
TS-3000-25	25	130	105		4600	No	1.54
TS-3000-32	32	150	118		4800	No	1.77
TS-3000-40	40	175	135		4800	No	2.02
TS-3000-50	50	205	155		4900	No	2.31
TS-3000-65	65	256	191		4900	No	2.50

⁽¹⁾ other strokes under request

⁽²⁾ alternative forces upon request

⁽³⁾ ESK under request



Pressure medium	N ₂	Working temperature	0-80°C	Min. security stroke	10%
Max. Charging pressure	150 bar	Temperature related force increase	+0.34%/°C	Repair Kit	KIT TS-3000
Min. Charging pressure	25 bar	Max. working speed	0.5 m/s	Linkable	No

Mounting possibilities

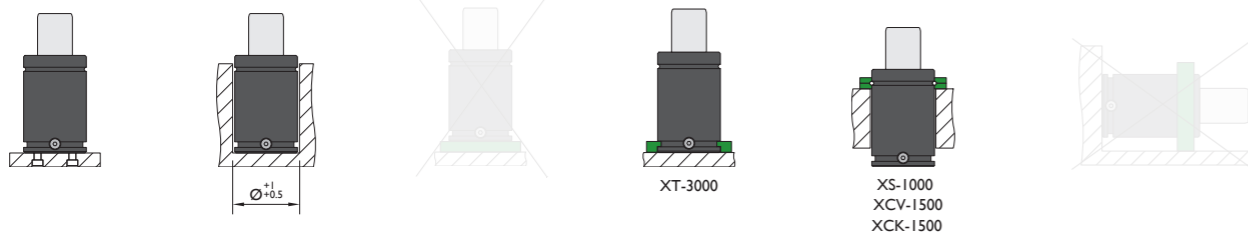

Flanges

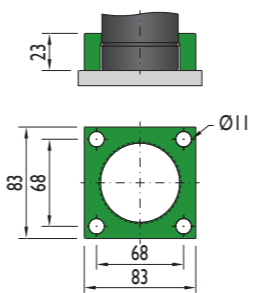
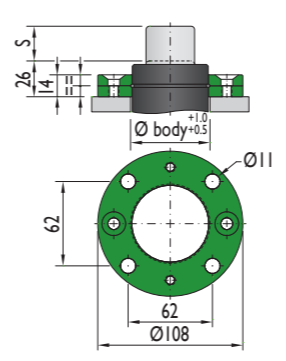
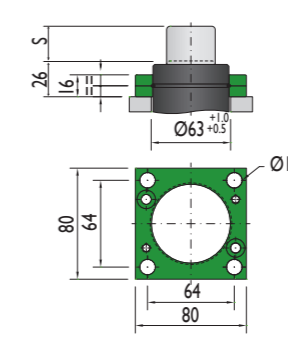
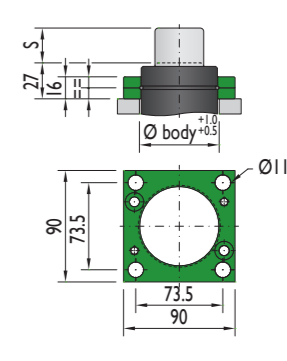
XT-3000 		
XS-1000 	XCV-1500 	XCK-1500 

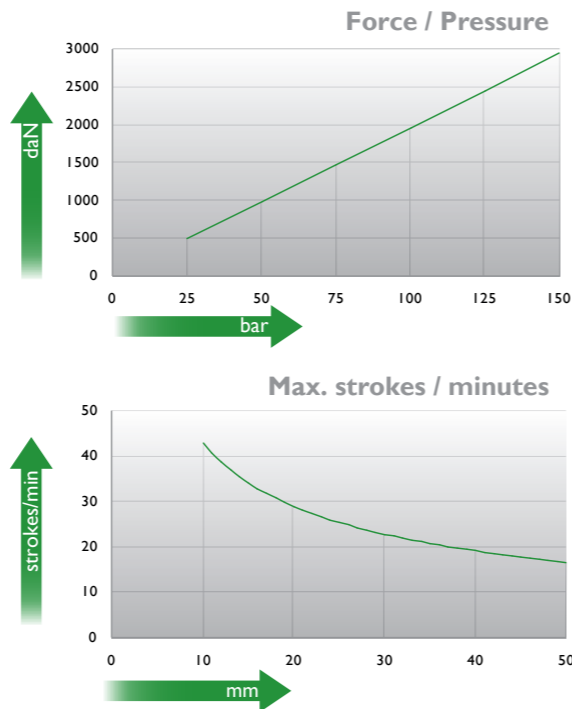
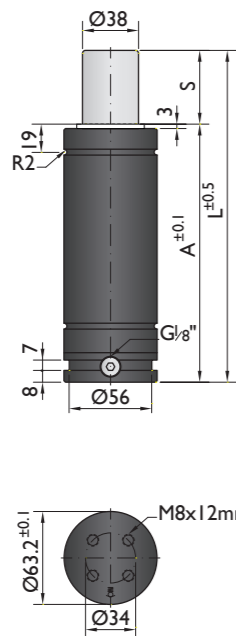

Ordering example: 4 x TSC-3000-65

Order No.	S ⁽¹⁾ mm	L mm	A mm	F ₀ ⁽²⁾ daN (20°C, 150 bar)	F daN	(3)	kg
TSC-3000-10	10	105	95	3000	4100	No	1.55
TSC-3000-16	16	123	107		4400	No	1.75
TSC-3000-25	25	150	125		4600	No	1.94
TSC-3000-32	32	170	138		4800	No	2.17
TSC-3000-40	40	195	155		4800	No	2.42
TSC-3000-50	50	225	175		4900	No	2.71
TSC-3000-65	65	276	211		4900	No	2.90

⁽¹⁾ other strokes under request

⁽²⁾ alternative forces upon request

⁽³⁾ ESK under request



Pressure medium	N ₂	Working temperature	0-80°C	Min. security stroke	10%
Max. Charging pressure	150 bar	Temperature related force increase	+0.34%/°C	Repair Kit	KIT TSC-3000
Min. Charging pressure	25 bar	Max. working speed	0.5 m/s	Linkable	G1/8"

Mounting possibilities

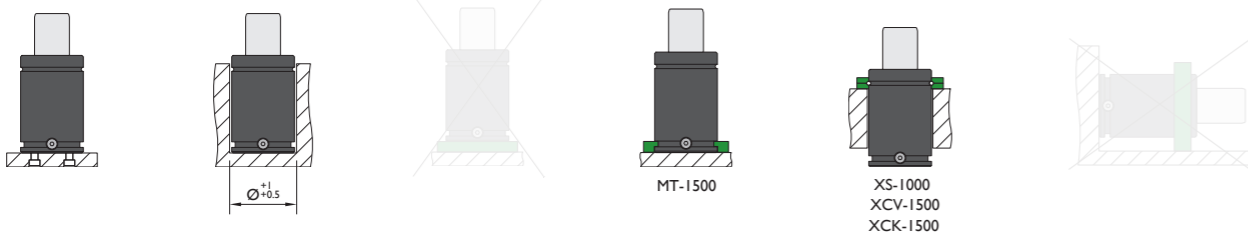

Flanges

MT-1500

XS-1000

XCV-1500

VD1

XCK-1500