

## Force 500 - 600 daN

Piston Rod Sealed  
gas springs

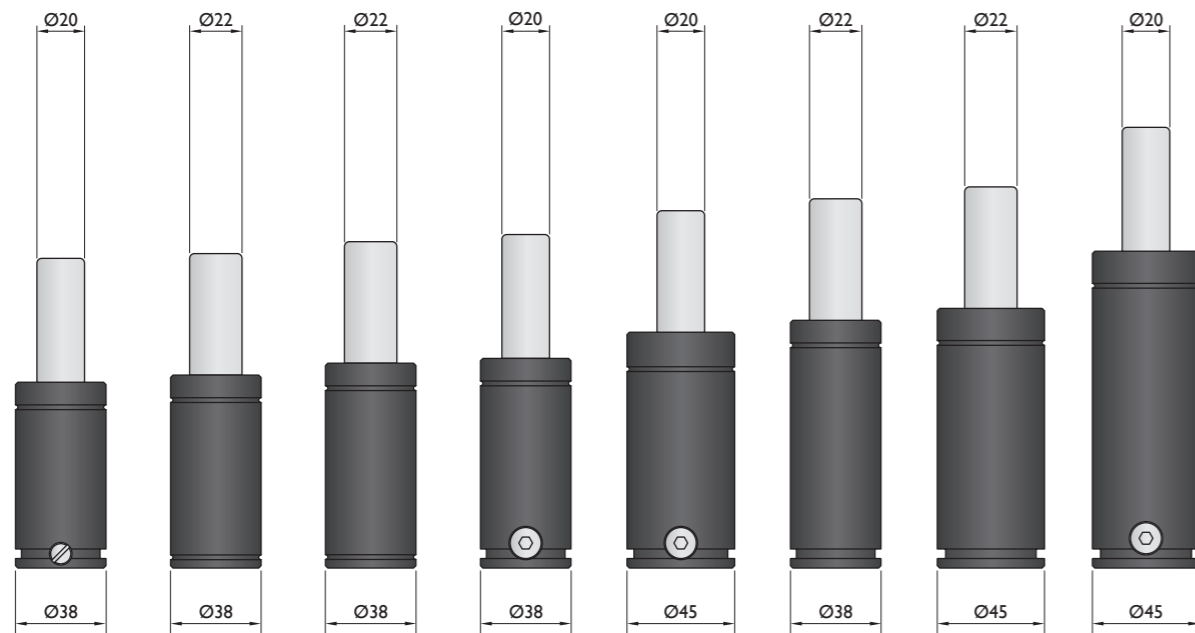
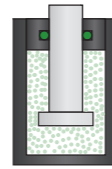

Model	KP-500	KC-550	K-570	NR-500	KH-500	M-500	G-500	CN-500
Initial F (daN)	470	550	570	470	470	500	500	470
L max (mm)	2xStroke+30	2xStroke+32	2xStroke+37	2xStroke+40	2xStroke+50	2xStroke+55	2xStroke+60	2xStroke+85
Stroke (mm)	10-125	12-125	7-125	10-125	12.7-125	12-125	12-125	12.7-160

\* other strokes under request

### Standards

	PED 97/23/EC	PED 97/23/EC	PED 97/23/EC	PED 97/23/EC	PED 97/23/EC	PED 97/23/EC	PED 97/23/EC	PED 97/23/EC
ISO	ISO 11901	ISO 11901	ISO 11901	ISO 11901	ISO 11901	ISO 11901	ISO 11901	ISO 11901
VDI	VDI 3003	VDI 3003	VDI 3003	VDI 3003	VDI 3003	VDI 3003	VDI 3003	VDI 3003
CNOMO	CNOMO EM24.54.700	CNOMO EM24.54.700	CNOMO EM24.54.700	CNOMO EM24.54.700	CNOMO EM24.54.700	CNOMO EM24.54.700	CNOMO EM24.54.700	CNOMO EM24.54.700



PSA  
E24.54.815.G

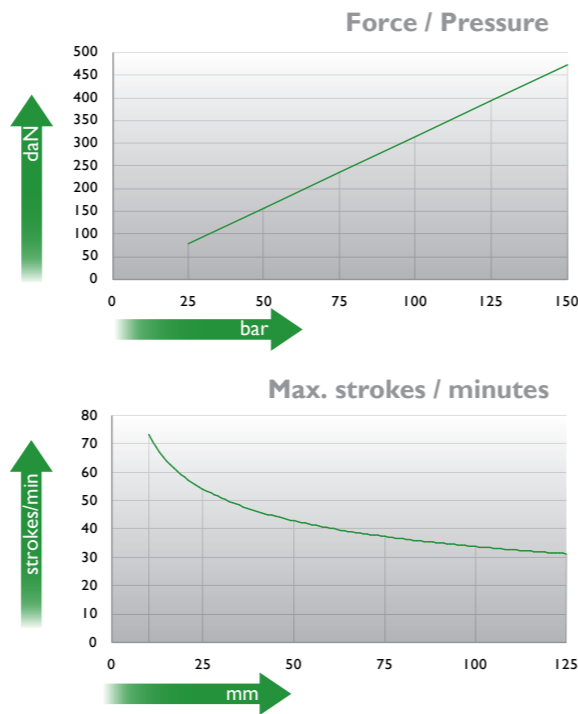
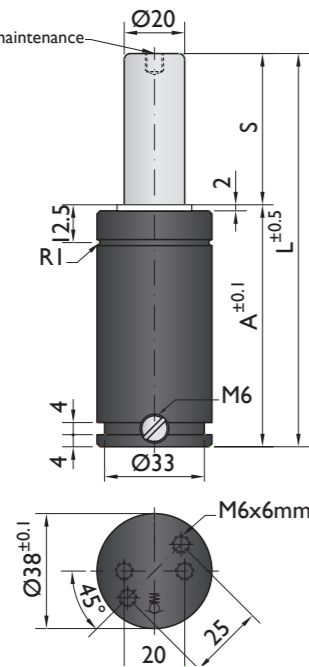

Ordering example: 4 x KP-500-125

Order No.	S <sup>(1)</sup> mm	L mm	A mm	F <sub>0</sub> <sup>(2)</sup> daN	F daN	kg
KP-500-10	10	50	40		680	0.29
KP-500-13	13	56	43		680	0.31
KP-500-16	16	62	46		690	0.34
KP-500-19	19	68	49		690	0.37
KP-500-25	25	80	55		690	0.42
KP-500-32	32	94	62		700	0.50
KP-500-38	38	106	68	470	700	0.55
KP-500-50	50	130	80		700	0.66
KP-500-63	63	156	93		710	0.80
KP-500-75	75	180	105		710	0.91
KP-500-80	80	190	110		710	0.98
KP-500-100	100	230	130		710	1.15
KP-500-125	125	280	155		710	1.38

other strokes<sup>(1)</sup> under request

alternative forces<sup>(2)</sup> upon request



Pressure medium	N <sub>2</sub>	Working temperature	0-80°C	Min. security stroke	10%
Max. Charging pressure	150 bar	Temperature related force increase	+0.34%/°C	Repair Kit	KIT KP-500
Min. Charging pressure	25 bar	Max. working speed	1.6 m/s	Linkable	M6

### Mounting possibilities

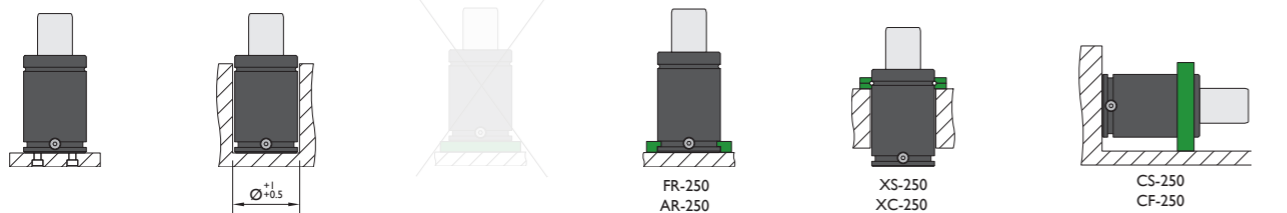

Flange must not support spring's force

## Flanges

**FR-250**

**AR-250**

**XS-250**

**XC-250**

**PR-250**

**CS-250**

**CF-250**

Flange must not support spring's force

Flange must not support spring's force

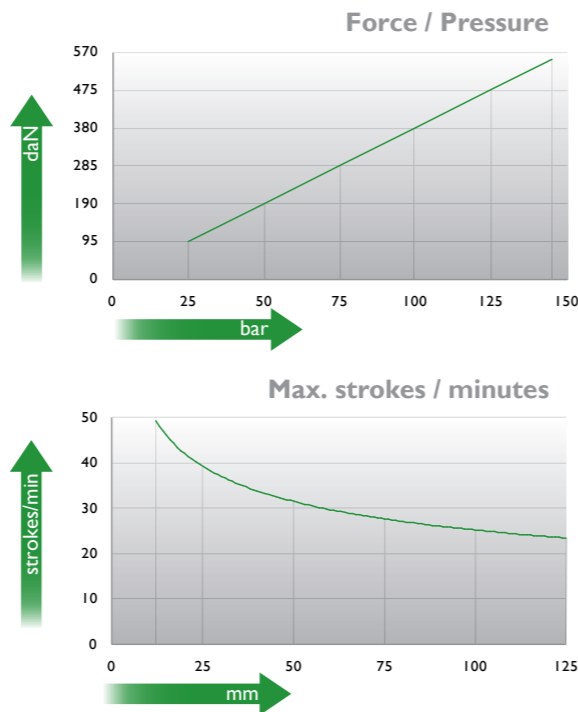
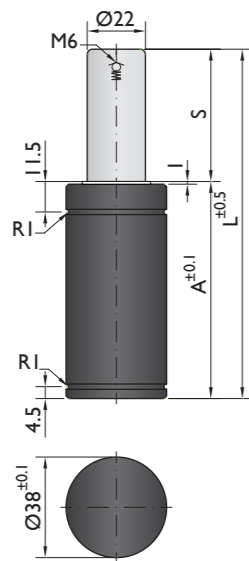

Ordering example: 4 x KC-550-125

Order No.	S <sup>(1)</sup> mm	L mm	A mm	F <sub>0</sub> <sup>(2)</sup> daN	F daN	kg
KC-550-12	12	56	44	550 (20°C, 145 bar)	880	0.27
KC-550-25	25	82	57		890	0.31
KC-550-38	38	108	70		890	0.36
KC-550-50	50	132	82		890	0.42
KC-550-63	63	158	95		890	0.45
KC-550-80	80	192	112		890	0.51
KC-550-100	100	232	132		890	0.58
KC-550-125	125	282	157		890	0.63

<sup>(1)</sup> other strokes under request

<sup>(2)</sup> alternative forces upon request



Pressure medium	N <sub>2</sub>	Working temperature	0-80°C	Min. security stroke	10%
Max. Charging pressure	145 bar	Temperature related force increase	+0.34%/°C	Repair Kit	KIT KC-550
Min. Charging pressure	25 bar	Max. working speed	1.6 m/s	Linkable	No

### Mounting possibilities

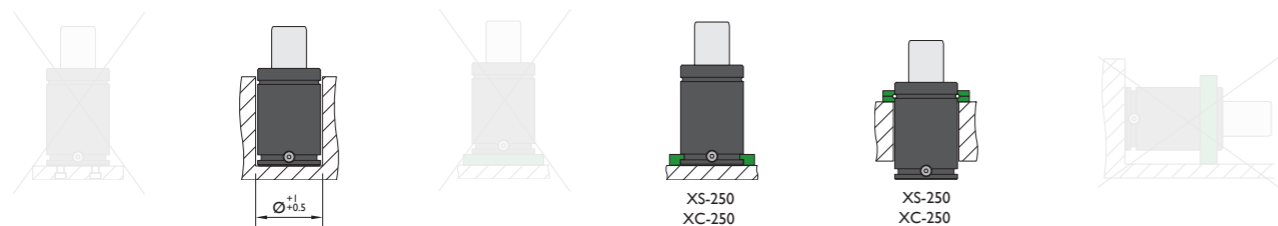

## Flanges

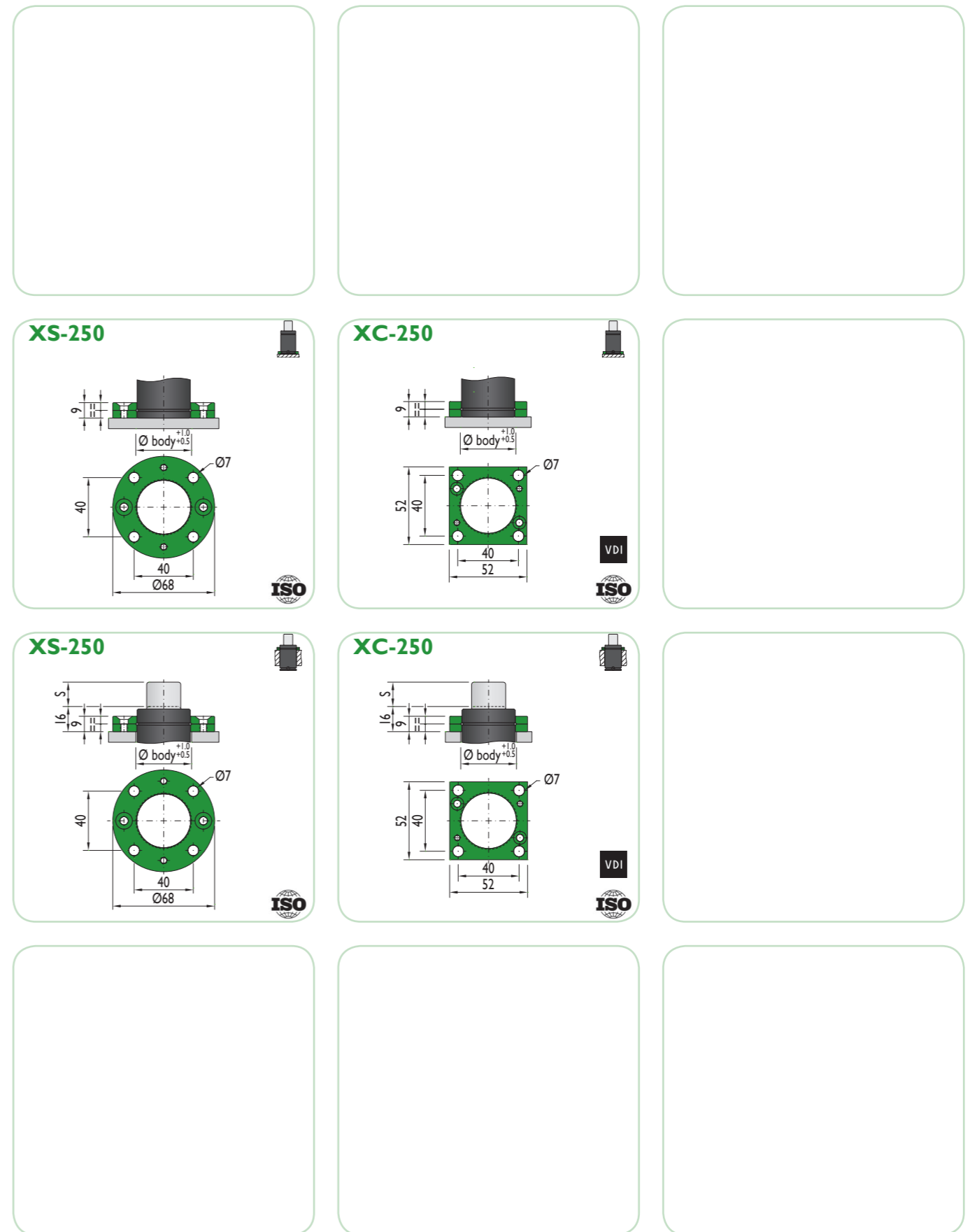

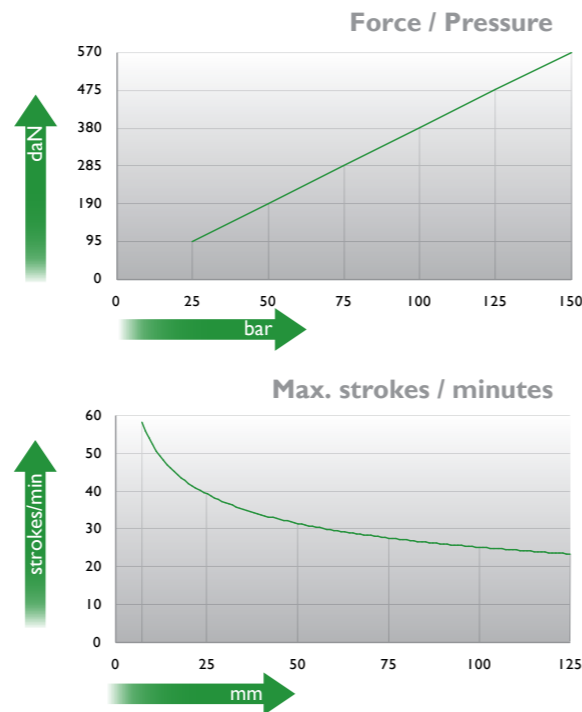
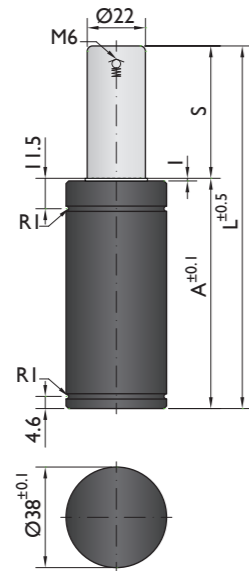

Ordering example: 4 x K-570-125

Order No.	S <sup>(1)</sup> mm	L mm	A mm	F <sub>0</sub> <sup>(2)</sup> daN	F daN	kg
K-570-7	7	51	44	570	830	0.26
K-570-12	12	61	49		860	0.31
K-570-16	16	69	53		870	0.33
K-570-25	25	87	62		890	0.36
K-570-38	38	113	75		900	0.41
K-570-50	50	137	87		910	0.47
K-570-63	63	163	100		910	0.50
K-570-80	80	197	117		910	0.60
K-570-100	100	237	137		920	0.69
K-570-125	125	287	162		920	0.75

(1) other strokes under request      (2) alternative forces upon request



Pressure medium	N <sub>2</sub>	Working temperature	0-80°C	Min. security stroke	10%
Max. Charging pressure	150 bar	Temperature related force increase	+0.34%/°C	Repair Kit	KIT K-570
Min. Charging pressure	25 bar	Max. working speed	1.6 m/s	Linkable	No

### Mounting possibilities

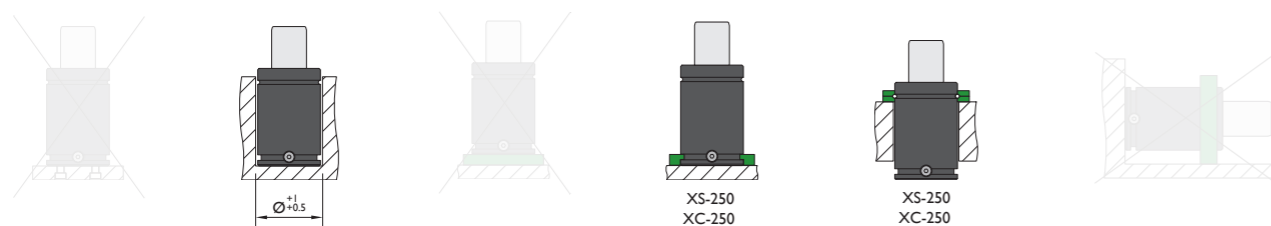

## Flanges



\*The new cylinder will be supplied when the stock runs out.

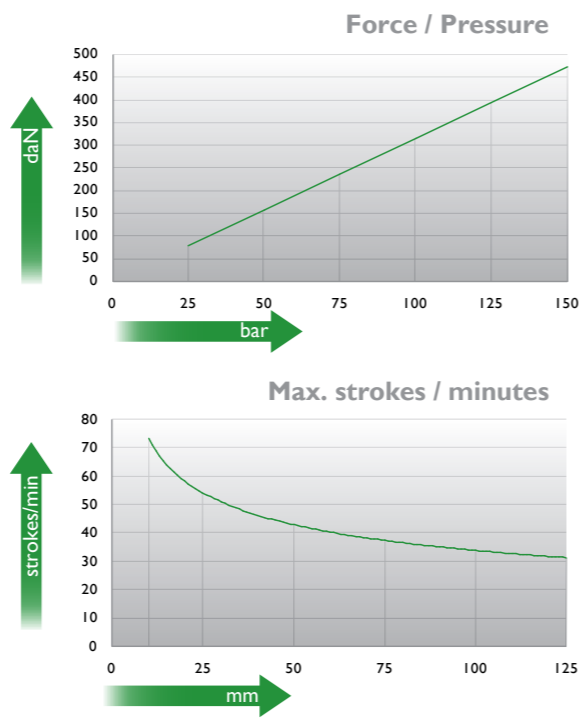
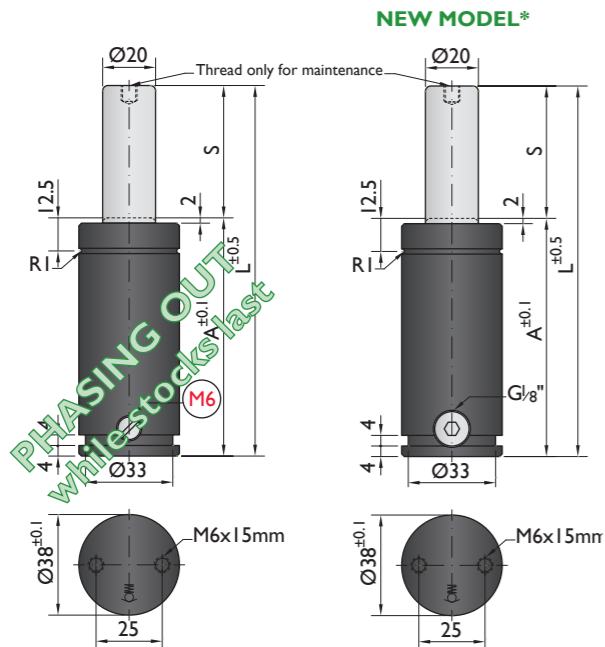

Ordering example: 4 x NR-500-125

Order No.	S <sup>(1)</sup> mm	L mm	A mm	F <sub>0</sub> <sup>(2)</sup> daN	F daN	kg
NR-500-10	10	60	50		690	0.34
NR-500-13	13	66	53		690	0.35
NR-500-16	16	72	56		700	0.37
NR-500-19	19	78	59		700	0.38
NR-500-25	25	90	65		700	0.40
NR-500-32	32	104	72		710	0.42
NR-500-38	38	116	78	470	710	0.45
NR-500-50	50	140	90		710	0.50
NR-500-63	63	166	103		720	0.54
NR-500-75	75	190	115		720	0.58
NR-500-80	80	200	120		720	0.60
NR-500-100	100	240	140		720	0.69
NR-500-125	125	290	165		720	0.78

(1) other strokes under request

(2) alternative forces upon request

	Pressure medium	N <sub>2</sub>	Working temperature	0-80°C	Min. security stroke	10%
	Max. Charging pressure	150 bar	Temperature related force increase	+0.34%/°C	Repair Kit	KIT NR-500
	Min. Charging pressure	25 bar	Max. working speed	1.6 m/s	Linkable	G1/8"

### Mounting possibilities

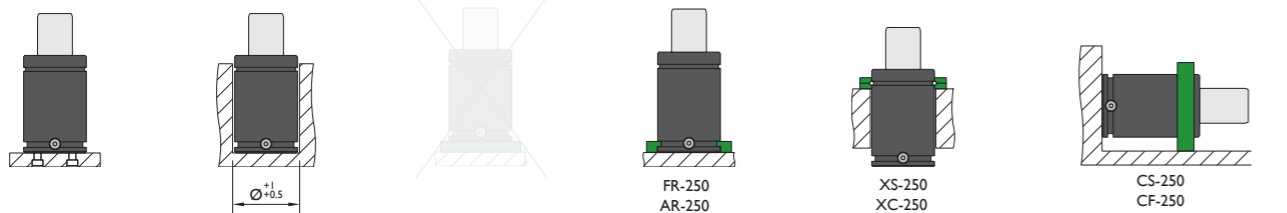

Flange must not support spring's force

## Flanges

**FR-250**

**AR-250**

**XS-250**

**XC-250**

**PR-250**

**CS-250**

**CF-250**

Flange must not support spring's force

Flange must not support spring's force

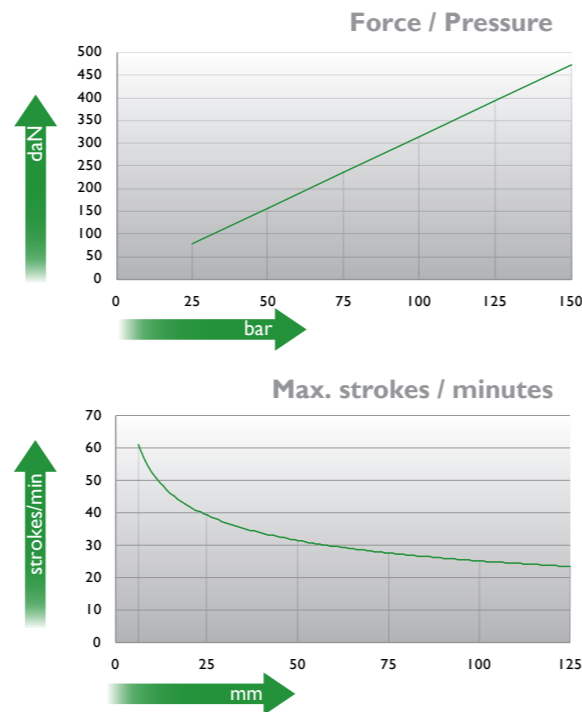
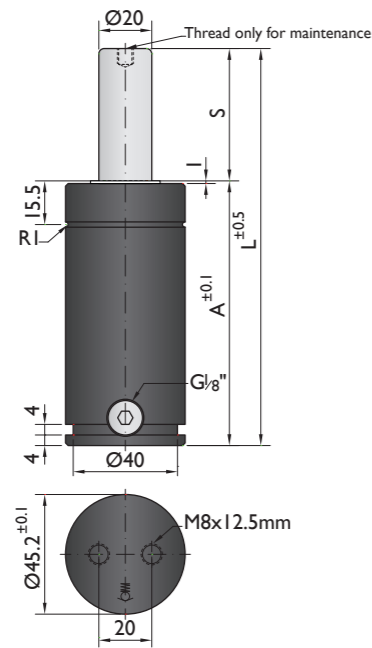

Ordering example: 4 x KH-500-125

Order No.	S <sup>(1)</sup> mm	L mm	A mm	F <sub>0</sub> <sup>(2)</sup> daN	F daN	kg
KH-500-13	12.7	75.4	62.7	470	600	0.55
KH-500-19	19	88	69		610	0.59
KH-500-25	25	100	75		620	0.63
KH-500-38	38.1	126.2	88.1		620	0.71
KH-500-50	50	150	100		630	0.80
KH-500-63	63.5	177	113.5		640	0.87
KH-500-80	80	210	130		660	0.97
KH-500-100	100	250	150		660	1.11
KH-500-125	125	300	175	660	1.25	

<sup>(1)</sup> other strokes under request

<sup>(2)</sup> alternative forces upon request



Pressure medium	N <sub>2</sub>	Working temperature	0-80°C	Min. security stroke	10%
Max. Charging pressure	150 bar	Temperature related force increase	+0.34%/°C	Repair Kit	KIT KH-500
Min. Charging pressure	25 bar	Max. working speed	1.6 m/s	Linkable	G1/8"

### Mounting possibilities

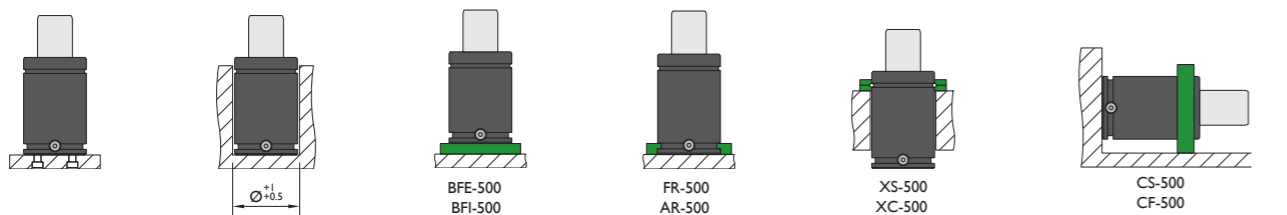

Flange must not support spring's force

## Flanges

### BFE-500

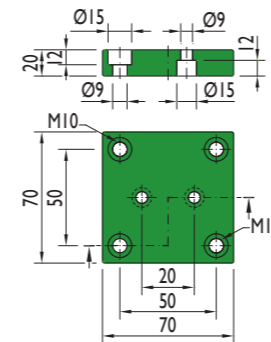

### BFI-500

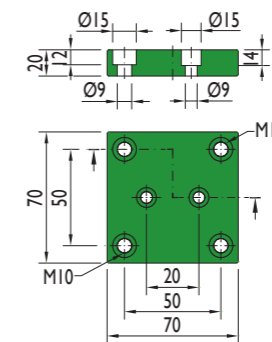

### FR-500

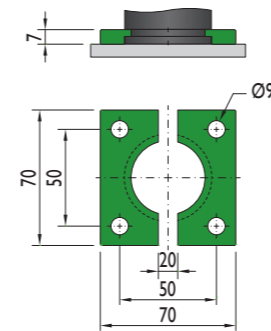

### AR-500

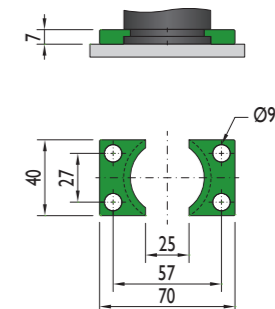

### XS-500

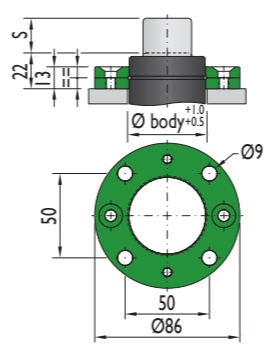

### XC-500

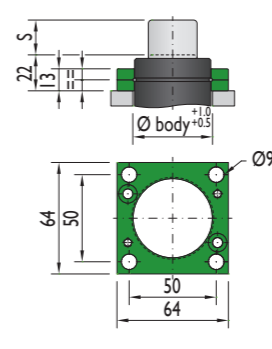

### PR-500

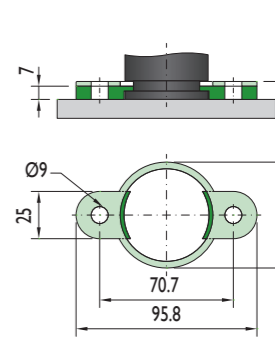

### CS-500

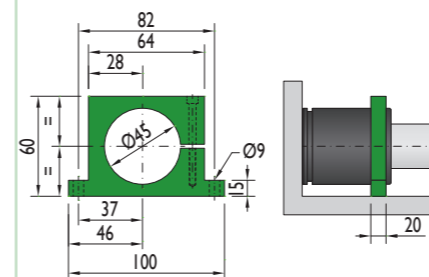

Flange must not support spring's force

### CF-500

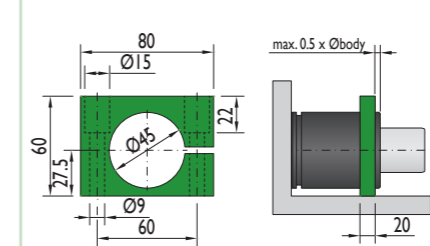

Flange must not support spring's force

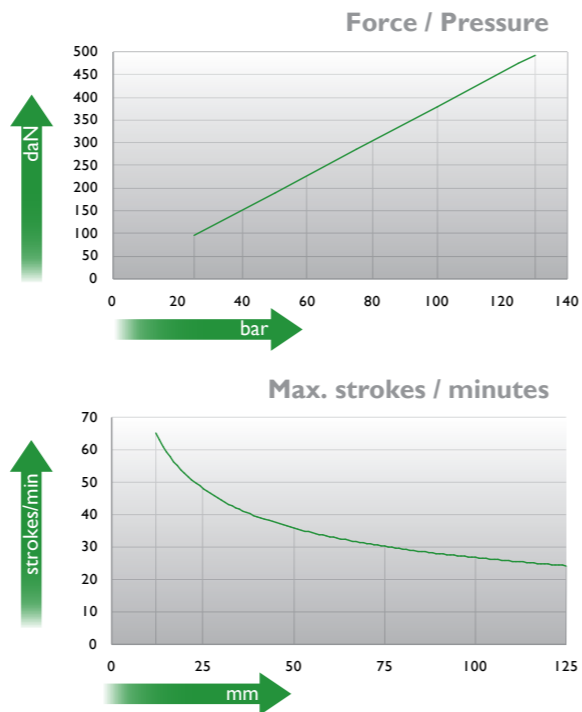
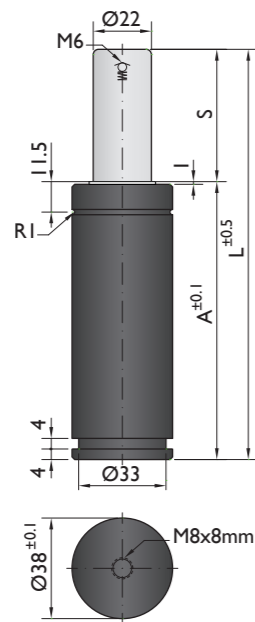

Ordering example: 4 x M-500-125

Order No.	S <sup>(1)</sup> mm	L mm	A mm	F <sub>0</sub> <sup>(2)</sup> daN	F daN	kg
M-500-12	12	79	67	500	650	0.43
M-500-15	15	85	70		670	0.45
M-500-25	25	105	80		700	0.48
M-500-38	38	131	93		730	0.55
M-500-50	50	155	105		740	0.58
M-500-63	63	186	123		740	0.66
M-500-80	80	220	140		740	0.72
M-500-100	100	260	160		750	0.80
M-500-125	125	310	185		750	0.91

<sup>(1)</sup> other strokes under request

<sup>(2)</sup> alternative forces upon request



Pressure medium	N <sub>2</sub>	Working temperature	0-80°C	Min. security stroke	10%
Max. Charging pressure	130 bar	Temperature related force increase	+0.34%/°C	Repair Kit	KIT M-500
Min. Charging pressure	25 bar	Max. working speed	1.6 m/s	Linkable	No

### Mounting possibilities

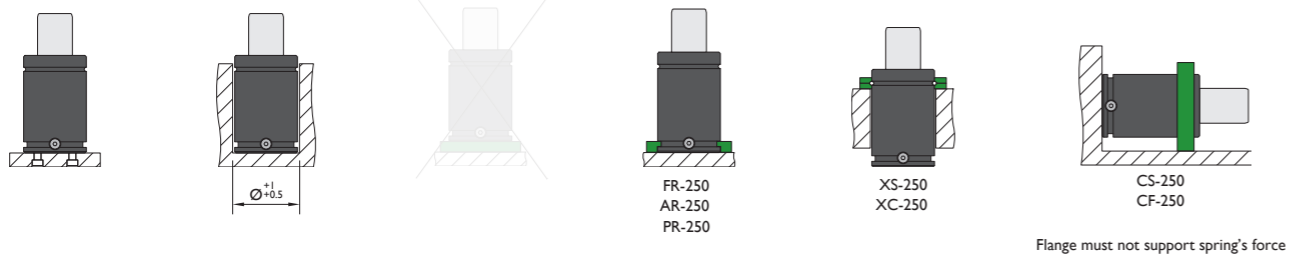

## Flanges

**FR-250**

**AR-250**

**XS-250**

**XC-250**

**PR-250**

**CS-250**

Flange must not support spring's force

**CF-250**

Flange must not support spring's force

Special mounts available on  
[www.nitrogas.com](http://www.nitrogas.com)

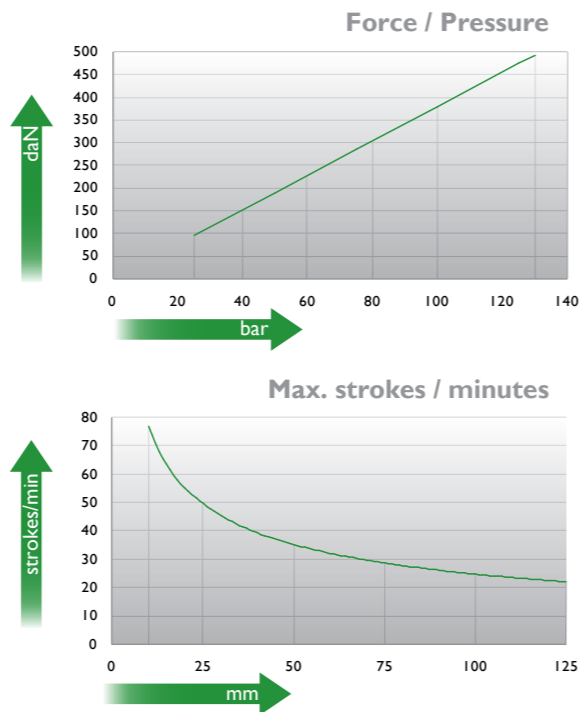
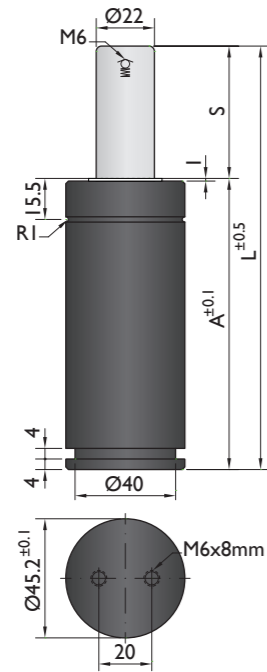

Ordering example: 4 x G-500-125

Order No.	S <sup>(1)</sup> mm	L mm	A mm	F <sub>0</sub> <sup>(2)</sup> daN	F daN	kg
G-500-12	12	84	72	500	610	0.66
G-500-25	25	110	85		670	0.77
G-500-38	38	136	98		700	0.88
G-500-50	50	160	110		720	0.91
G-500-63	63	186	123		730	1.00
G-500-80	80	220	140		740	1.12
G-500-100	100	260	160		750	1.45
G-500-125	125	310	185		800	1.85

<sup>(1)</sup> other strokes under request

<sup>(2)</sup> alternative forces upon request



Pressure medium	N <sub>2</sub>	Working temperature	0-80°C	Min. security stroke	10%
Max. Charging pressure	130 bar	Temperature related force increase	+0.34%/°C	Repair Kit	KIT G-500
Min. Charging pressure	25 bar	Max. working speed	1.6 m/s	Linkable	No

### Mounting possibilities

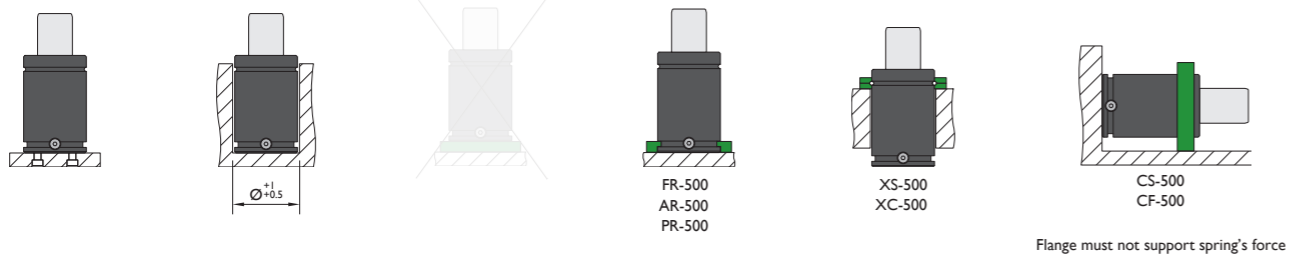

## Flanges

**FR-500**

VDI ISO

**AR-500**

VDI ISO

**XS-500**

ISO

**XC-500**

VDI ISO

**PR-500**

VDI ISO

**CS-500**

VDI

**CF-500**

VDI

Special mounts available on  
[www.nitrogas.com](http://www.nitrogas.com)





CNOMO  
EM24.54.700

PSA  
E24.54.815.G

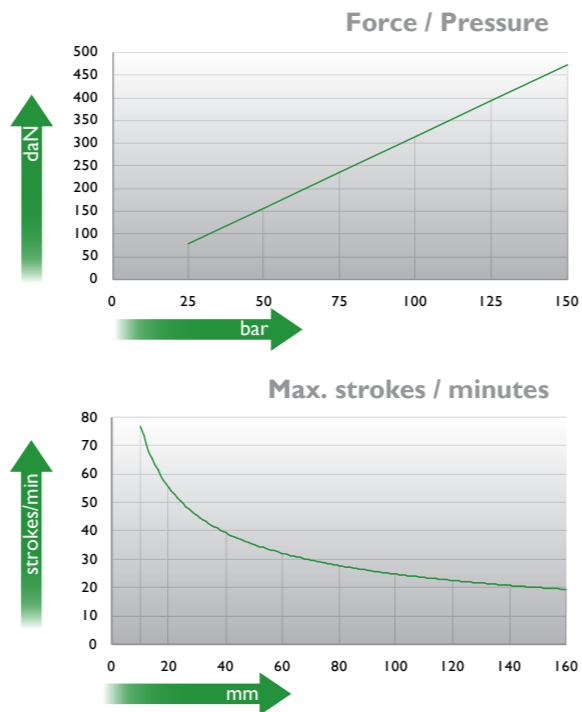
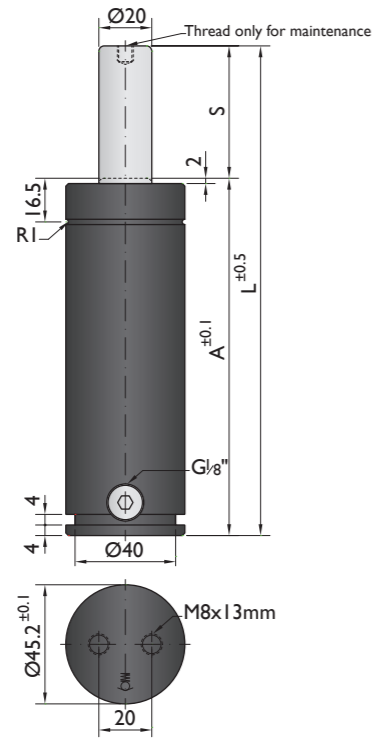

Ordering example: 4 x CN-500-125

Order No.	S <sup>(1)</sup> mm	L mm	A mm	F <sub>0</sub> <sup>(2)</sup> daN	F daN	kg
CN-500-13	12.7	110.4	97.7		540	0.73
CN-500-25	25	135	110		580	0.87
CN-500-38	38.1	161.2	123.1		610	0.96
CN-500-50	50	185	135		620	1.06
CN-500-63	63.5	212	148.5	470	630	1.18
CN-500-80	80	245	165		650	1.34
CN-500-100	100	285	185		670	1.50
CN-500-125	125	335	210		680	1.72
CN-500-160	160	405	245		690	2.03

<sup>(1)</sup> other strokes under request

<sup>(2)</sup> alternative forces upon request



Pressure medium	N <sub>2</sub>	Working temperature	0-80°C	Min. security stroke	10%
Max. Charging pressure	150 bar	Temperature related force increase	+0.34%/°C	Repair Kit	KIT CN-500
Min. Charging pressure	25 bar	Max. working speed	1.6 m/s	Linkable	GI 8/8"

### Mounting possibilities

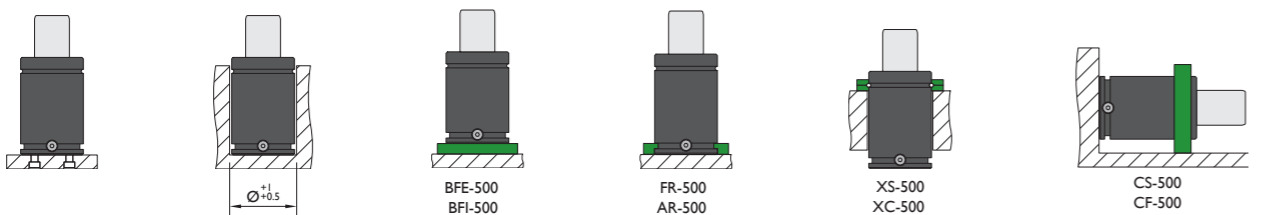

Flange must not support spring's force

## Flanges

### BFE-500

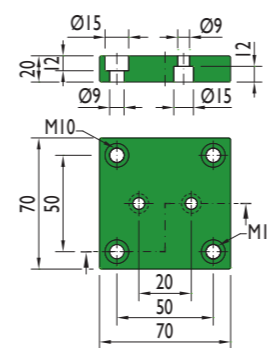

### BFI-500

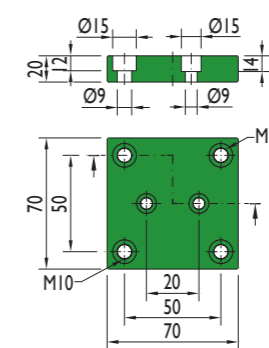

### FR-500

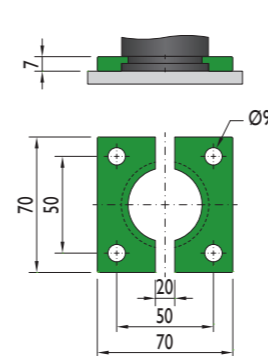

### AR-500

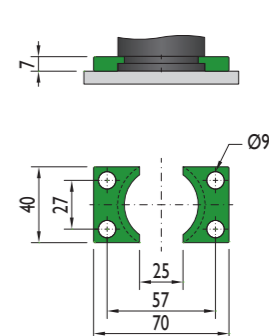

### XS-500

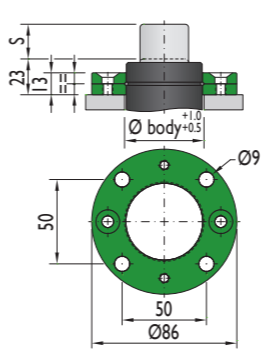

### XC-500

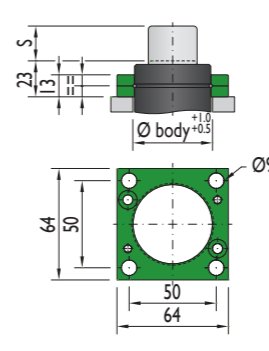

### PR-500

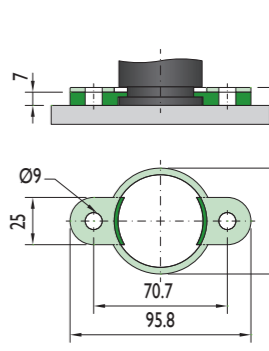

### CS-500

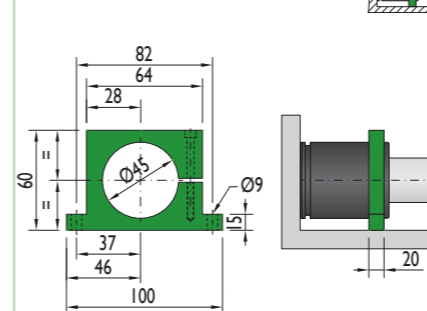

### CF-500

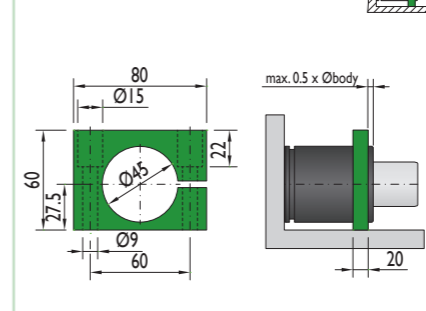

Flange must not support spring's force

Flange must not support spring's force