

Force 750 daN

Piston Rod Sealed gas springs

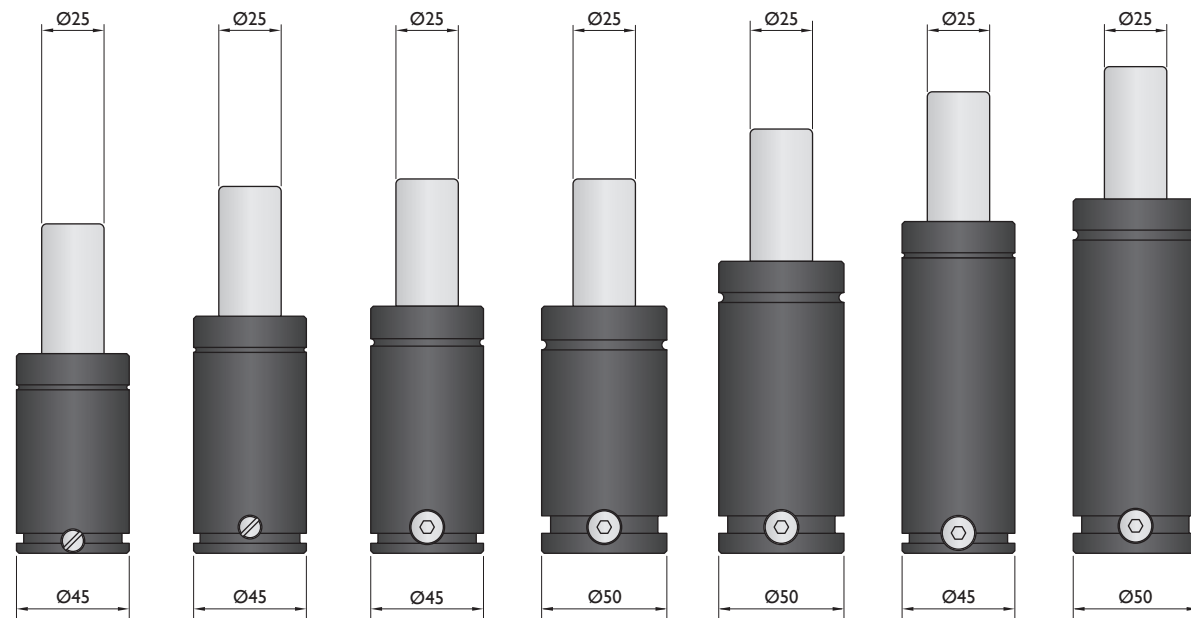
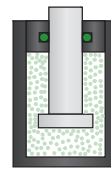

Model	KP-750	NR-750	K-750	KH-750	HG-750	HD-750	G-750
Initial F (daN)	740	740	740	740	740	740	740
L max (mm)	2xStroke+32	2xStroke+47	2xStroke+50	2xStroke+50	2xStroke+70	2xStroke+85	2xStroke+95
Stroke (mm)	10-125	10-125	12-125	12.7-125	12.5-200	13-200	12.7-300
			* other strokes under request				

Standards

PED	PED	PED	PED	PED	PED	PED
97/23/EC	97/23/EC	97/23/EC	97/23/EC	97/23/EC	97/23/EC	97/23/EC
ISO 11901	ISO 11901	ISO 11901	ISO 11901	ISO 11901	ISO 11901	ISO 11901
VDI 3003	VDI 3003	VDI 3003	VDI 3003	VDI 3003	VDI 3003	VDI 3003
CNOMO EM24.54.700	CNOMO EM24.54.700	CNOMO EM24.54.700	CNOMO EM24.54.700	CNOMO EM24.54.700	CNOMO EM24.54.700	CNOMO EM24.54.700

Force 750 daN

Bore Sealed gas springs

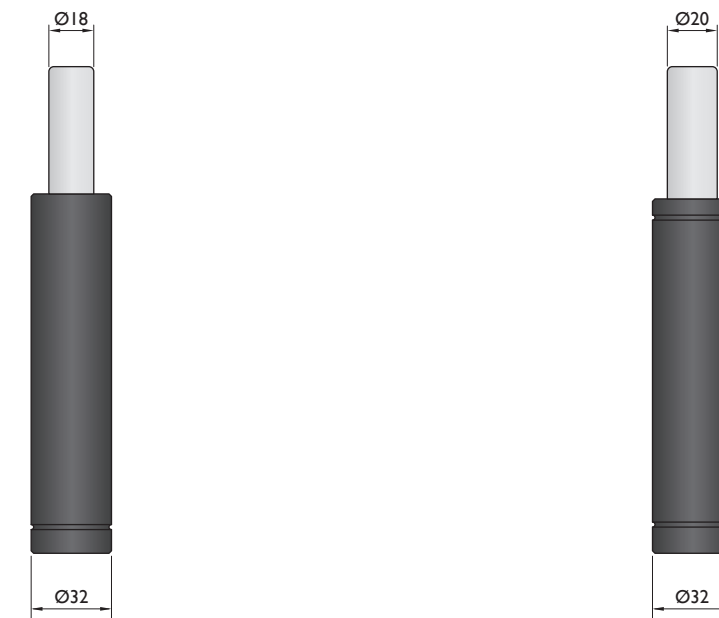

Model	T-750	TS-750
Initial F (daN)	740	740
L max (mm)	63-195	63-195
Stroke (mm)	6-50	6-50
	* other strokes under request	

Standards

PED	PED
97/23/EC	97/23/EC
ISO 11901	ISO 11901
VDI 3003	VDI 3003
CNOMO EM24.54.700	CNOMO EM24.54.700

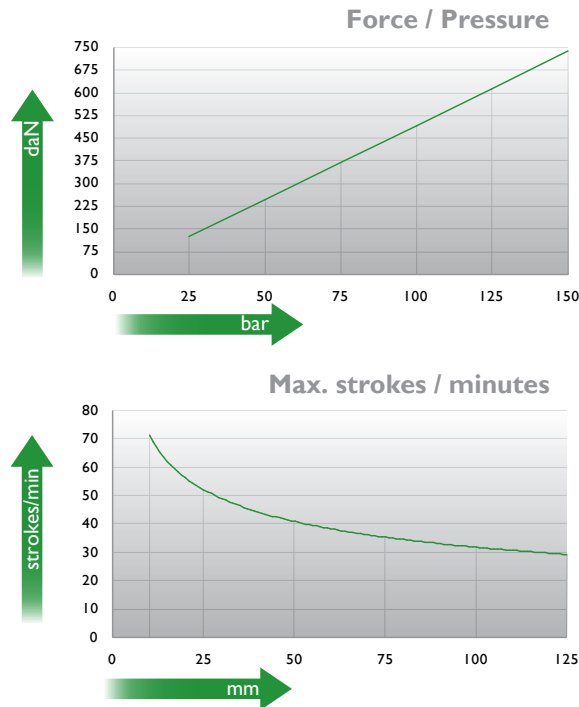
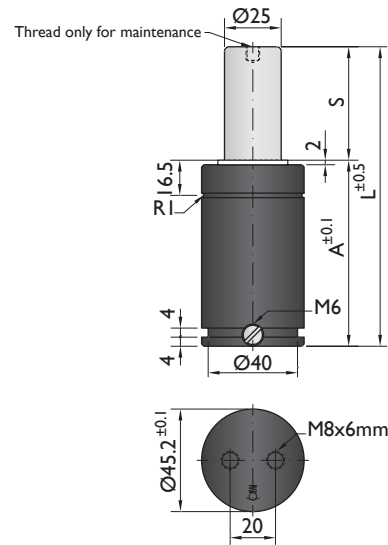

Ordering example: 4 x KP-750-125

Order No.	S ⁽¹⁾ mm	L mm	A mm	F ₀ ⁽²⁾ daN (20°C, 150 bar)	F daN	(3)	kg
KP-750-10	10	52	42		1000	No	0.33
KP-750-13	13	58	45		1000	No	0.41
KP-750-16	16	64	48		1000	No	0.42
KP-750-19	19	70	51		1100	No	0.44
KP-750-25	25	82	57		1100	No	0.45
KP-750-32	32	96	64		1100	No	0.50
KP-750-38	38	108	70	740	1100	No	0.58
KP-750-50	50	132	82		1100	Yes	0.67
KP-750-63	63	158	95		1100	Yes	0.75
KP-750-75	75	182	107		1100	Yes	0.84
KP-750-80	80	192	112		1100	Yes	0.87
KP-750-100	100	232	132		1100	Yes	1.01
KP-750-125	125	282	157		1100	Yes	1.18

other strokes under request

alternative forces upon request

ESK available for other strokes



Pressure medium	N ₂	Working temperature	0-80°C	Min. security stroke	10%
Max. Charging pressure	150 bar	Temperature related force increase	+0.34%/°C	Repair Kit	KIT KP-750
Min. Charging pressure	25 bar	Max. working speed	1.6 m/s	Linkable	M6

Mounting possibilities

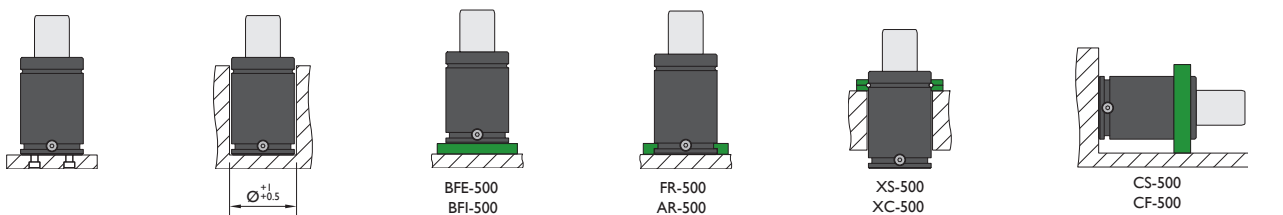

Flange must not support spring's force

Flanges

BFE-500

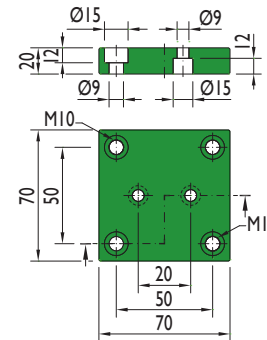

BFI-500

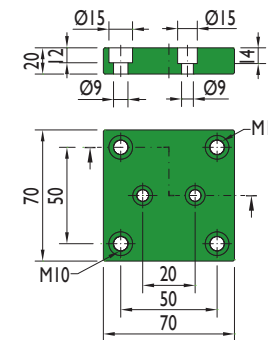

FR-500

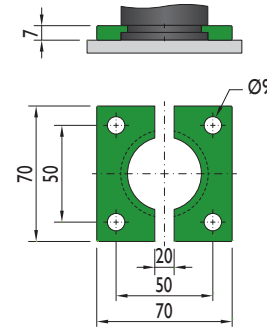

AR-500

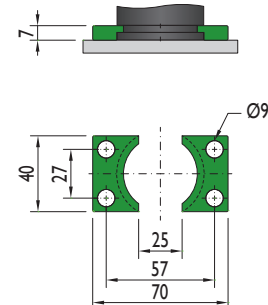

XS-500

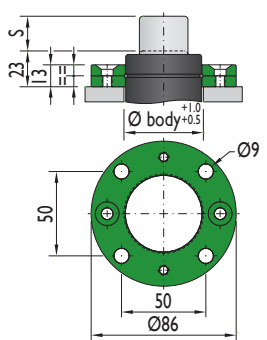

XC-500

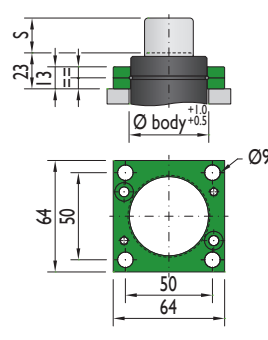

PR-500

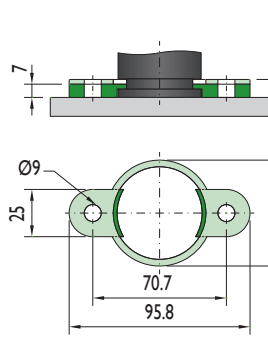

CS-500

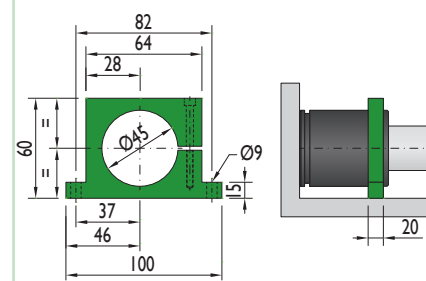

CF-500

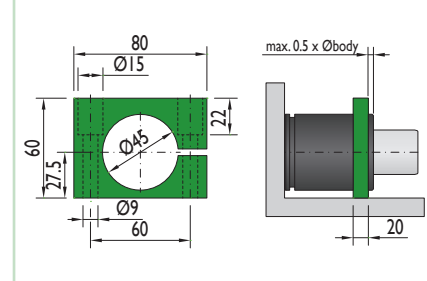

Flange must not support spring's force

Flange must not support spring's force



SMS DNH
3203N

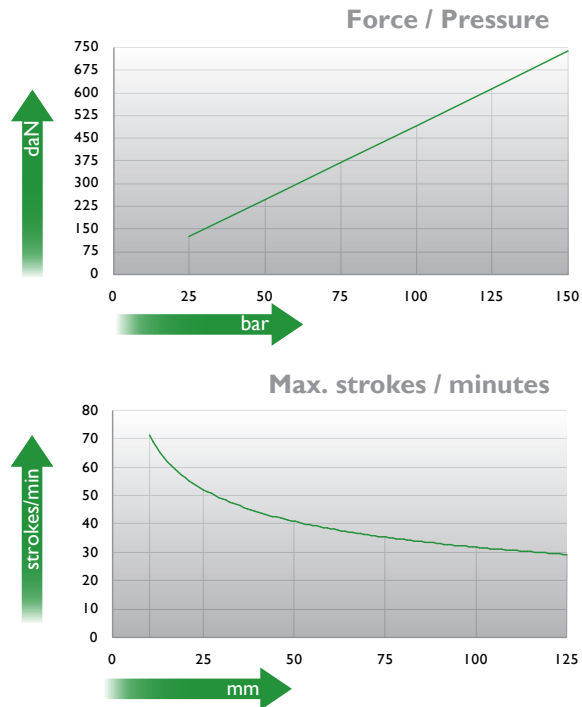
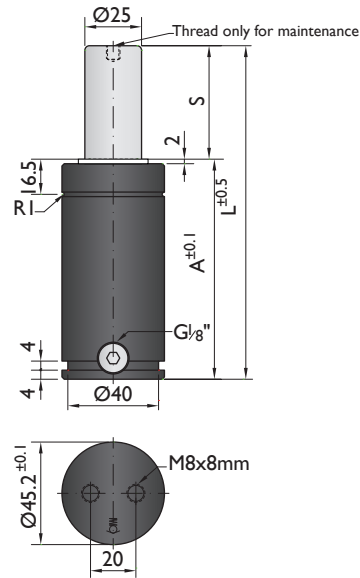

Ordering example: 4 x NR-750-125

Order No.	S ⁽¹⁾ mm	L mm	A mm	F ₀ ⁽²⁾ daN	F daN	(3)	kg
NR-750-10	10	67	57	740	1000	No	0.56
NR-750-13	13	73	60		1000	No	0.56
NR-750-16	16	79	63		1100	No	0.58
NR-750-19	19	85	66		1100	No	0.59
NR-750-25	25	97	72		1100	No	0.63
NR-750-32	32	111	79		1100	No	0.66
NR-750-38	38	123	85		1100	No	0.71
NR-750-50	50	147	97		1100	Yes	0.78
NR-750-63	63	173	110		1100	Yes	0.85
NR-750-75	75	197	122		1100	Yes	0.94
NR-750-80	80	207	127	1100	Yes	0.98	
NR-750-100	100	247	147	1100	Yes	1.10	
NR-750-125	125	297	172	1100	Yes	1.25	

other strokes⁽¹⁾ under request

alternative forces⁽²⁾ upon request

ESK available for other strokes⁽³⁾



Pressure medium	N ₂	Working temperature	0-80°C	Min. security stroke	10%
Max. Charging pressure	150 bar	Temperature related force increase	+0.34%/°C	Repair Kit	KIT NR-750
Min. Charging pressure	25 bar	Max. working speed	1.6 m/s	Linkable	M6

Mounting possibilities

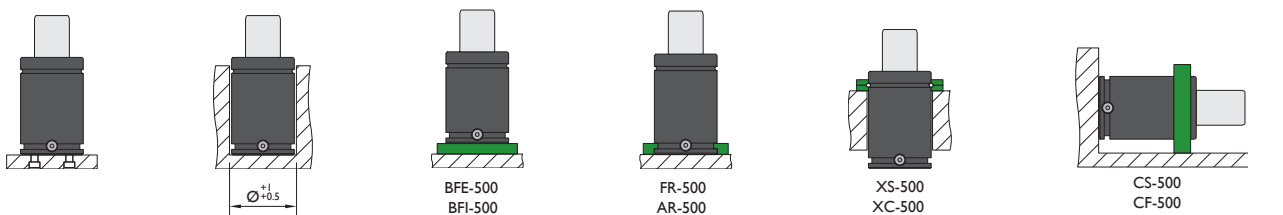

Flange must not support spring's force

Flanges

BFE-500

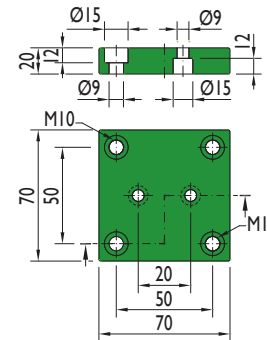

BFI-500

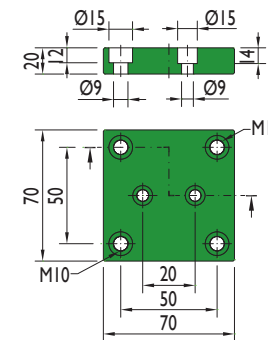

FR-500

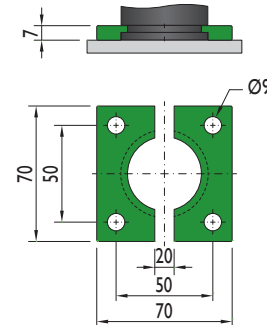

AR-500

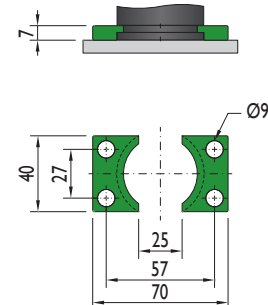

XS-500

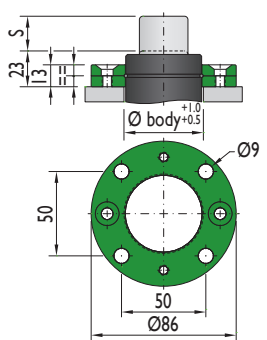

XC-500

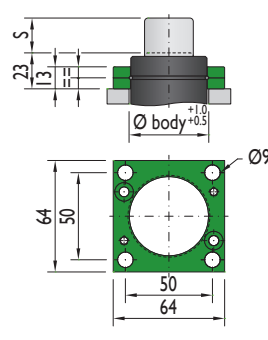

PR-500

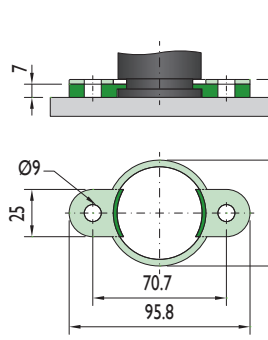

CS-500

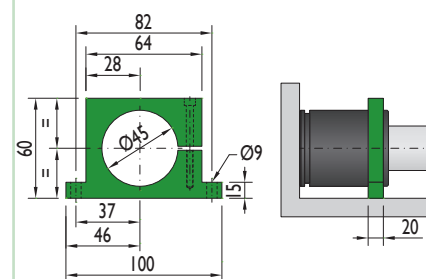

CF-500

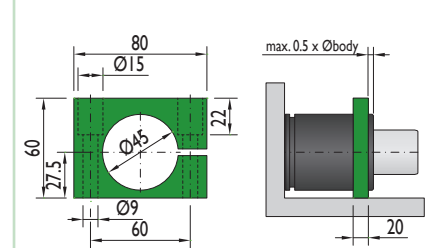

Flange must not support spring's force

Flange must not support spring's force

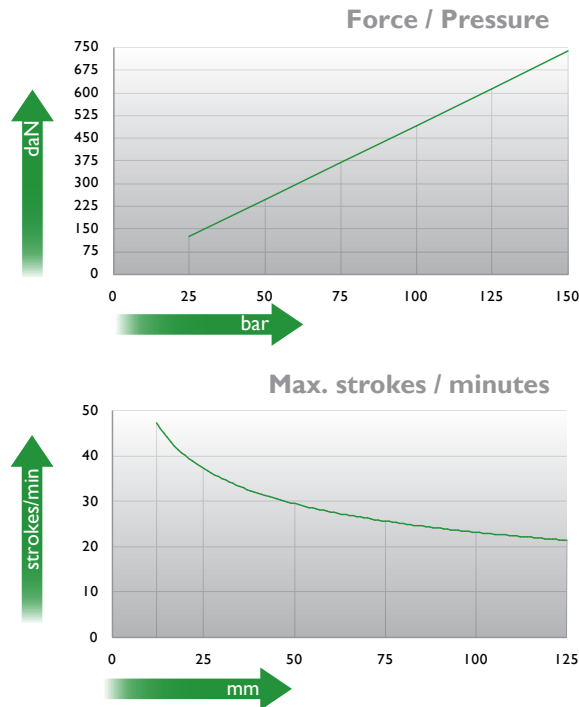
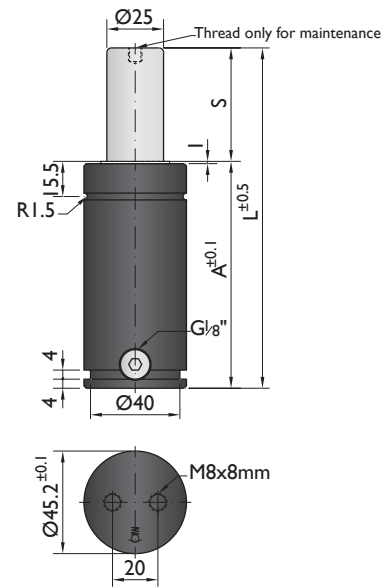

Ordering example: 4 x K-750-125

Order No.	S ⁽¹⁾ mm	L mm	A mm	F ₀ ⁽²⁾ daN	F daN	(3)	kg
K-750-12	12	74	62		1000	No	0.59
K-750-19	19	88	69		1100	No	0.69
K-750-25	25	100	75		1100	No	0.72
K-750-38	38	126	88		1200	No	0.80
K-750-50	50	150	100	740	1200	Yes	0.88
K-750-63	63	176	113		1200	Yes	0.90
K-750-80	80	210	130		1200	Yes	1.08
K-750-100	100	250	150		1200	Yes	1.23
K-750-125	125	300	175		1200	Yes	1.45

(1) other strokes under request

(2) alternative forces upon request

(3) ESK available for other strokes



Pressure medium	N ₂	Working temperature	0-80°C	Min. security stroke	10%
Max. Charging pressure	150 bar	Temperature related force increase	+0.34%/°C	Repair Kit	KIT K-750
Min. Charging pressure	25 bar	Max. working speed	1.6 m/s	Linkable	G1/8"

Mounting possibilities

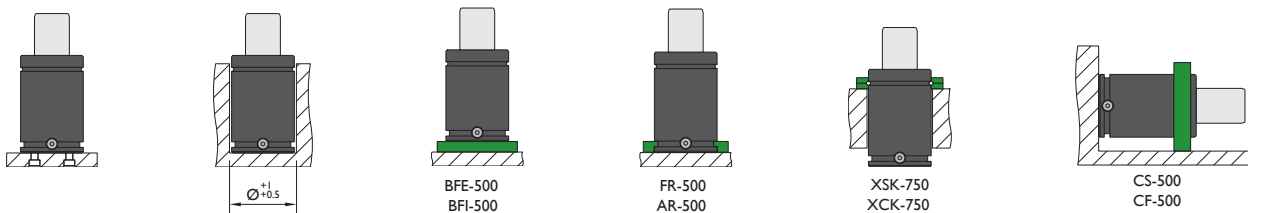

Flange must not support spring's force

Flanges

BFE-500

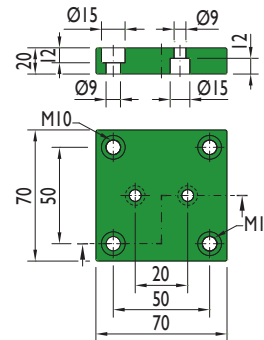

BFI-500

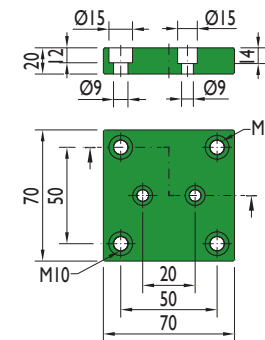

FR-500

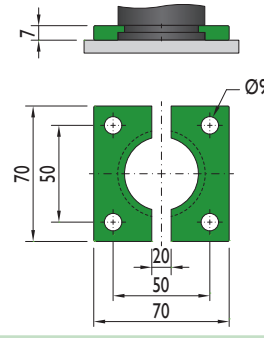

AR-500

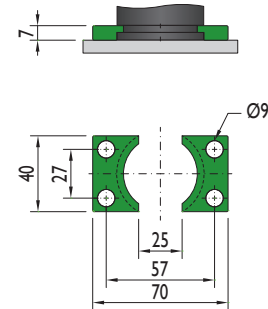

XSK-750

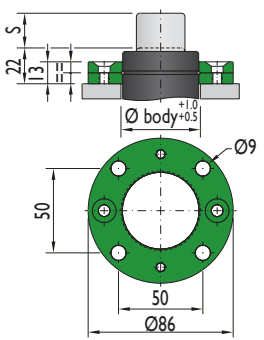

XCK-750

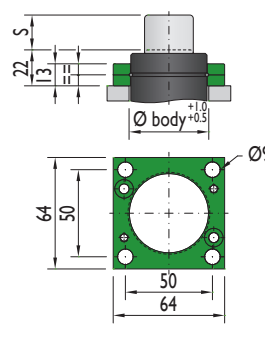

PR-500

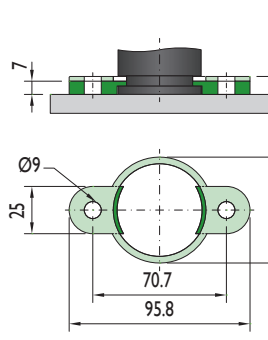

CS-500

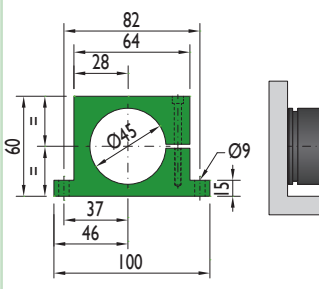

CF-500

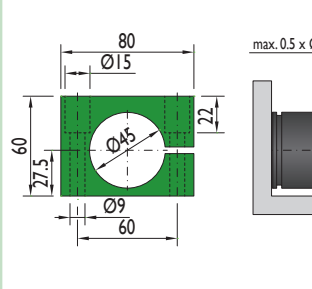

Flange must not support spring's force

Flange must not support spring's force

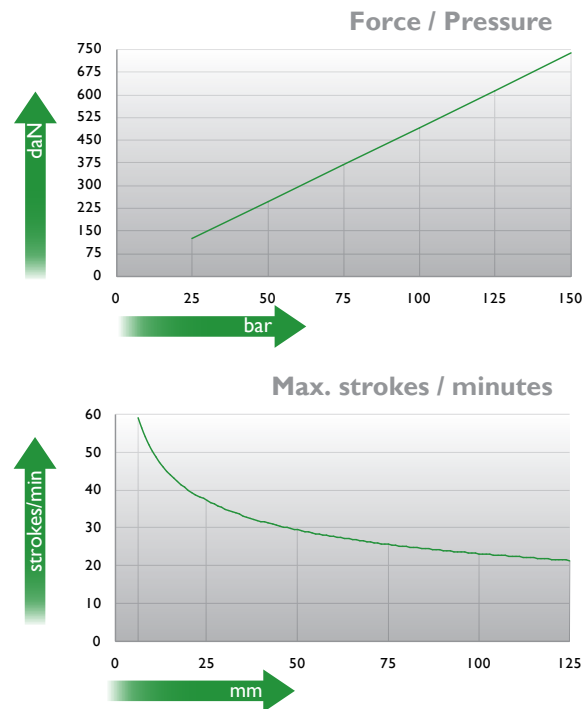
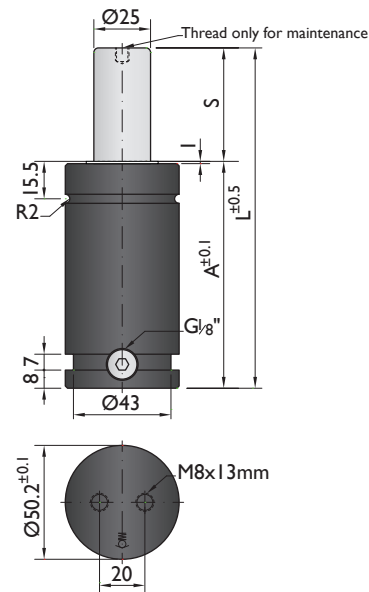

Ordering example: 4 x KH-750-125

Order No.	S ⁽¹⁾ mm	L mm	A mm	F ₀ ⁽²⁾ daN	F daN	(3)	kg
KH-750-13	12.7	75.4	62.7		1300	No	0.73
KH-750-19	19	88	69		1300	No	0.80
KH-750-25	25	100	75		1200	No	0.84
KH-750-38	38.1	126.2	88.1		1100	No	0.95
KH-750-50	50	150	100	740	1100	Yes	1.06
KH-750-63	63.5	177	113.5		1100	Yes	1.14
KH-750-80	80	210	130		1100	Yes	1.32
KH-750-100	100	250	150		1100	Yes	1.50
KH-750-125	125	300	175		1100	Yes	1.62

(1) other strokes under request

(2) alternative forces upon request

(3) ESK available for other strokes



Pressure medium	N ₂	Working temperature	0-80°C	Min. security stroke	10%
Max. Charging pressure	150 bar	Temperature related force increase	+0.34%/°C	Repair Kit	KIT KH-750
Min. Charging pressure	25 bar	Max. working speed	1.6 m/s	Linkable	GI/8"

Mounting possibilities

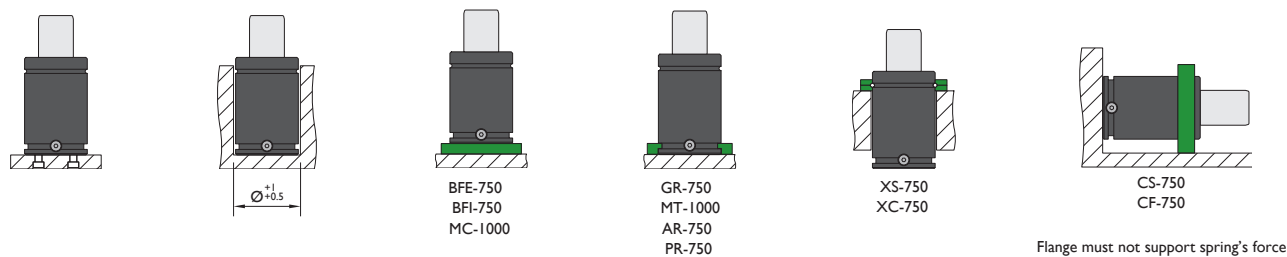

Flanges

BFE-750

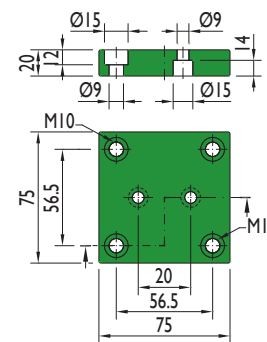

BFI-750

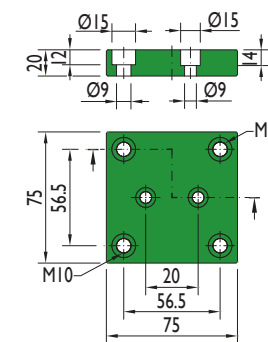

MC-1000

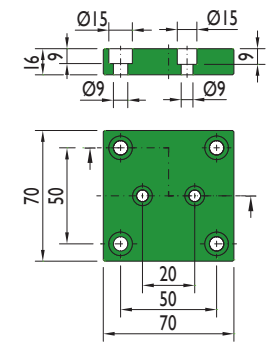

GR-750

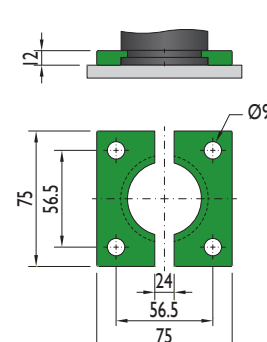

MT-1000

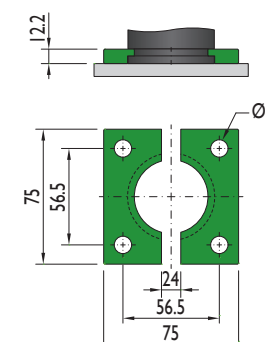

AR-750

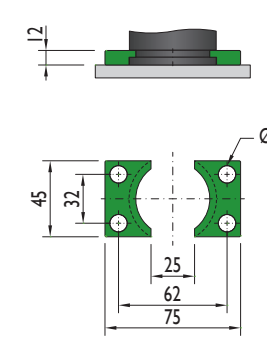

XS-750

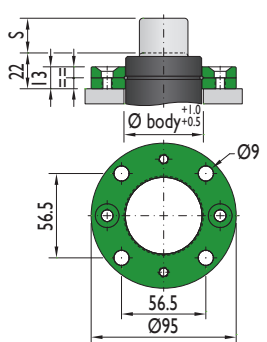

XC-750

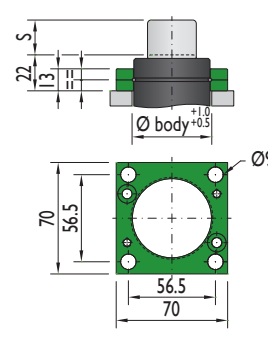

PR-750

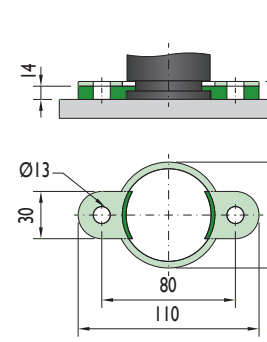

CS-750

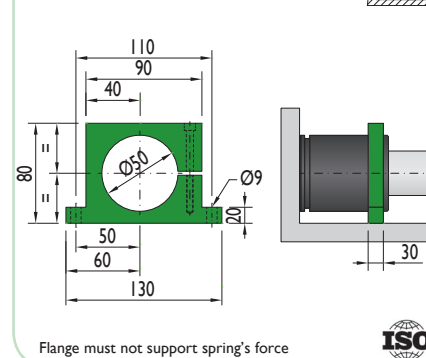

CF-750

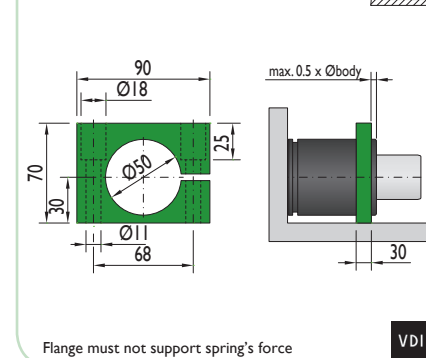

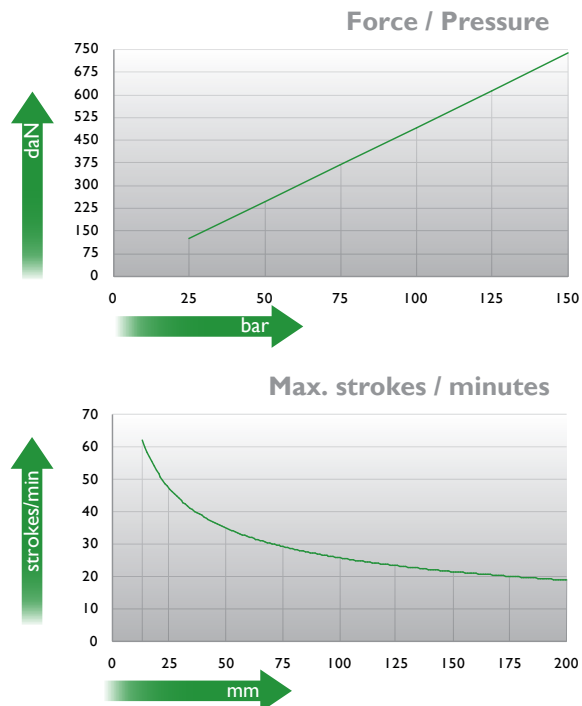
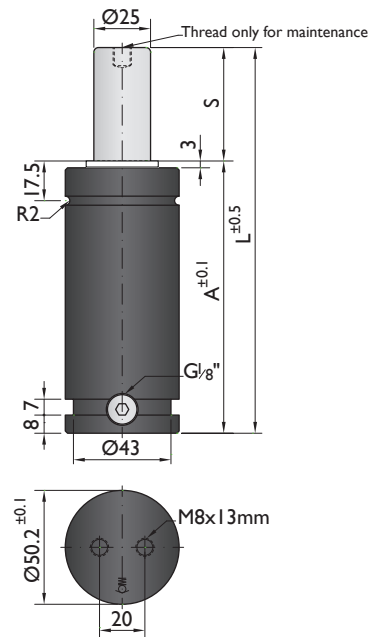

Ordering example: 4 x HG-750-125

Order No.	S ⁽¹⁾ mm	L mm	A mm	F ₀ ⁽²⁾ daN	F daN	⁽³⁾	kg
HG-750-13	12.5	95	82.5	740	1100	No	0.97
HG-750-25	25	120	95	740	1100	No	1.08
HG-750-38	37.5	145	107.5	740	1100	No	1.2
HG-750-50	50	170	120	740	1100	No	1.32
HG-750-63	62.5	195	132.5	740	1100	No	1.42
HG-750-80	80	230	150	740	1100	Yes	1.58
HG-750-100	100	270	170	740	1100	Yes	1.77
HG-750-125	125	320	195	740	1200	Yes	2.01
HG-750-160	160	390	230	740	1200	Yes	2.34
HG-750-200	200	470	270	740	1200	Yes	2.72

⁽¹⁾ other strokes under request

⁽²⁾ alternative forces upon request

⁽³⁾ ESK available for other strokes



Pressure medium	N ₂	Working temperature	0-80°C	Min. security stroke	10%
Max. Charging pressure	150 bar	Temperature related force increase	+0.34%/°C	Repair Kit	KIT HG-750
Min. Charging pressure	25 bar	Max. working speed	1.6 m/s	Linkable	G1/8"

Mounting possibilities

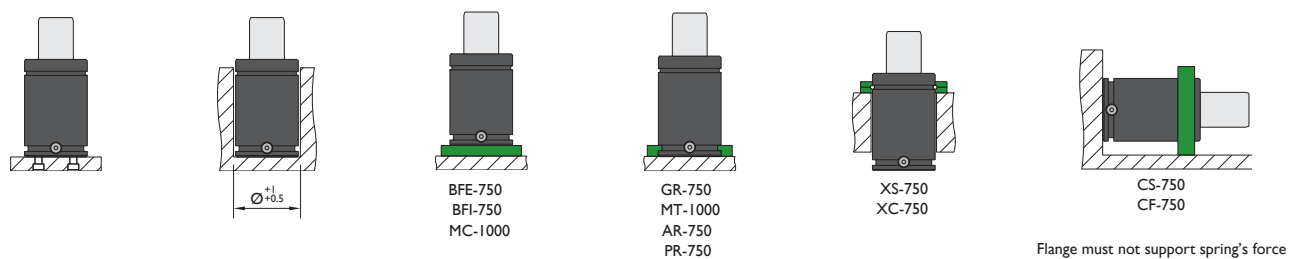

Flanges

BFE-750

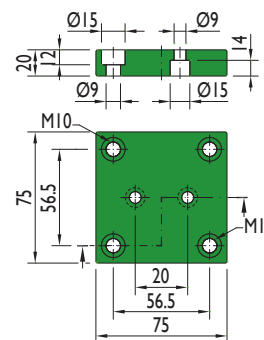

BFI-750

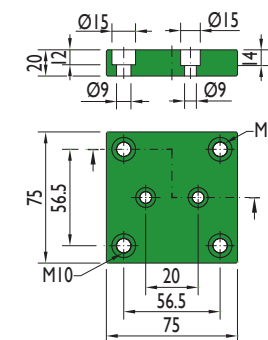

MC-1000

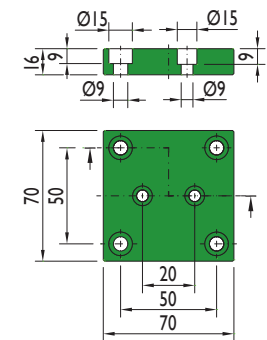

GR-750

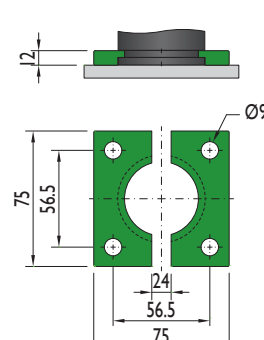

MT-1000

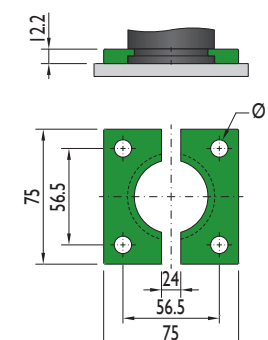

AR-750

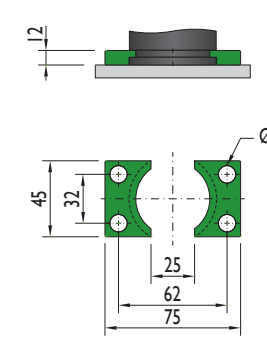

XS-750

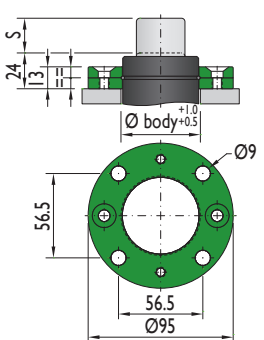

XC-750

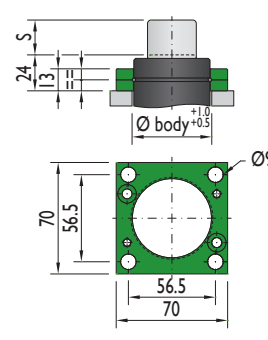

PR-750

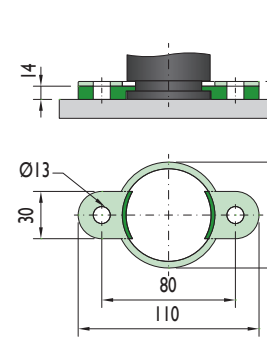

CS-750

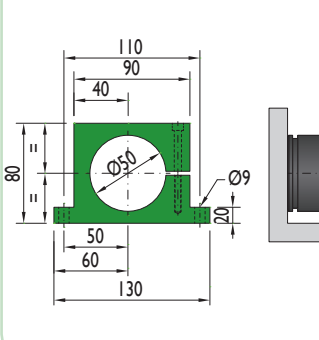

CF-750

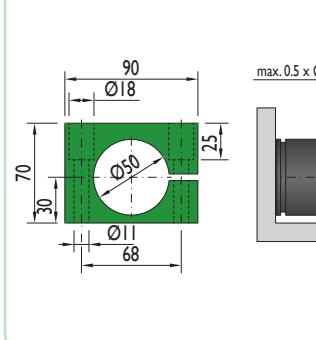

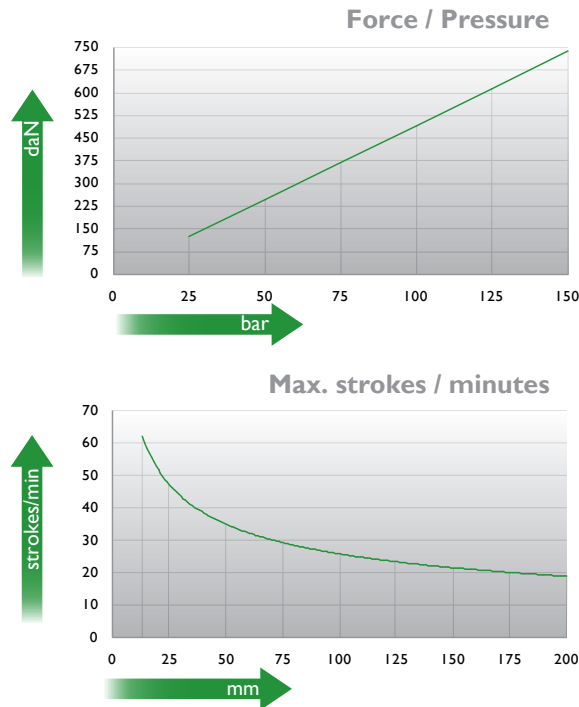
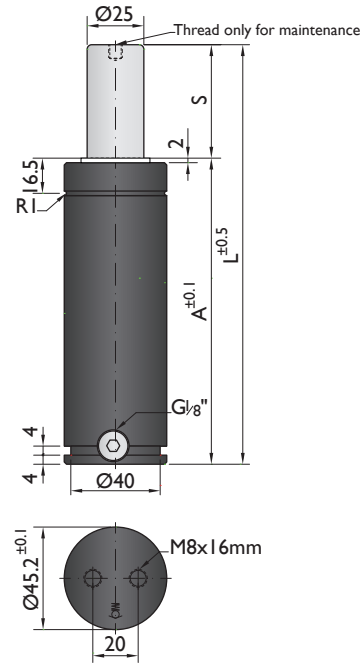

Ordering example: 4 x HD-750-125

Order No.	S ⁽¹⁾ mm	L mm	A mm	F ₀ ⁽²⁾ daN	F daN	ESK ⁽³⁾	kg
HD-750-13	13	111	98	740	1100	No	0.80
HD-750-25	25	135	110	740	1100	No	0.93
HD-750-38	38	161	123	740	1100	No	1.10
HD-750-50	50	185	135	740	1200	No	1.17
HD-750-63	63	211	148	740	1200	No	1.30
HD-750-80	80	245	165	740	1200	Yes	1.45
HD-750-100	100	285	185	740	1200	Yes	1.65
HD-750-125	125	335	210	740	1200	Yes	1.80
HD-750-160	160	405	245	740	1300	Yes	1.84
HD-750-200	200	485	285	740	1300	Yes	2.23

⁽¹⁾ other strokes under request

⁽²⁾ alternative forces upon request

⁽³⁾ ESK available for other strokes



Pressure medium	N ₂	Working temperature	0-80°C	Min. security stroke	10%
Max. Charging pressure	150 bar	Temperature related force increase	+0.34%/°C	Repair Kit	KIT HD-750
Min. Charging pressure	25 bar	Max. working speed	1.6 m/s	Linkable	GI/8"

Mounting possibilities

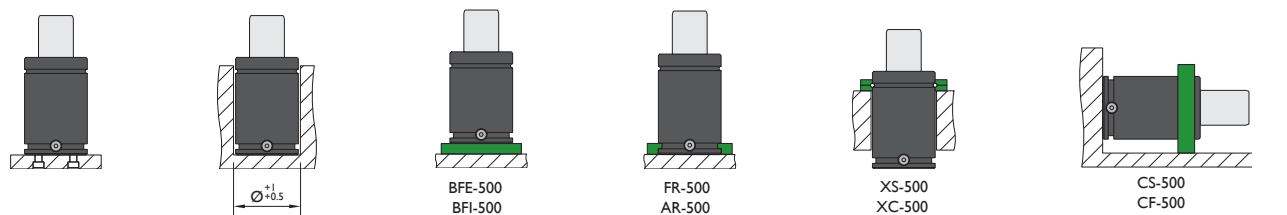

Flange must not support spring's force

Flanges

BFE-500

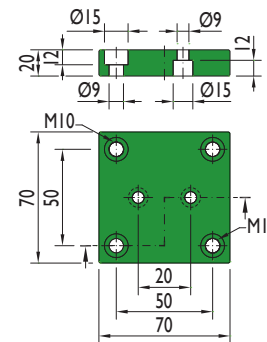

BFI-500

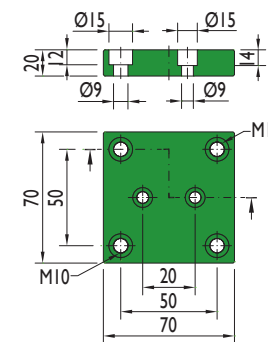

FR-500

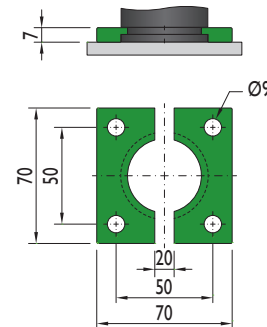

AR-500

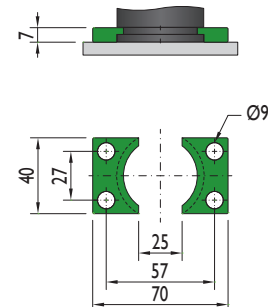

XS-500

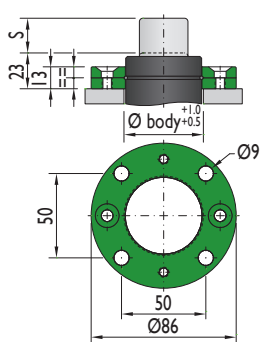

XC-500

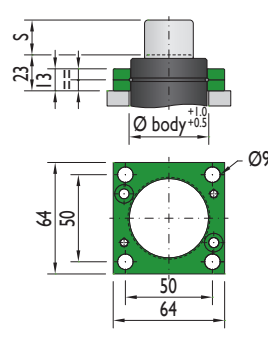

PR-500

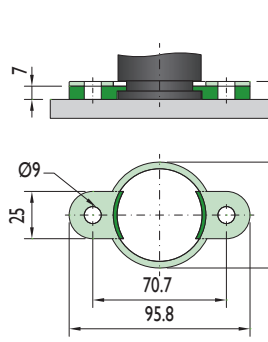

CS-500

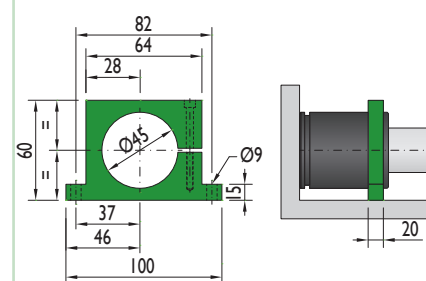

CF-500

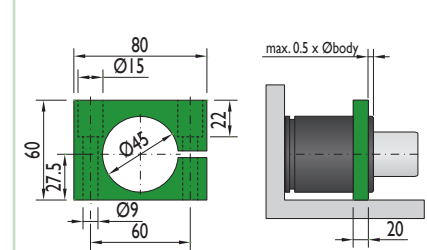

Flange must not support spring's force

Flange must not support spring's force



CNOMO
EM24.54.700

PSA
E24.54.815.G

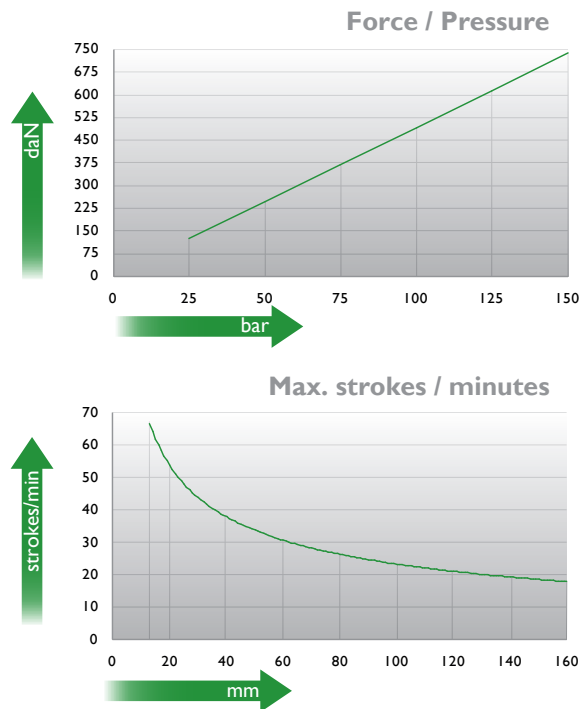
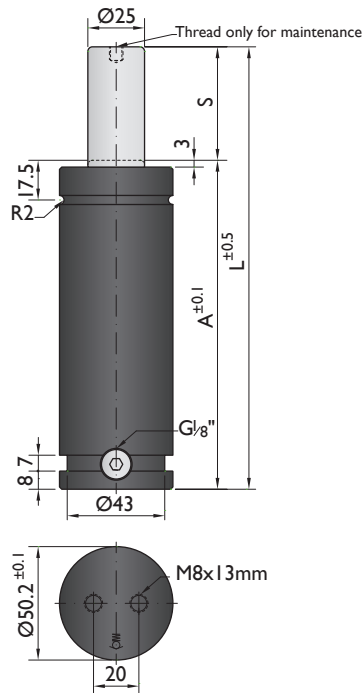

Ordering example: 4 x G-750-125

Order No.	S ⁽¹⁾ mm	L mm	A mm	F ₀ daN	F daN	(3)	kg
G-750-13	12.7	120.4	107.7	740	800	No	1.20
G-750-25	25	145	120		900	No	1.21
G-750-38	38.1	171.2	133.1		900	No	1.38
G-750-50	50	195	145		900	No	1.50
G-750-63	63.5	222	158.5		900	No	1.57
G-750-80	80	255	175		1000	No	1.63
G-750-100	100	295	195		1000	Yes	1.85
G-750-125	125	345	220		1000	Yes	2.01
G-750-160	160	415	255		1100	Yes	3.80
G-750-200	200	495	295		1100	Yes	3.90
G-750-250	250	595	345	1200	Yes	4.00	
G-750-300	300	695	395	1200	Yes	4.20	

(1) other strokes under request (2) alternative forces upon request (3) ESK available for other strokes



Pressure medium	N ₂	Working temperature	0-80°C	Min. security stroke	10%
Max. Charging pressure	150 bar	Temperature related force increase	+0.34%/°C	Repair Kit	KIT G-750
Min. Charging pressure	25 bar	Max. working speed	1.6 m/s	Linkable	G1/8"

Mounting possibilities

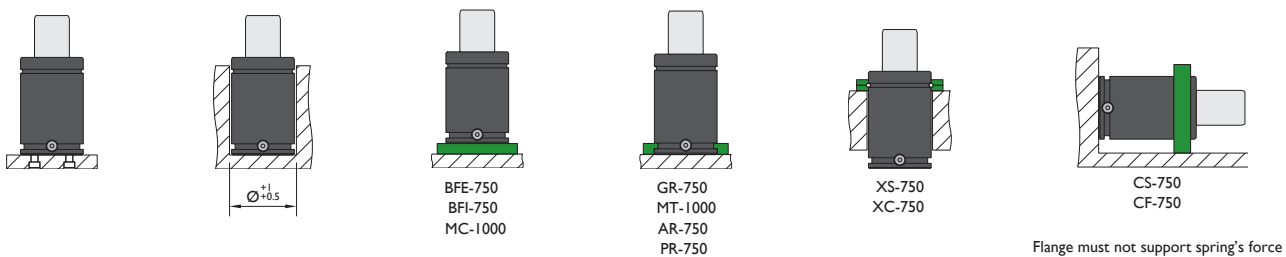

Flanges

BFE-750

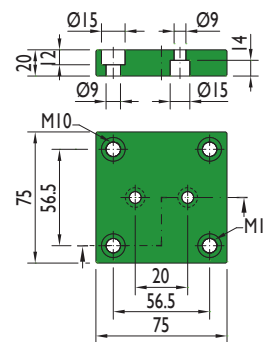

BFI-750

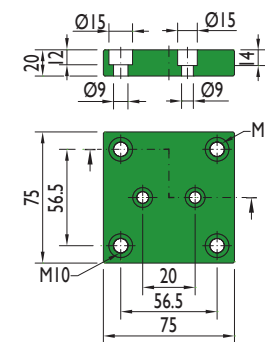

MC-1000

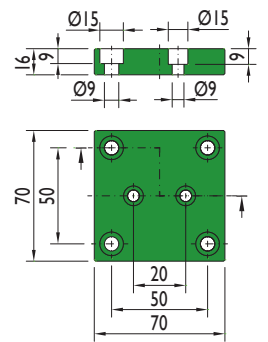

GR-750

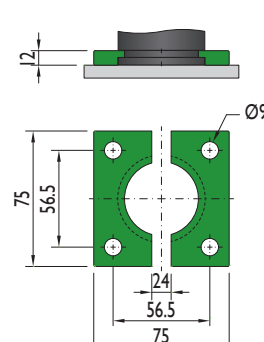

MT-1000

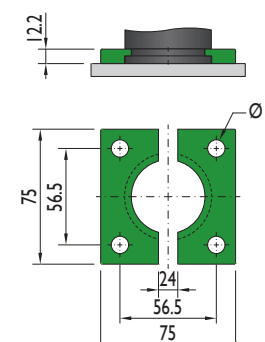

AR-750

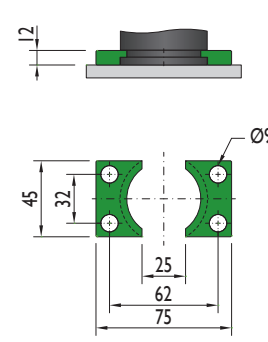

XS-750

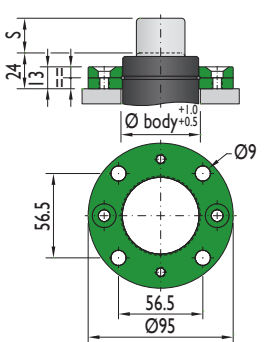

XC-750

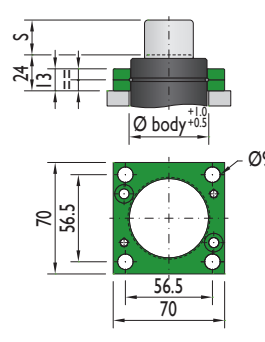

PR-750

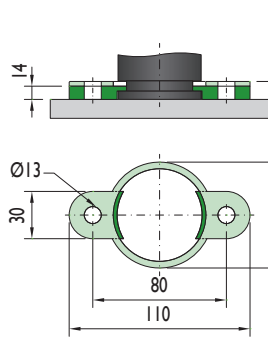

CS-750

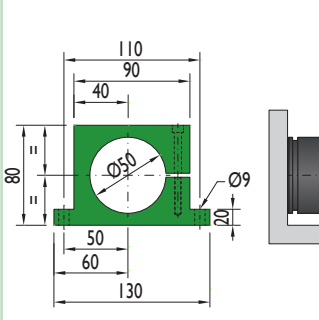

CF-750

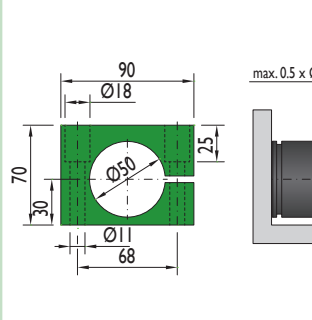

Special mounts available on
www.nitrogas.com

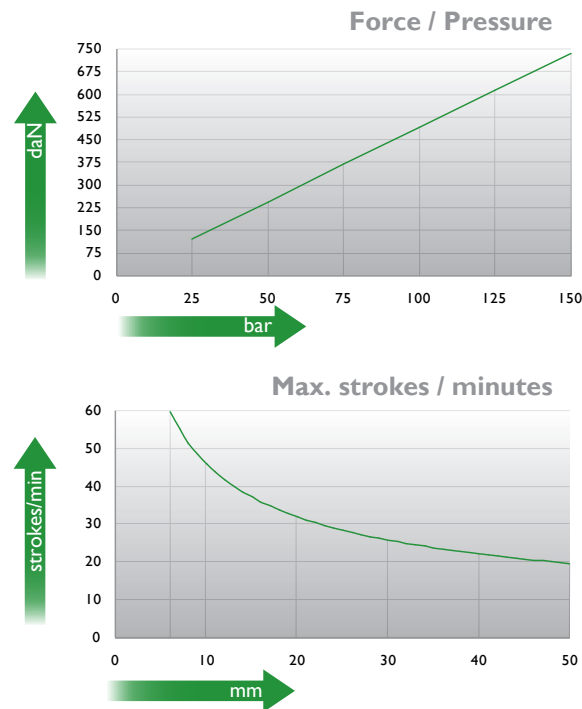
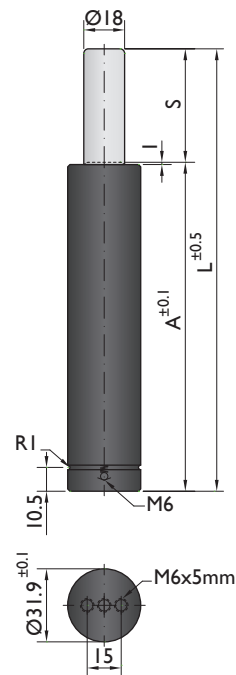

Ordering example: 4 x T-750-50

Order No.	S ⁽¹⁾ mm	L mm	A mm	F ₀ ⁽²⁾ daN	F daN	kg
T-750-6	6	63	57	740	1200	0.27
T-750-10	10	75	65		1200	0.32
T-750-16	16	93	77		1200	0.36
T-750-25	25	120	95	1300	0.47	
T-750-32	32	140	108	1300	0.48	
T-750-40	40	165	125	1300	0.55	
T-750-50	50	195	145	1300	0.63	

⁽¹⁾ other strokes under request

⁽²⁾ alternative forces upon request

Flanges



Pressure medium	N ₂	Working temperature	0-80°C	Min. security stroke	10%
Max. Charging pressure	150 bar	Temperature related force increase	+0.34%/°C	Repair Kit	Non-repairable
Min. Charging pressure	25 bar	Max. working speed	0.5 m/s	Linkable	No

Mounting possibilities

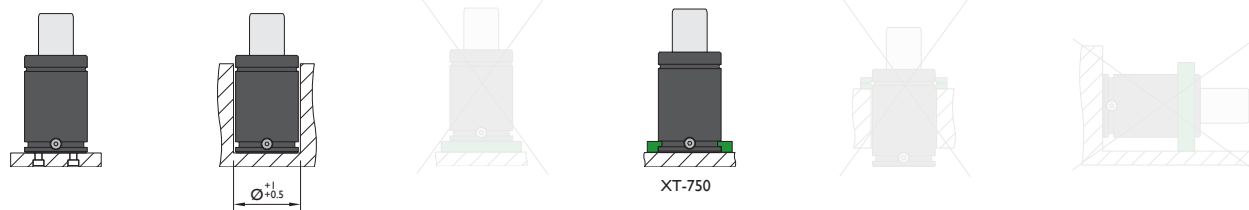

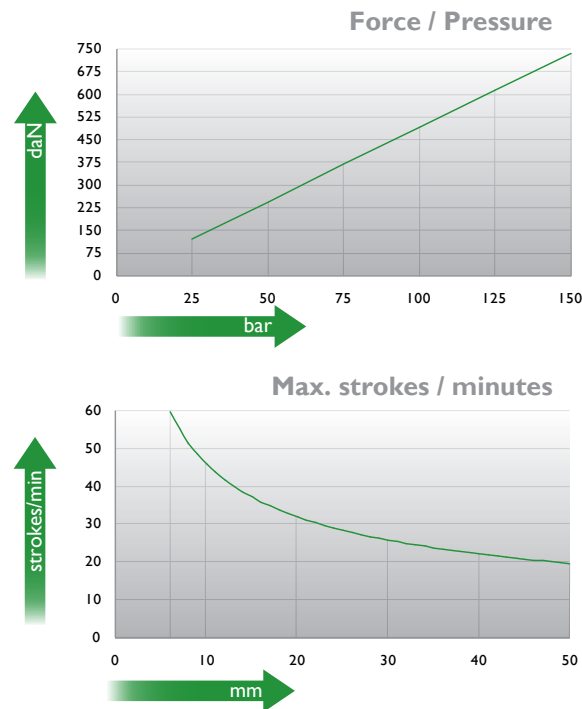
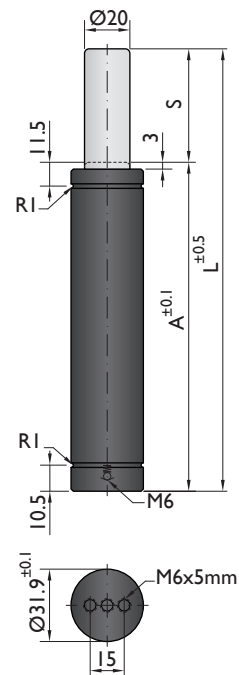

Ordering example: 4 x TS-750-50

Order No.	S ⁽¹⁾ mm	L mm	A mm	F ₀ ⁽²⁾ daN	F daN	kg
TS-750-6	6	63	57	740	1200	0.27
TS-750-10	10	75	65		1200	0.32
TS-750-16	16	93	77		1200	0.36
TS-750-25	25	120	95	1300	1300	0.47
TS-750-32	32	140	108		1300	0.48
TS-750-40	40	165	125		1300	0.55
TS-750-50	50	195	145		1300	0.63

⁽¹⁾ other strokes under request

⁽²⁾ alternative forces upon request



Pressure medium	N ₂	Working temperature	0-80°C	Min. security stroke	10%
Max. Charging pressure	150 bar	Temperature related force increase	+0.34%/°C	Repair Kit	Non-repairable
Min. Charging pressure	25 bar	Max. working speed	0.5 m/s	Linkable	No

Mounting possibilities

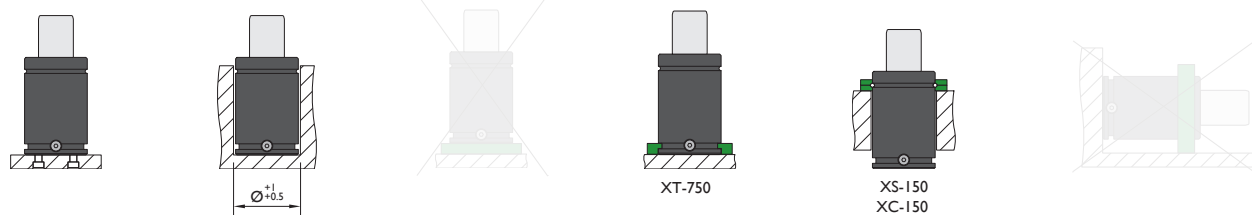

Flanges

XT-750

XS-150

XC-150