

Ordering example: 4 x K-1000-125

Order No.	S ⁽¹⁾ mm	L mm	A mm	F ₀ ⁽²⁾ daN (20°C, 140 bar)	F daN		kg
K-1000-12	12	74	62		1500	No	0.69
K-1000-19	19	88	69		1500	No	0.78
K-1000-25	25	100	75		1600	No	0.84
K-1000-38	38	126	88		1600	No	0.96
K-1000-50	50	150	100	990	1600	Yes	1.06
K-1000-63	63	176	113		1700	Yes	1.18
K-1000-80	80	210	130		1700	Yes	1.35
K-1000-100	100	250	150		1700	Yes	1.40
K-1000-125	125	300	175		1700	Yes	1.49

other strokes under request ⁽¹⁾

alternative forces upon request ⁽²⁾

ESK available for other strokes ⁽³⁾



Pressure medium	N ₂	Working temperature	0-80°C	Min. security stroke	10%
Max. Charging pressure	140 bar	Temperature related force increase	+0.34%/°C	Repair Kit	KIT K-1000
Min. Charging pressure	25 bar	Max. working speed	1.6 m/s	Linkable	G1/8"

Mounting possibilities

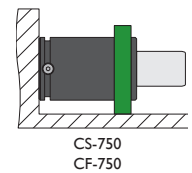
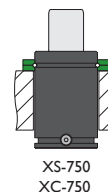
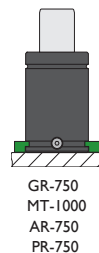
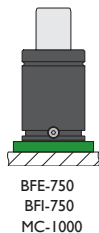
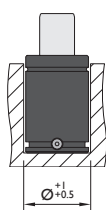
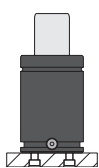

Flange must not support spring's force

Flanges

BFE-750

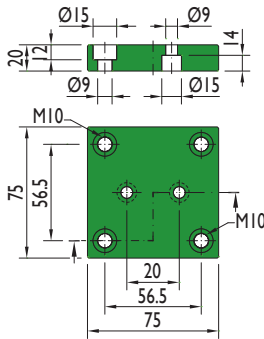

BFI-750

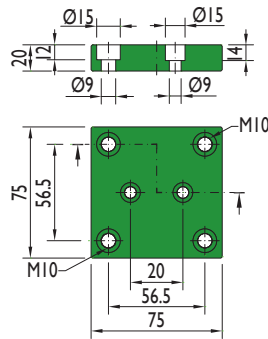

MC-1000

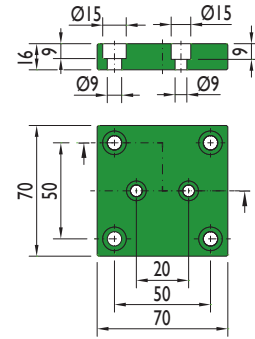

GR-750

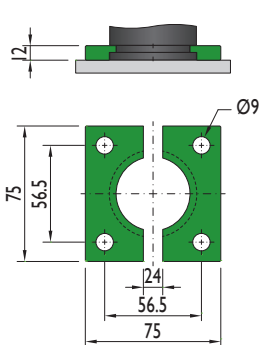

MT-1000

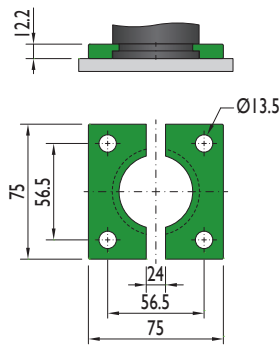

AR-750

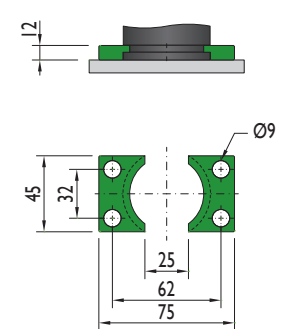

XS-750

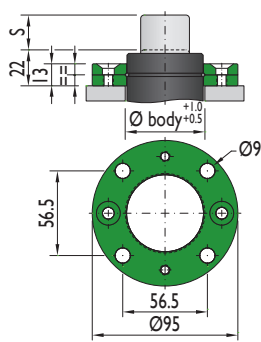

XC-750

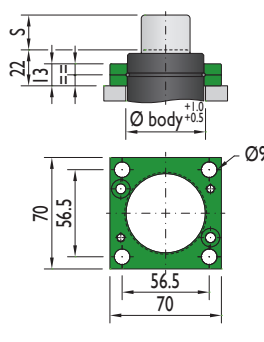

PR-750

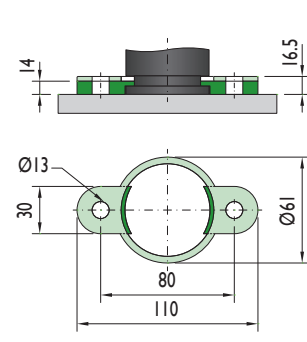

CS-750

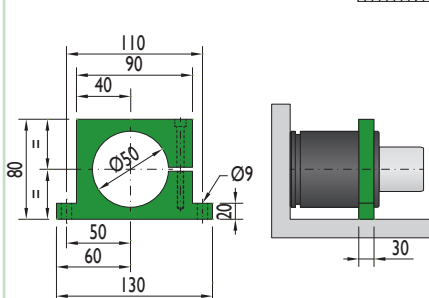

Flange must not support spring's force



CF-750

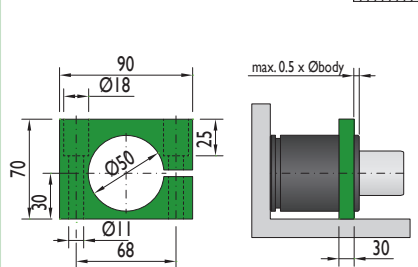

Flange must not support spring's force

