

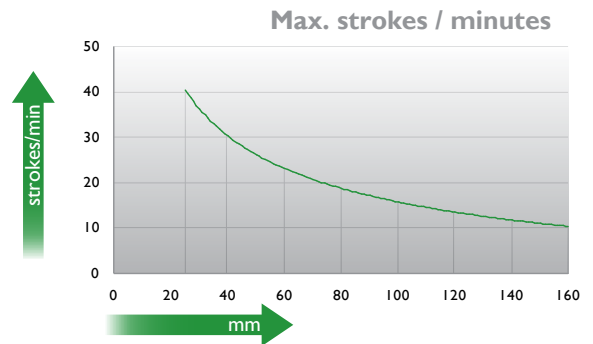

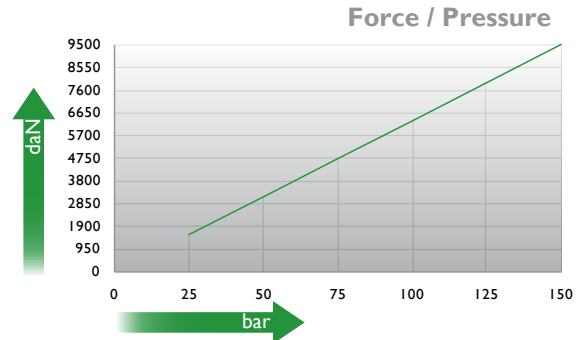

*The new cylinder will be supplied when the stock runs out.

NEW MODEL*

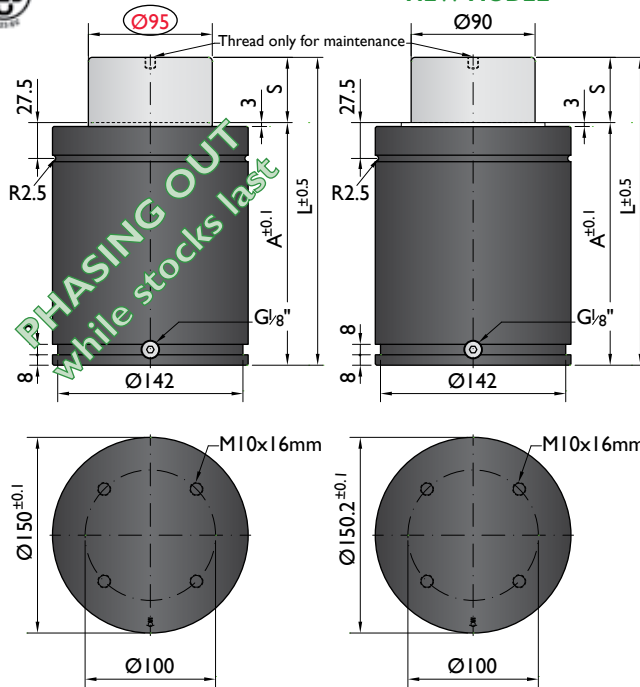

Ordering example: 4 x G-10000-125

Order No.	S ⁽¹⁾ mm	L mm	A mm	F ₀ ⁽²⁾ daN (20°C, 150 bar)	F daN		kg
G-10000-25	25	186	161	9500	12400	No	16.63
G-10000-38	38	212	174		13100	No	17.48
G-10000-50	50	236	186		13550	No	18.28
G-10000-63	63	262	199		14000	No	19.15
G-10000-80	80	296	216		14230	No	20.28
G-10000-100	100	336	236		15200	Yes	22.55
G-10000-125	125	386	261		15400	Yes	24.22
G-10000-160	160	456	296		15500	Yes	26.55

other strokes ⁽¹⁾ under request

alternative forces ⁽²⁾ upon request

ESK available ⁽³⁾ for other strokes



Pressure medium	N ₂	Working temperature	0-80°C	Min. security stroke	10%
Max. Charging pressure	150 bar	Temperature related force increase	+0.34%/°C	Repair Kit	KIT G-10000
Min. Charging pressure	25 bar	Max. working speed	1.6 m/s	Linkable	G1/8"

Mounting possibilities

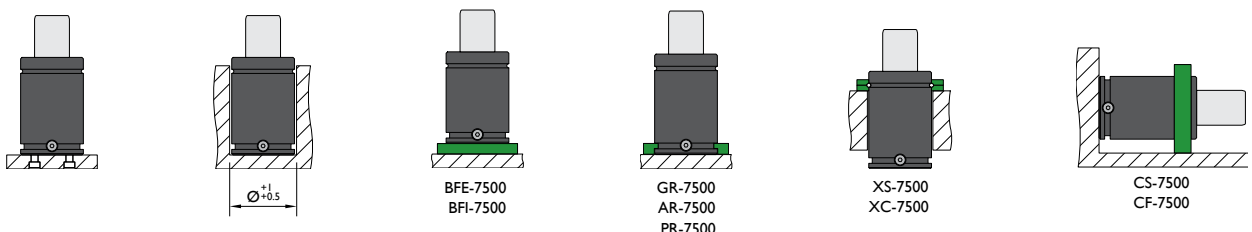

Flanges

BFE-7500

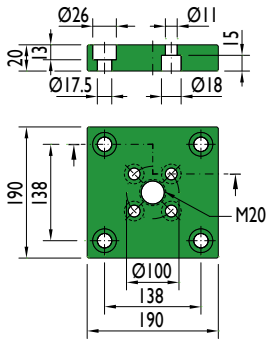

BFI-7500

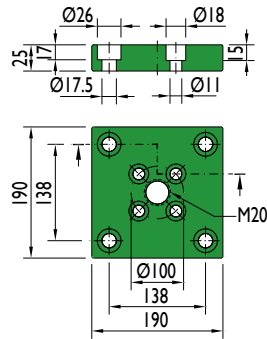

GR-7500

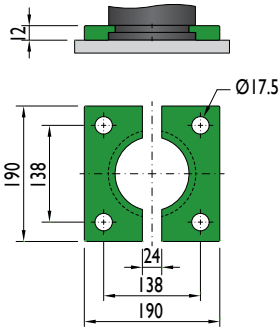

AR-7500

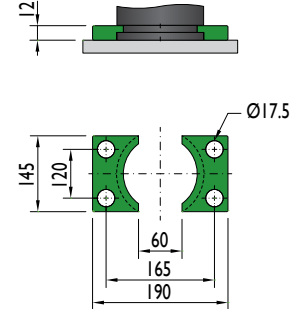

XS-7500

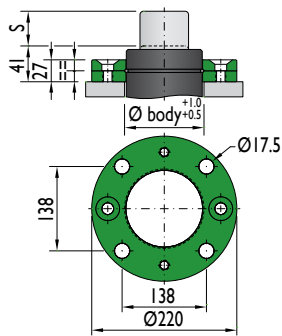

XC-7500

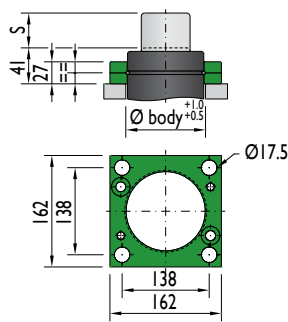

PR-7500

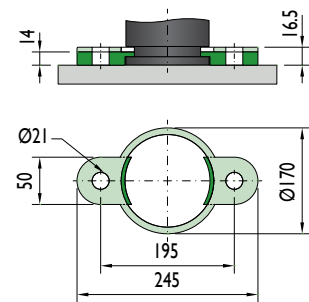

CS-7500

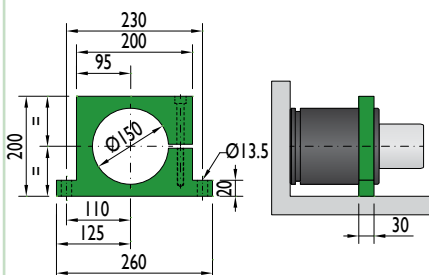

Flange must not support spring's force

CF-7500

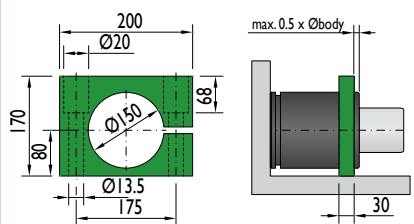

Flange must not support spring's force