

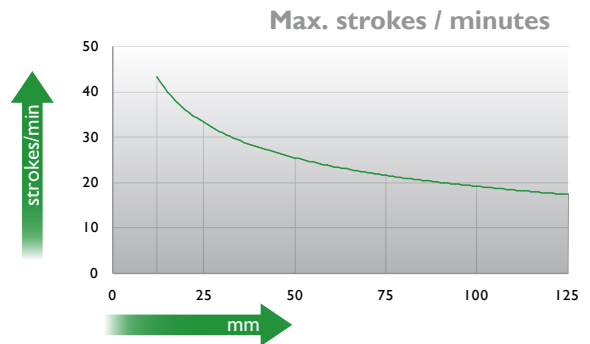

*The new cylinder will be supplied when the stock runs out.

NEW MODEL*

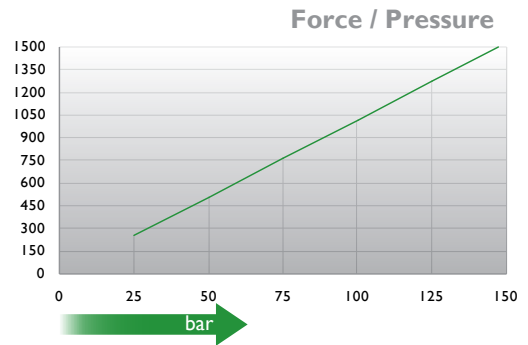
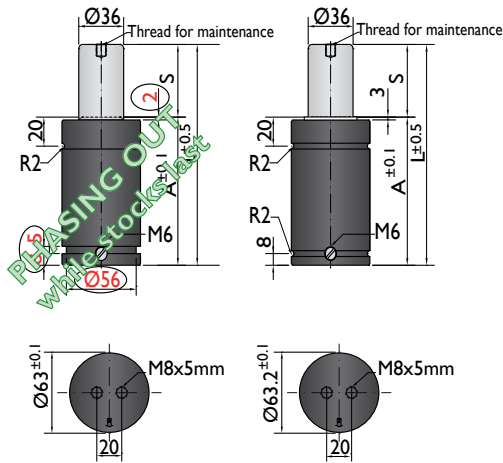

Ordering example: 4 x KC-1500-125

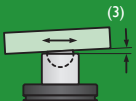
Order No.	S ⁽¹⁾ mm	L mm	A mm	F ₀ ⁽²⁾ daN (20°C, 150 bar)	F daN		kg
KC-1500-12	12	76	64	1500	1800	No	1.02
KC-1500-25	25	102	77		2400	No	1.24
KC-1500-38	38	128	90		2500	No	1.45
KC-1500-50	50	152	102		2600	Yes	1.65
KC-1500-63	63	178	115		2700	Yes	1.86
KC-1500-80	80	212	132		2700	Yes	2.14
KC-1500-100	100	252	152		2700	Yes	2.45
KC-1500-125	125	302	177		2700	Yes	2.88

other strokes ⁽¹⁾ under request

alternative forces ⁽²⁾ upon request

ESK available for other strokes ⁽³⁾



Pressure medium	N ₂	Working temperature	0-80°C	Min. security stroke	10%
Max. Charging pressure	150 bar	Temperature related force increase	+0.34%/°C	Repair Kit	KIT KC-1500
Min. Charging pressure	25 bar	Max. working speed	1.6 m/s	Linkable	M6

Mounting possibilities

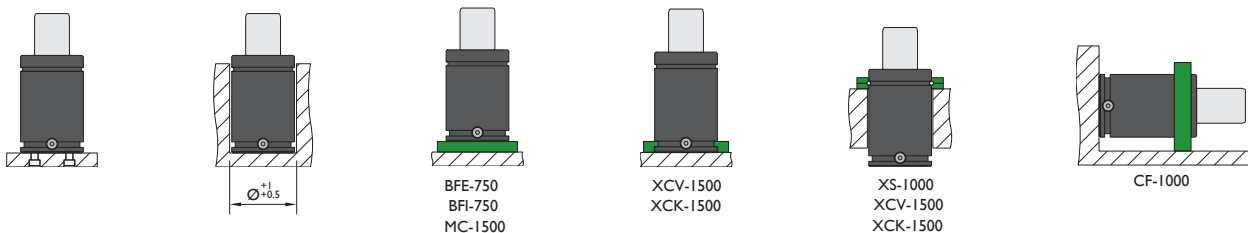

Flanges

BFE-750

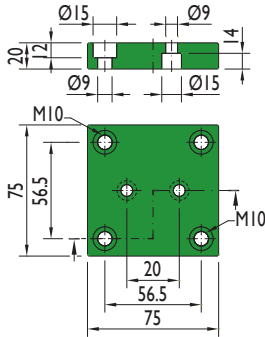

BFI-750

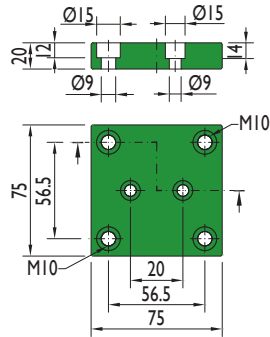

MC-1500

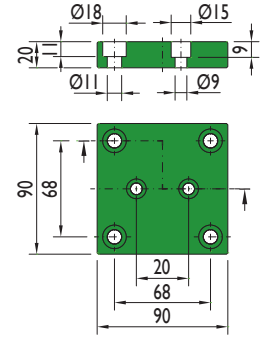

XCV-1500

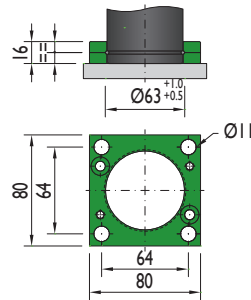

XCK-1500

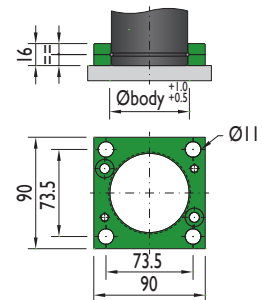

XS-1000

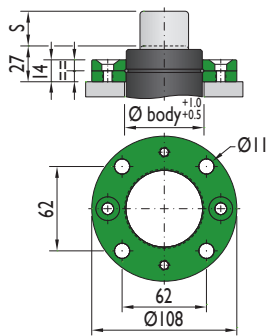

XCV-1500

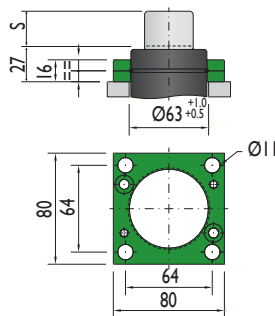

XCK-1500

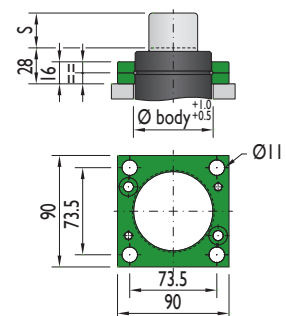

CF-1000

