

Force / Pressure

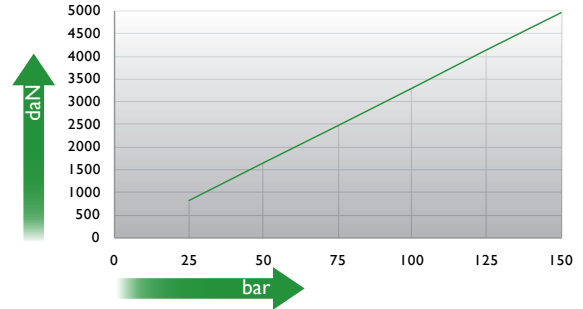

Max. strokes / minutes

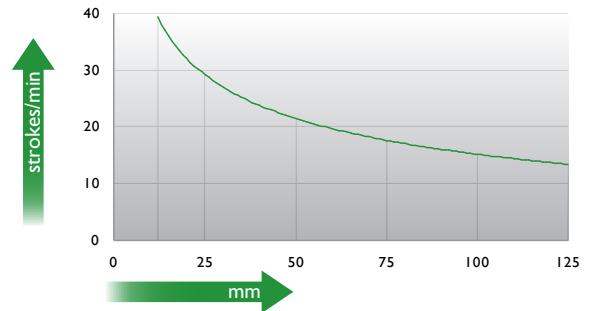

Ordering example: 4 x KC-5000-125

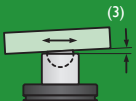
Order No.	S ⁽¹⁾ mm	L mm	A mm	F ₀ ⁽²⁾ daN (20°C, 150 bar)	F daN	 ⁽³⁾	kg
KC-5000-12	12	84	72	5000	7200	No	3.77
KC-5000-25	25	110	85		7800	No	4.20
KC-5000-38	38	136	98		7900	No	4.56
KC-5000-50	50	160	110		8800	Yes	4.90
KC-5000-63	63	186	123		8700	Yes	5.40
KC-5000-80	80	220	140		8700	Yes	5.96
KC-5000-100	100	260	160		8700	Yes	6.74
KC-5000-125	125	310	185		8700	Yes	7.58

other strokes ⁽¹⁾ under request

alternative forces ⁽²⁾ upon request

ESK available for other strokes ⁽³⁾



Pressure medium	N ₂	Working temperature	0-80°C	Min. security stroke	10%
Max. Charging pressure	150 bar	Temperature related force increase	+0.34%/°C	Repair Kit	KIT KC-5000
Min. Charging pressure	25 bar	Max. working speed	1.6 m/s	Linkable	M6

Mounting possibilities

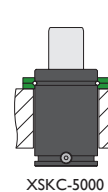
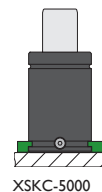
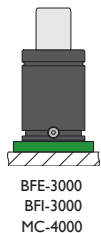
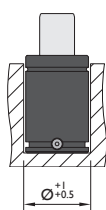
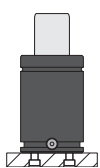

Flanges

BFE-3000

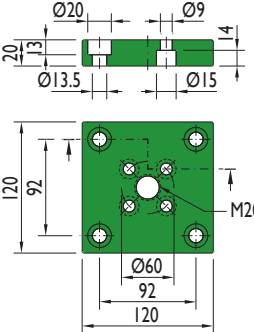

BFI-3000

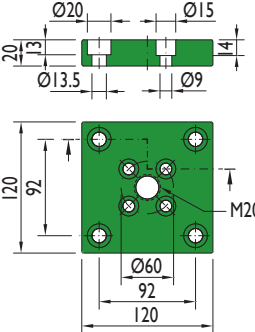

MC-4000

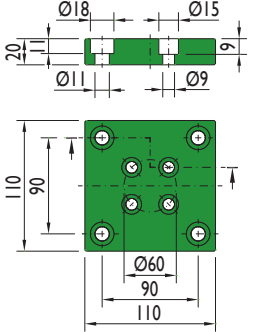

XSKC-5000

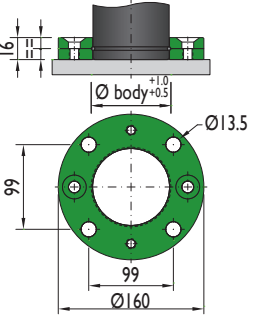

XSKC-5000

