

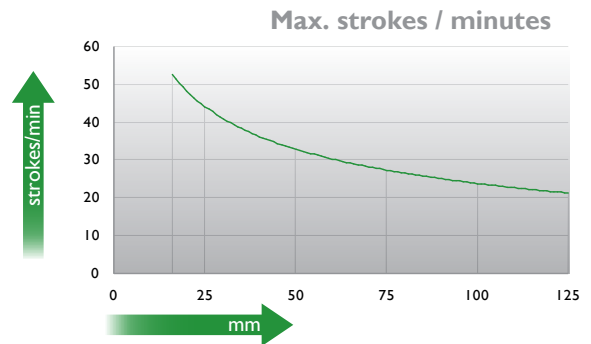

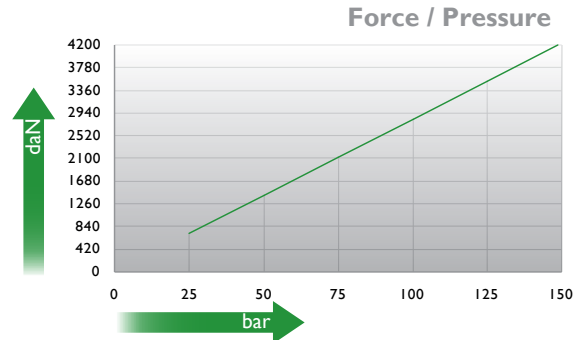

PSA
E24.54.815.G

SMS DNH
3203N

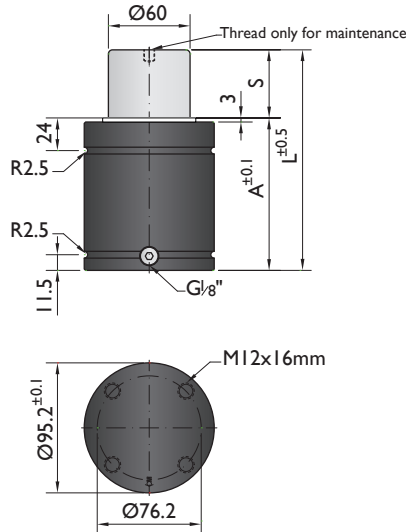

Ordering example: 4 x NT-4200-125

Order No.	S ⁽¹⁾ mm	L mm	A mm	F ₀ ⁽²⁾ daN	F daN	 ⁽³⁾	kg
				(20°C, 150 bar)			
NT-4200-16	16	94	78	4200	6100	No	2.60
NT-4200-19	19	100	81		6300	No	2.75
NT-4200-25	25	112	87		6300	No	2.95
NT-4200-32	32	126	94		6400	No	3.17
NT-4200-38	38	138	100		6500	No	3.32
NT-4200-50	50	162	112		7700	No	3.76
NT-4200-63	63	188	125		7600	Yes	4.12
NT-4200-75	75	212	137		7600	Yes	4.50
NT-4200-80	80	222	142		7600	Yes	4.67
NT-4200-100	100	262	162		7500	Yes	5.30
NT-4200-125	125	312	187		7500	Yes	6.10

⁽¹⁾ other strokes under request

⁽²⁾ alternative forces upon request

⁽³⁾ ESK available for other strokes



Pressure medium	N ₂	Working temperature	0-80°C	Min. security stroke	10%
Max. Charging pressure	150 bar	Temperature related force increase	+0.34%/°C	Repair Kit	KIT NT-4200
Min. Charging pressure	25 bar	Max. working speed	1.6 m/s	Linkable	G1/8"

Mounting possibilities

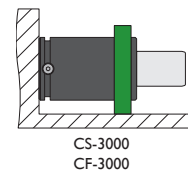
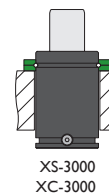
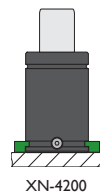
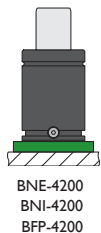
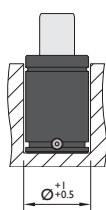
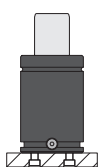

Flange must not support spring's force

Flanges

BNE-4200

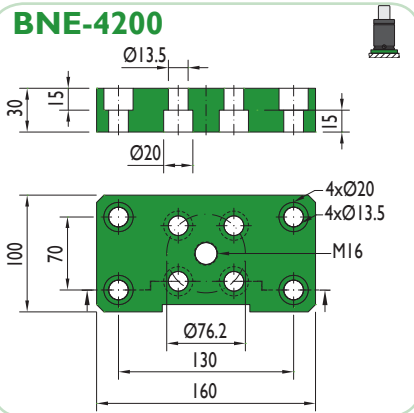

BNI-4200

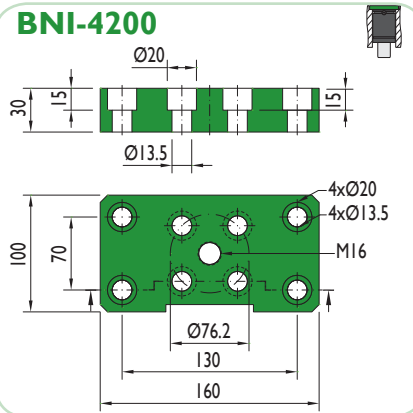

BFP-4200

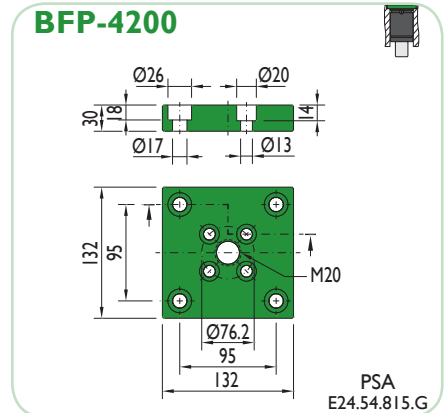

XN-4200

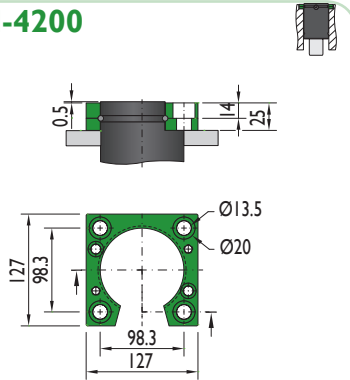

XS-3000

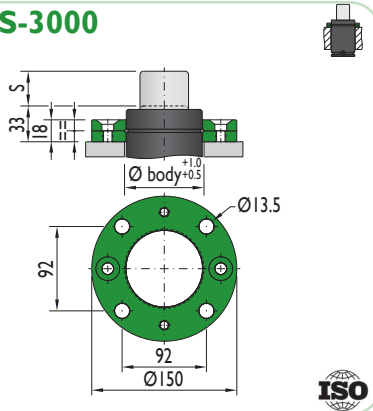

XC-3000

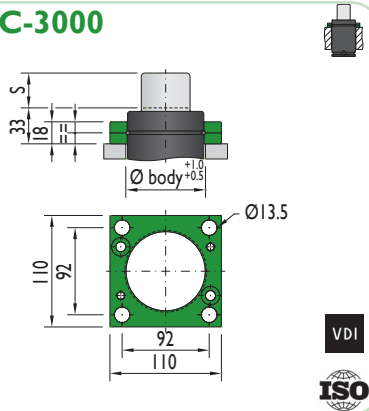

CS-3000

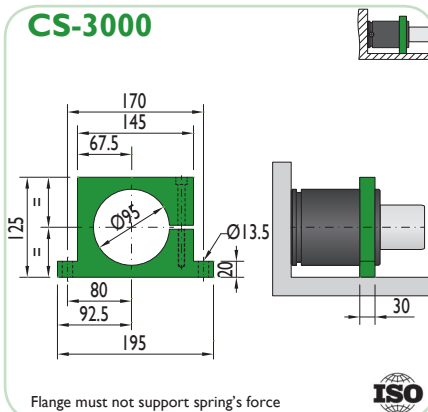

CF-3000

