

Ordering example: 4 x TSC-1000-50

Order No.	S <sup>(1)</sup> mm	L mm	A mm	F <sub>0</sub> <sup>(2)</sup> daN	F daN	kg
TSC-1000-6	6	81	75	920 (20°C, 150 bar)	1300	0.50
TSC-1000-10	10	98	88		1500	0.58
TSC-1000-16	16	120	104		1400	0.66
TSC-1000-25	25	155	130		1400	0.77
TSC-1000-32	32	187	155		1400	0.87
TSC-1000-40	40	215	175		1400	0.95
TSC-1000-50	50	250	200		1400	1.12

other strokes <sup>(1)</sup> under request

alternative forces <sup>(2)</sup> upon request



Pressure medium	N <sub>2</sub>	Working temperature	0-80°C	Min. security stroke	10%
Max. Charging pressure	150 bar	Temperature related force increase	+0.34%/°C	Repair Kit	KIT TSC-1000
Min. Charging pressure	25 bar	Max. working speed	0.5 m/s	Linkable	G1/8"

### Mounting possibilities

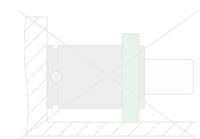
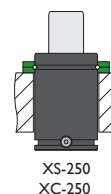
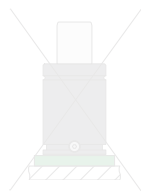
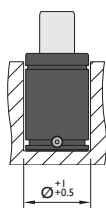
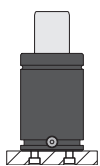

## Flanges



**XS-250**

**XC-250**

